

VICTA[®]

Not for
Reproduction

**18V LITHIUM-ION
TWIN BATTERY
CORDLESS POWERHEAD
ASSEMBLY & OWNER'S MANUAL**



WARNING! Read this manual before operating your product.



IMPORTANT NOTES

Details

Thank you for purchasing your Victa product. Victa prides itself in the quality and performance of all its products.

This instruction manual will aid in the assembly, safe operation and maintenance of your product. Please read the following warnings to ensure safety and the long life of your product.

WARNING

Do not attempt to operate this product until you have read thoroughly and understood completely all instructions, safety rules, etc, contained in this manual. Failure to comply may result in accidents involving electric shock, fire, and/or serious personal injury.

INTENDED USE

This product is intended for domestic purposes. This product is not intended for brushcutting or commercial use. Do not use the product for any task, except for that which it is intended.

General safety



Warning!



Read the directions for use before operating the machine.



Wear safety goggles and ear protection that meet safety standards.



Wear sturdy, non-slip footwear.



Wear safety gloves.



Do not use machine in wet conditions, protect the machine from rain and damp.



Be careful of objects being thrown out! Ensure bystanders are kept at least 50' (15m) away & stop the machine if approached.



Batteries contain Li-ion. Do not dispose of waste batteries in domestic waste. Contact local authority to find out how to dispose of batteries appropriately.



The front handle should be positioned at least 10cm from the shaft coupling



Beware of electric shock hazard when charging.



Read the directions before carrying out any adjustment & maintenance work.



Wait for all components of the machine to completely stop & remove the battery.



Do not use rigid cutting disk.



Should NOT be disposed of with house hold items.



Keep away from heat and/or open flame.



Do not throw into water.



Ambient temperature 40°C Max.









Keep bystanders away.



Keep hands away from cutting area while operating.



Table of Contents

	Features & Definitions		
		Features & supplied items	3
	Safety & Handling		
		General/Electrical/Personal safety	4
		Power Tool use and care	5
		Battery use and care	6
		Product Disposal	7
	Assembly Procedures		
		Unpacking	7
		Handle Assembly	8
		Carry Strap Harness Assembly	8
		Shaft assembly	9
	Operating Instructions		
		Operating the powerhead	10
		Installing & removing the Battery	10
		Start & stopping	10
		Speed adjustment	11
			11
	Maintenance & Care		
		Cleaning	12
		Storing	12
		Maintenance chart	13
		Service	13
	Troubleshooting		
		Troubleshooting	14
		Indication Panel	14
	Technical Specification		
		Product specification	15
		Approved attachments	15
		Technical Specification	16

NOTE: WARRANTY DETAILS ARE NOT WRITTEN WITHIN THIS OPERATOR'S MANUAL. REFER TO OTHER DOCUMENTS SUPPLIED WITH THIS MACHINE FOR WARRANTY DETAILS.

THE WARRANTY DOCUMENTS MAY INCLUDE TECHNICAL SPECIFICATIONS THAT ARE SPECIFIC TO EACH MODEL THAT ARE NOT WRITTEN WITHIN THIS OPERATOR'S MANUAL.



FEATURES & DEFINITIONS

Features & Supplied Items - 18V Twin Battery Line Trimmer

NOTE: Refer to figure A.

- 1 Operating Handle
 - 2 Presence Switch
 - 3 Throttle Trigger
 - 4 Battery Housing
 - 5 Front Handle
 - 6 Harness mounting bracket
 - 7 Harness
 - 8 Speed adjustment panel
 - 9 Shaft
 - 10 Motor Housing
 - 11 Shaft Coupling
 - 12 Battery (may not be included)
 - 13 Battery Charger (may not be included)
- Grass Trimmer Instruction/Safety Manual (not shown)
 - Battery & Charger Instruction/Safety Manual (not shown)

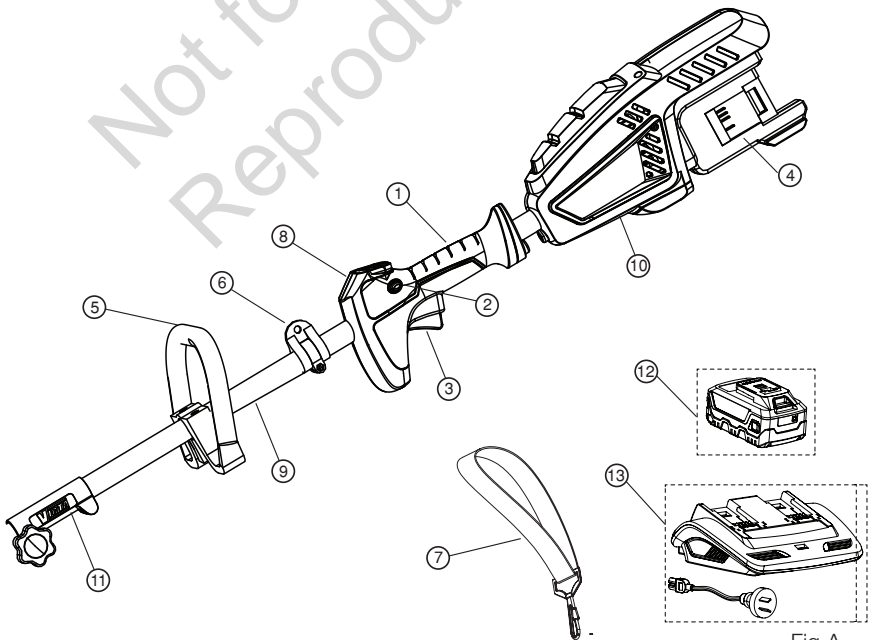

! WARNING

Fig A

Do not operate the product if any component is missing or damaged. Have any missing or damaged components repaired or replaced.



General Safety

WARNING

Read all safety warnings, instructions, illustrations and specifications provided with this power tool. Failure to follow instructions listed below may result in electric shock, fire and/or serious injury.

Save all warnings and instructions for future reference.

The term "power tool" in the warnings refers to your battery-operated (cordless) power tool.

Work Area Safety

- **Keep work area clean and well lit.** Cluttered or dark areas invite accidents.
- **Do not operate power tools in explosive atmospheres, such as in the presence of flammable liquids, gases or dust.** Power tools create sparks which may ignite the dust or fumes.
- **Keep children and bystanders away while operating the power tool.** Distractions can cause you to lose control.
- **Thoroughly inspect the area where the machine is to be used. Remove all stones, sticks, wire, bones, toys, and other objects that could be tripped over or thrown by the cutting mechanism.** Thrown objects can cause serious personal injury.

Electrical Safety

- **Avoid body contact with earthed or grounded surfaces such as pipes, radiators and refrigerators.** There is an increased risk of electric shock if your body is earthed or grounded.
- **Do not expose the power tool to rain or wet conditions.** Water entering the power tool will increase the risk of electric shocks.

Personal Safety

- **Stay alert, watch what you are doing and use common sense when operating the power tool. Do not use the power tool while you are tired or under the influence of drugs, alcohol or medication.** Reduced concentration while operating the power tool may result in serious personal injury.
- **Use personal protective equipment. Always wear eye protection.** Protective equipment such as a dust mask, non-skid safety shoes, hard hat or hearing protection used for appropriate conditions will reduce personal injuries.
- **Prevent unintentional starting. Ensure the switch is in the off-position before inserting the battery pack, picking up or carrying the tool.** Carrying power tools with your finger on the switch may cause accidental starts.
- **Remove any adjusting key or wrench before turning the power tool on.** A wrench or key left attached to a rotating part of the power tool may result in personal injury.
- **Do not overreach. Keep proper footing and balance at all times.** This enables better control of the power tool in unexpected situations.
- **Do not wear loose clothing or jewellery. Keep your hair and clothing away from moving parts.** Loose clothes, jewellery or long hair can be caught in moving parts.
- **Do not operate this machine in bare feet, or while wearing sandals or lightweight (e.g. canvas shoes) Wear long trousers & heavy shoes.**
- **Do not let familiarity gained from frequent use of similar power tools allow you to become complacent and ignore safety principles.** A careless action can cause severe injury.



SAFETY & HANDLING

- Do not use the machine indoors. Only store the machine indoors in a dry & secure location. Keep the machine out of reach of children.
- Do not use the machine in a rush. Always walk & never run with the machine.

Power Tool Use and Care

- The power tool should be operated only with a genuine Briggs & Stratton 18V Lithium-ion battery. When using battery powered power tool, basic safety precaution should always be followed to reduce the risk of leaking batteries and personal injury.
- Do not force the power tool and always use the correct power tool for your application. The correct power tool will do the job better and safer if it was designed to do so.
- Do not use the power tool if the switch does not turn it on and off safely. Any power tool that cannot be controlled with the switch is dangerous and must be repaired before use.
- Remove the battery pack from the power tool before changing accessories, storing power tools or when not in use.
- Store idle power tools out of the reach of children and do not allow persons unfamiliar with the power tool or these instructions to operate the power tool. Power tools are dangerous in the hands of untrained users.
- Maintain power tools and accessories. Check for misalignment or binding of moving parts, breakage of parts and any other condition that may affect the power tool's operation. If damaged, repair the power tool before use.
- Keep cutting tools sharp and clean. Properly maintained cutting tools with sharp cutting edges are less likely to bind and are easier to control.
- Use the power tool and accessories in accordance with these instructions, taking into account the working conditions and the work to be performed. Use of the power tool for operations different from what it is intended for may be hazardous.
- Keep handles and grasping surfaces dry, clean and free from oil and grease. Slippery handles and grasping surfaces do not allow for safe handling and control of the tool in unexpected situations.
- Become familiar with all controls and their proper operation before using the power tool. Know how to stop the power tool and how to disengage the power in an emergency.
- If the power tool starts to vibrate excessively, discontinue use until the machine has been inspected and assessed. Having a power tool assessed for vibration problems generally reduces the risk for injury or product failure.
- Do not point the power tool in the direction of people or pets.
- Power tool must be completely assembled before attempting to start operation.



Battery Use and Care

- **Recharge only with the charger specified by the manufacturer.** A charger that is suitable for one type of battery pack may create a risk of fire when used with another battery pack.
- **Use power tools only with specifically designated battery packs.** Use of any other battery packs may create a risk of injury and fire.
- **When battery pack is not in use, keep it away from other metal objects, like paper clips, coins, keys, nails, screws, or other small metal objects that can make a connection from one terminal to another.** Shorting the battery terminals together may cause burns or a fire.
- **Under abusive conditions, liquid may be ejected from the battery. If this happens, avoid contact. If contact accidentally occurs, flush with water and if it comes in contact with eyes, seek medical help.** Liquid ejected from the battery may cause irritation or burns.
- **Do not use a battery pack or tool that is damaged or modified.** Damaged or modified batteries may exhibit unpredictable behaviour resulting in fire, explosion or risk of injury.
- **Do not expose a battery pack or tool to fire or excessive temperature.** Exposure to fire or temperature above 130°C may cause explosion.
- **Follow all charging instructions and do not charge the battery pack or tool outside the temperature range specified in the instructions.** Charging improperly or at temperatures outside the specified range may damage the battery and increase the risk of fire.

Not for
Reproduction



SAFETY & HANDLING

Product Disposal

CORRECT DISPOSAL OF THE PRODUCT



Waste electrical products should not be disposed of with household waste. Please recycle where facilities exist. Check with your local authority or retailer for recycling advice.

The battery contains material which is hazardous to you and the environment. It must be removed and disposed of separately at a facility that accepts lithium-ion batteries.



Refer to Briggs & Stratton 18V Battery & Charger manual for further information relating to battery and charger disposal.

CORRECT DISPOSAL OF THE PACKAGING



The packaging consists of cardboard and correspondingly marked plastics that can be recycled. Make these materials available for recycling.

Emergency Contact

In the rare case a battery is damaged & any of the contents leaks or comes into contact with a persons skin, eyes, or is ingested, follow the first aid instructions inside the battery & charger manual. Seek further medical attention immediately.



ASSEMBLY PROCEDURES

Unpacking

This product requires assembly.

- Carefully remove the product and any accessories from the box. Make sure that all items listed in the packing list are included. Refer to pages 3.
- Do not discard the packing material until you have carefully inspected and ensured product is in correct operating condition.



WARNING

Do not attempt to modify this product or create accessories not recommended for use with this product. Any such alteration or modification is misuse and could result in a hazardous condition leading to possible serious personal injury.

Do not operate the machine unless assembly is complete including guards, handles & harness.

Do not install the battery in the product before finishing the complete assembly.



Handle Assembly

Fitting the handle

1. Remove all the screws from the handle. (Fig.1)
2. Position brackets on Shaft and tighten the screws.(Fig.2)
3. Position the front handle at least 10cm from the shaft coupling. (Fig.3)

WARNING

The front handle should not be positioned less than 10cm from the shaft coupling to maintain the recommended safety distance from the cutting element.

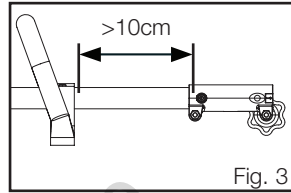
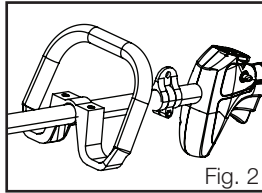
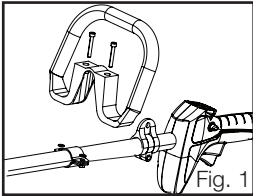

CAUTION! Not too loose or too tight. Over tightening may damage the unit.

Carry Strap Harness Assembly

Fitting the Carrying Strap Harness (Fig. 4)

- The strap is intended to help you work safely & ergonomically with the machine.
- Hook the strap into the fastening eyelet.
- Slip the strap over the shoulder.
- Set the length of the shoulder strap in such a way that the trimmer head runs parallel to the ground. In order to establish the optimum length of the strap, you should then make a few swinging movements to check operating comfort before starting the engine.

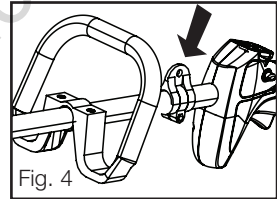



ASSEMBLY PROCEDURES

Shaft Assembly

1. Loosen the knob (3) on the coupling (1). (Fig. 5).
2. Push the pin on the attachment shaft (2) inwards and carefully slide the attachment shaft into the coupling.

Note: When inserting attachment shaft into the coupling, shifting of the shaft alignment by slight rotation of the cutting head may assist with smoother engagement.

3. Ensure that the pin on the attachment shaft (2) locks into the corresponding hole on the coupling.
4. Then firmly re-tighten the knob (3).



Locking the pin into the shaft hole (4) ensures full engagement of drive shafts. Failure to fully engage drive shafts will damage the connection & void product warranty. (Fig.6).



Do not Start or Run powerhead unit without shafts & guards fully assembled.

Take care when fitting & tightening. Beware of pinch points.

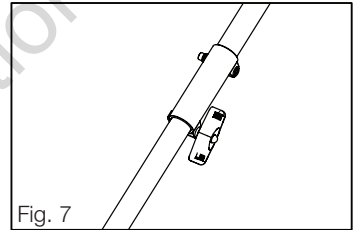
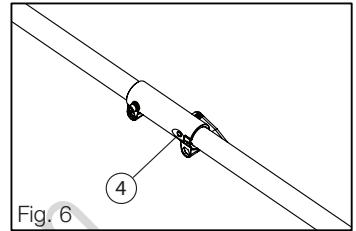
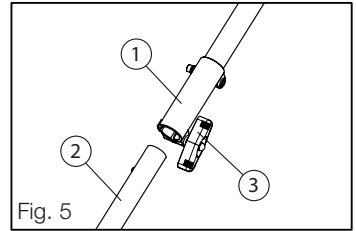

Not for
Reproduction



Operating The Machine

Hold the trimmer with your right hand on the rear handle and your left hand on the front handle. Keep a firm grip with both hands while in operation. The trimmer should be held at a comfortable position with the rear handle about hip height. Always operate the trimmer at full throttle. If debris becomes wrapped around the cutting head, release the trigger, remove battery and then remove the debris.

WARNING

- Position the unit on the operator's right side & never operate unit with the bottom of the motor above waist level.
- Reverse hand orientation if left hand use is desired.

Installing & removing the Battery

NOTE: Refer to figure 8

- Align the guide ribs on battery with grooves in the machine's battery port.
- Push the battery in the line trimmer battery housing.
- Make sure the latch on bottom of the battery snaps in place and that the battery is fully seated (will "click" into place) and secure in the machine before beginning operation.
- If the machine is not going to be used immediately, remove the battery.
- To remove the battery, press the release trigger on the battery and pull it out from machine. Refer battery manual to locate the release trigger.

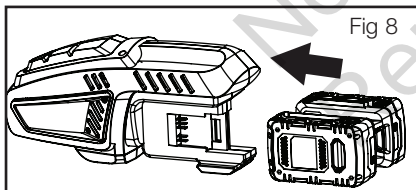

WARNING

Remove batteries from machine when not in use.

Starting & Stopping

PRESENCE SWITCH (Fig. 9)

The presence switch reduces the possibility of accidental starting. The presence switch is located on the handle above the trigger. The presence switch must be pushed in before you pull the trigger. The lock resets each time the trigger is released.



OPERATING INSTRUCTIONS

STARTING the machine:

- Push and hold the ON/OFF Button on the Indication Panel (Fig. 10) until the Green LED appears.
- Push the presence switch and hold it in place (Fig. 11).
- While the presence switch is held, squeeze the throttle trigger to start the machine (Fig. 11)
- Release the presence switch while keeping the throttle trigger squeezed.
- Allow few seconds for the cutting head to reach max RPM.

STOPPING the machine:

- Release the throttle trigger.
- Allow cutting head to come to a complete stop.
- Remove batteries from the machine.

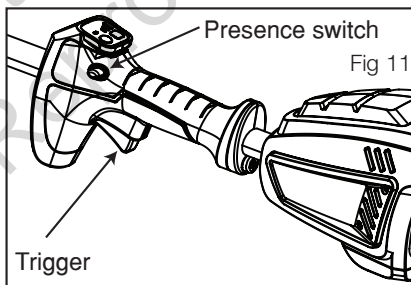
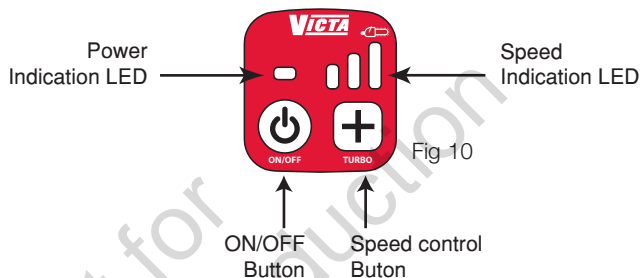

Speed Adjustment

Speed settings can be adjusted by pressing the speed control button (Fig. 10) when the machine is turned on.

Note: When the highest speed setting is activated, pressing the speed control button again will revert the speed setting back to the lowest speed.

Note: When using this machine with the Victa pole saw attachment, the highest speed is recommended.



Cleaning

WARNING

To prevent serious personal injury remove the battery from the machine before servicing, cleaning, or removing debris.

- Clean the unit using a damp cloth with a mild detergent.
- Do not immerse the machine or any part of it in water.
- Moisture can cause a shock hazard. Wipe off any moisture with a soft dry cloth & ensure the machine is dry before replacing the battery.
- Use a small brush or vacuum cleaner to clean the air vents on the product.
- Keep the air vents free of obstructions.

Do not use solvents, strong detergents, certain aromatic oils such as pine and lemon when cleaning plastic parts. Chemicals can damage, weaken or destroy plastic component which may result in serious personal injury.

Storing

The following steps should be taken in order to prepare the machine for storage.

- Clean the machine as described in the previous section.
- Store the machine in a dry, clean location. Do not store it next to corrosive materials, such as fertilizer or fuel.
- Store the machine indoors, in a cool, dry place, out of the reach of children.
- Ensure batteries are removed before storage.

Not for
Reproduction



MAINTENANCE & CARE

Maintenance Chart

Refer to the following table for routine maintenance.

Features	Requirements	Before use	After use	Recharging	Monthly	Yearly	If damaged	As required
Throttle trigger	Check operation	●						
Presence trigger	Check	●						
Battery locking latch	Check	●		●				
Shaft coupling	Check and tighten	●	●					●
Ventilation Grills	Clean	●	●					
All accessible fasteners	Retighten	●						●

Service

Servicing requires extreme care and knowledge and should be performed only by a qualified service technician. For service we suggest you return the product to your nearest authorized service centre for repair. When servicing, use only genuine replacement parts.

- Keep the machine dry, clean, and free of oil and grease.
- In order to reduce the risk of fire, keep the motor free of grass, leaves, and debris build-up.
- Keep all nuts, bolts, and screws tight in order to be sure that the equipment is in safe working condition.
- Never tamper with safety devices. Check them regularly for proper operation.
- Improper repairs may result in product malfunction. This endangers you and your environment.

WARNING

Never service damaged battery packs. Service of battery packs should only be performed by the manufacturer or authorized service providers.

NOTE: Refer to warranty card supplied with this product for service contact details.



Troubleshooting

Problem	Cause	Solution
Motor fails to run when trigger is depressed	Flat battery	Recharge battery
	Battery disengaged	Refit battery
	Faulty battery	Replace battery
Excessive vibration	Cut off blade worn	Replace cut off blade
	Bumphead not fitted correctly	Refit bumphead
	Broken drive shaft	Replace drive shaft
	Coupling not fitted correctly	Refit coupling

Indication Panel

(Refer to figure 5.1 for further details on indication panel)

LED	Indication	User action
Solid Green LED	Trimmer is ON	Active and ready for use.
Blue LED "Flashing"	Temperature protection has been activated	- Allow batteries to cool down before continuing operation. - Change a different set of batteries to continue operation.

* LOAD PROTECTION

The grass trimmer has built in load sensing. When the load is high, the trimmer will shut the motor down immediately and emit beeping sound informing the user that the load protection has been activated to protect the product and user.



TECHNICAL SPECIFICATIONS

Product Specifications

PRODUCT SPECIFICATION	
Description	Twin 18V Powerhead
Motor Type	Brushless
Motor Specification	36V DC (2 x 18V)
Motor Speed (rpm)	10,000
Product Weight (No battery)	3.2 kg



CAUTION: For use with VICTA handheld attachments specified in this manual only

Approved Attachments

Description	Model number
Line trimmer (straight shaft)	1697409
Line trimmer (bent shaft)	1697410
Pole saw	1696894
Hedge trimmer	1696896



CAUTION: Only use attachments and accessories that are specified in this manual. Using any other attachments may present risk and result in serious personal injury.



Technical Specification

Model	Max Rotation/ chain speed	Noise L _{wa} dBA	Vibration m/s ²	
			Rear Handle	Front Handle
1697409	5700 rpm	105.0	2.91	5.01
1697410	7200 rpm	104.0	2.91	5.01
1696894	14 m/s	105.0	2.90	4.52
1696896	1860 rpm	95.0	4.63	3.39

A warning:

- That the declared vibration total value has been measured in accordance with a standard test method and may be used for comparing one tool with another;
- That the declared vibration total value may also be used in a preliminary assessment of exposure.
- That the vibration emission during actual use of the power tool can differ from the declared total value depending on the ways in which the tool is used; and
- Of the need to identify safety measures to protect the operator that are based on an estimation of exposure in the actual conditions of use (taking account of all parts of the operating cycle such as the times when the tool is switched off and when it is running idle in addition to the trigger time).

Not for
Reproduction

Not for
Reproduction

©2021 Briggs & Stratton LLC
Victa is a trademark of Briggs & Stratton Australia Pty. Ltd.

All rights reserved. No part of this booklet may be reproduced by any means without prior written permission. All information herein is subject to change without notice.