

VICTA[®]

Not for
Reproduction

18V LITHIUM-ION CORDLESS CHAINSAW ASSEMBLY AND OWNER'S MANUAL



WARNING! Read this manual before operating your product.



IMPORTANT NOTES

Details

Thank you for purchasing your Victa product. Victa prides itself in the quality and performance of all its products.

This instruction manual will aid in the assembly, safe operation and maintenance of your product. Please read the following warnings to ensure safety and the long life of your product.

WARNING

Do not attempt to operate this product until you have read thoroughly and understood completely all instructions, safety rules, etc, contained in this manual. Failure to comply may result in accidents involving electric shock, fire, and/or serious personal injury.

INTENDED USE

This chainsaw is designed for cutting branches, trunks, logs and beams of a diameter determined by the cutting length of the guide bar. It is only designed to cut wood. It is only to be used in an outdoor, domestic application by adults.

Do not use the chainsaw for any purpose not listed in this manual. This chainsaw is not to be used for professional tree services. It is not to be used by persons not wearing adequate personal protective equipment and clothing.

Do not use the product for any task, except for that which it is intended.

General safety



Warning!



Read the directions for use before operating the machine.



Read the directions before carrying out any maintenance work.



Wear safety goggles and ear protection that meet safety standards.



Wait for all components of the machine to completely stop & remove the battery.



Wear sturdy, non-slip footwear.



Should NOT be disposed of with house hold items.



Wear safety gloves.



Ambient temperature 40°C Max.



Wear respiratory protection.



Do not throw into water.



Wear tight-fitted protective clothes.



Keep away from heat and/or open flame.



General safety



Beware of electric shock hazard when charging.



Do not use machine in wet conditions, protect the machine from rain and damp.



Be careful of objects being thrown out! Ensure bystanders are kept at least 50' (15m) away & stop the machine if approached.



Do not smoke in the work area, around the product and in the vicinity of flammable materials!

Objects thrown by the product could hit the user or other bystanders. Always ensure that other people and pets remain at a safe distance from the product when it is in operation. In general, children must not come near the area where the product is.



Correct direction of cutting-teeth.



Kickback! Tip contact may cause the guide bar to move suddenly upward and backwards what may cause serious injury to user.



Class II equipment (Charger).



Contact of the guide bar tip with any object should be avoided.



Guaranteed sound power level.



Always use the product with two hands. Do not use one hand when operating the product.







Chain brake (the symbol (○) shows the position in which the brake is released)



CONTENTS & SYMBOLS

Table of Contents

	Features & Definitions		
		Features & Supplied Items	5
	Safety Features		
		Safety Features	6
	Safety & Handling		
		Personal Protective Equipment	7
		General Safety	8
		Battery Safety Warning	10
		Charger Safety Warning	10
		Kickback Prevention	11
	Operating Instructions		
		Installing the Battery	12
		Removing the Battery	12
		Holding the Chainsaw	12
		Starting & Stopping	13
		Chain Brake Operation	13
		Cutting Techniques	14
	Maintenance & Care		
		Chain & Bar Lubricant	15
		Chain Maintenance	15
		Chain Sharpening	16
		Bar & Chain Replacement	17
		Service	18
		Cleaning	18
		Transporting	18
		Storing	19
		Maintenance Chart	19
		Product Disposal	19
	Troubleshooting		
		Troubleshooting	20
		Warning Function	20
	Technical Specifications		
		Product Specifications	21

NOTE: WARRANTY DETAILS ARE NOT WRITTEN WITHIN THIS OPERATOR'S MANUAL. REFER TO OTHER DOCUMENTS SUPPLIED WITH THIS MACHINE FOR WARRANTY DETAILS.

THE WARRANTY DOCUMENTS MAY INCLUDE TECHNICAL SPECIFICATIONS THAT ARE SPECIFIC TO EACH MODEL THAT ARE NOT WRITTEN WITHIN THIS OPERATOR'S MANUAL.

FEATURES & DEFINITIONS



Features & Supplied Items

1. Trigger
2. Trigger Lock
3. Front Handle
4. Felling Dog
5. Bar
6. Oil Cap
7. Chain Brake
8. Chain
9. Battery Housing
10. Chain Adjuster Knob
11. Sprocket Cover
12. Oil Indicator
13. Rear Handle
14. LED Light - Chain Brake Release Indicator
15. Bar Cover
16. 18V Li-Ion Battery
17. 18V Li-Ion Battery Charger
18. Charger Cord

- Battery & Charger Instruction/Safety Manual (not shown)

- Mower Instruction/Safety Manual (not shown)

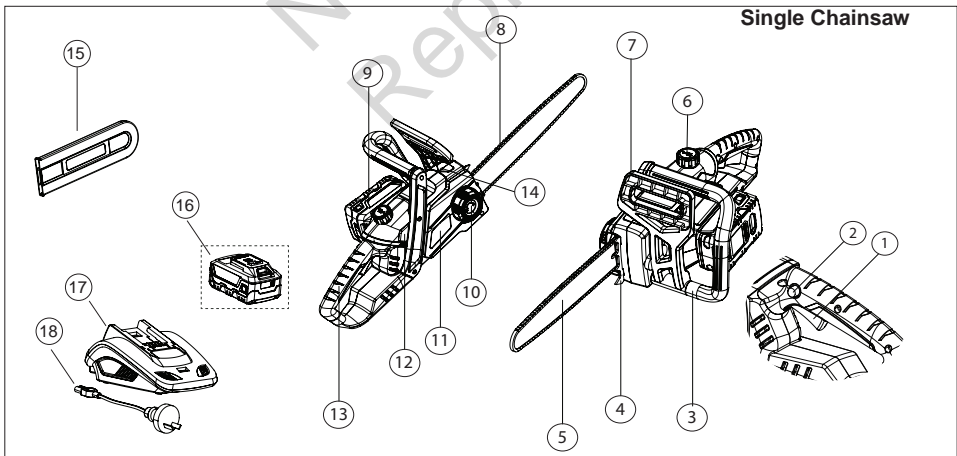
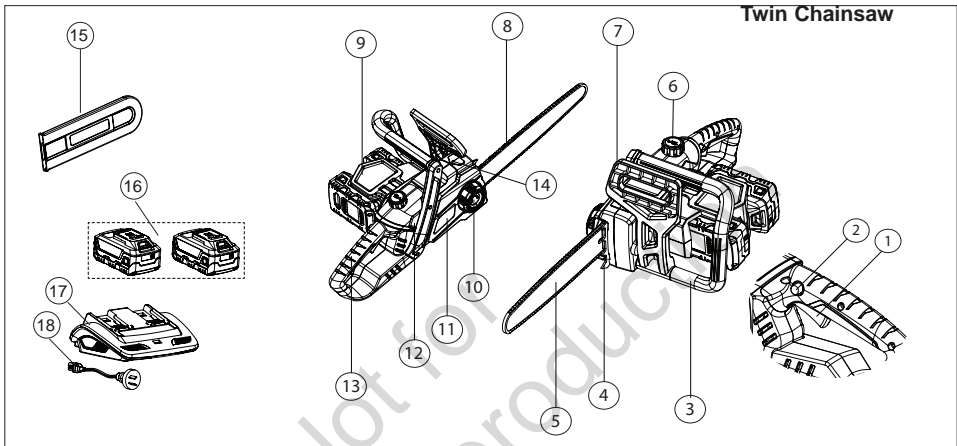

WARNING

Do not operate the product if any component is missing or damaged. Have any missing or damaged components repaired or replaced.



SAFETY & HANDLING

Safety Features

All safety features shall be checked prior to every use for damage and function. If they do not work as designed then do not use the chainsaw until they have been repaired or replaced.

Chain catcher (A)

This is a device to intercept a broken or derailed chain and deflect it under the sprocket cover. The chain catcher should be replaced once damaged and usually after a single use of the safety mechanism

Chain brake (B)

Designed to stop the chain in the event of kick-back and must be used when starting the product & during transportation.

Trigger lock (C)

Fitted to the side of the rear handle, this prevents the accidental engagement of the trigger. The trigger can only be activated after the trigger lock has been released.

Handle guard (D)

Design to protect the operator's hand whilst cutting and in the event of that a chain breaks or derails.

Led Light (E)

Green colour led used to show if chain brake is disengaged and chainsaw is ready to use.

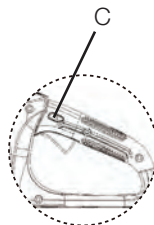
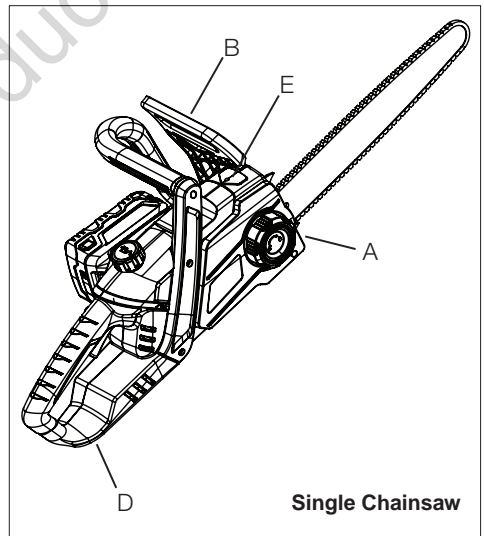
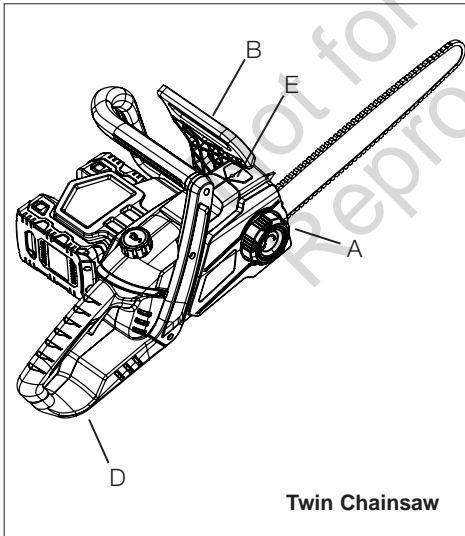



Personal Protective Equipment



All personal protective equipment (PPE) must conform to the relevant standards in your region in accordance with (EU) 2016/425.



The operator must check that all personal protective equipment (PPE) is fitted correctly, in safe working order & conforms with the relevant standards in your region.



All mandatory personal protective equipment must be worn at all times while operating the equipment. It is recommended using all the personal protective equipment shown in figure.

Safety Helmet (F)

- Must be replaced if cracked, damaged or past expiry date. Avoid damage caused by attaching stickers, storing in direct sunlight and contact with solvents. A Legionnaire-style flap can be attached to protect the back of the neck.
- Safety helmet must always be worn during operation.

Hearing Protection (G)

- Either ear plugs or ear muffs. Be aware the ear plugs and some cheap ear muffs may not provide sufficient protection when using larger saws. Check with your dealer for correct level of protection required for your saw.
- Hearing protection must always be worn during operation of the chainsaw.

Eye & Face Protection (H)

- Preferably non-scratch and non-fogging. Can be either clear / mesh visor & glasses to be worn underneath face shield.
- Eye protection must always be worn during operation & maintenance of the chainsaw.

High Visibility Vest / Shirt (I)

- Some vests are also available with cut resistant fabric for added protection.
- Recommended that high visibility be worn during operation & transportation of chainsaw.

Cut Resistant Gloves (J)

- Should be a snug fit and of a hard wearing, protective fabric. Some gloves have a gel which helps reduce vibration.
- Recommended that gloves be worn during operation & maintenance of the chainsaw.

Cut Resistant Leg Protection (K)

- The cut resistant layers cannot be repaired and the garment should be replaced if it has been cut. The effectiveness of the cut resistant layers maybe reduced overtime by the absorption of oil when used regularly.
- Although not mandatory its is highly recommended to use "chaps" cut resistant leg protection during operation of the chainsaw.

Steel Capped Safety Boots (L)

- Should be non-slip & lace-up for better ankle support. Some safety boots have cut resistant material within the boot.
- Safety boots must be worn during operation, maintenance & transportation of the chainsaw.

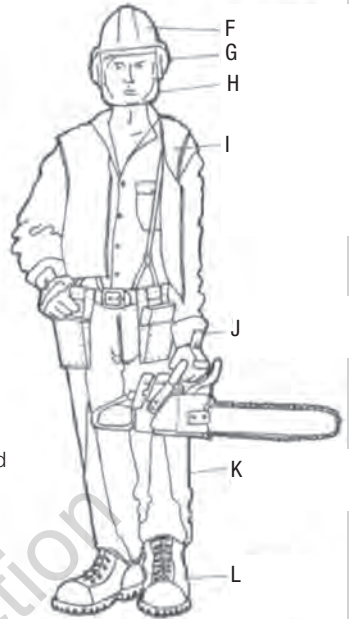



SAFETY & HANDLING

General Safety

WARNING.

Read all safety warnings and all instructions. Failure to follow the warnings and instructions may result in electric shock, fire, and/or serious injury. Save all warnings and instructions for future reference and ensure other users read this manual before use.

Work area safety

- Keep work area clean and well lit. Avoid using chainsaw indoors and in dangerous environments.
- Do not operate machine in presence of flammable liquids, gases or dust. Sparks from operation may ignite dust or fumes.
- Keep children and bystanders away while operating the chainsaw.
- Thoroughly inspect area where chainsaw is to be used. Remove all objects that could be tripped over or thrown when cutting. Thrown objects may cause serious injury.

Personal safety

- Become familiar with all controls and their proper operation before using the chainsaw. Know how to stop the chainsaw and how to disengage the power in an emergency.
- Always wear appropriate clothing & do not wear loose clothing or jewellery that can get caught in moving parts.
- Wear appropriate protective equipment and clothing such as dust mask, non-skid safety shoes, and hard hat. Always wear eye protection.
- Remove all work tools from the chainsaw before turning it on.
- Stay alert & do not operate the chainsaw when tired. Pay close attention when operating chainsaw and ensure others are aware of your intentions before using chainsaw.
- Do not operate the chainsaw while under the influence of alcohol or drugs.
- Do not overreach. Keep proper footing and balance at all times.
- Always walk & never run with the chainsaw and do not use it in a rush.
- Use extreme care when approaching blind corners, doorways or other objects that may obscure your view & path of the chainsaw.
- Keep all parts of body away from the chain when the chainsaw is operating. Before starting the chainsaw, make sure the chain is not in contact with anything.
- Always hold the chainsaw with your right hand on the rear handle and your left hand on the front handle. Holding in reversed hand configuration will increase the risk of personal injury.
- Hold the power tool by insulated gripping surfaces only. Chains in contact with metal parts or live wire may give the operator an electric shock.
- Do not operate chainsaw while up in a tree as this may result in personal injury.
- Always keep proper footing and operate chainsaw only when standing on a fixed, secure and level surface. Slippery or unstable surfaces such as ladders may cause loss of balance or control of the machine.
- Use extreme caution when cutting brush or saplings. The slender material may catch the chain and be whipped toward you or pull you off balance.



General Safety

- When cutting a limb under tension, be alert of spring back. When the tension in the wood fibres is released by cutting it, the spring loaded limb may strike the operator and/or throw the chainsaw out of control.
- Keep handles dry, clean and free from oil and grease. Greasy or oily handles are slippery and may cause loss of control.
- Cut wood only. Do not use machine for unintended purposes. For example, do not use chainsaw for cutting plastic, masonry or non-wood building materials as this is hazardous.

Machine use and care

- If the machine starts to vibrate excessively or if the switch does not turn it on and off. Discontinue use until the chainsaw has been inspected and fixed if required.
- Do not apply excessive force on the chainsaw. Use it for intended application only.
- Remove the battery pack from the chainsaw before making any adjustments, changing accessories, inspecting, adjusting, servicing or cleaning the chainsaw. Such safety measures reduce the risk of starting the machine unintentionally.
- Store machine out of the reach of children. Do not allow children, persons unfamiliar with the machine or an impaired person to use the machine.

Additional safety warnings

- It is recommended that inexperienced users should be trained by an experienced operator.
- Children and juveniles, with the exception of apprentices older than 16 years and under supervision must not operate the chainsaw.
- Operating instructions should be kept handy.
- Unfit or tired persons must not operate the chainsaw.
- The chain should come to a standstill before placing it down.



SAFETY & HANDLING

Additional Warnings

It has been reported that vibrations from hand-held tools may contribute to a condition called Raynaud's Syndrome in certain individuals. Symptoms may include tingling, numbness and blanching of the fingers, usually apparent upon exposure to cold. Hereditary factors, exposure to cold and dampness, diet, smoking and work practices are all thought to contribute to the development of these symptoms. It is presently unknown what, if any, vibrations or extent of exposure may contribute to the condition. There are measures that can be taken by the operator to possibly reduce the effects of vibration:

- Keep your body warm in cold weather. When operating the unit wear gloves to keep the hands and wrists warm.
- After each period of operation, exercise to increase blood circulation.
- Take frequent work breaks. Limit the amount of exposure per day.
- Keep a tight grip on the handles.
- Only use the chainsaw as intended by design and instructions.
- Ensure the chainsaw is well maintained and in good condition.
- Maintain the chainsaw in accordance with these instructions and keep it well lubricated.

If you experience any of the symptoms of this condition, immediately discontinue use and see your physician about these symptoms.

Battery safety warning

- Ensure the switch is in the off position before inserting the battery pack.
- Use only original Briggs & Stratton 18V batteries for the chainsaw. Do not use any other battery packs as this may create a risk of injury and/or fire.
- Do not open the battery to avoid danger of short-circuiting.
- Protect the battery against water, moisture and heat (e.g. continuous intense sunlight and fire) to avoid danger of explosion.
- In case of damage or improper use of battery, vapours may be emitted. In this situation, ventilate the area and seek medical help as vapours may irritate respiratory system.
- The battery can be damaged by pointed objects such as nails or by force applied externally. An internal short circuit can occur and the battery can burn, smoke, explode or overheat.
- Do not short-circuit battery to avoid danger of explosion.

Charger safety warning

- Appliance can only be used by children 8 years and above, persons with reduced physical, sensory or mental capabilities if given supervision, proper instructions for safe use and understanding of safety hazards.
- Supply cord cannot be replaced. If damaged, appliance should be scrapped.
- Only charge Briggs & Stratton 18V Lithium-Ion batteries. Do not charge non-rechargeable batteries.



Kickback Prevention

CAUSES AND OPERATOR PREVENTION OF KICKBACK:

Kickback may occur when the nose or tip of the guide bar touches an object, or when the wood closes in and pines the chain in the cut.

Tip contact in some cases may cause a sudden reverse reaction, kicking the guide bar up and back towards the operator.

Pining the chain along the top of the guide bar may push the guide bar rapidly back towards the operator.

Either of these reactions may cause you to lose control of the chainsaw which could result in serious personal injury. Do not rely exclusively upon the safety devices built into your chainsaw. As a chainsaw user, you should take several steps to keep your cutting jobs free from accident or injury.

Kickback is the result of tool misuse and/or incorrect operating procedures or conditions and can be avoided by taking proper precautions as given below:

- Maintain a firm grip, with thumbs and fingers encircling the chain saw handles, with both hands on the chainsaw and your body and arm positioned to allow you to resist kickback forces.
- Kickback forces can be controlled by the operator, if proper precautions are taken. Do not let go of the chainsaw.
- Do not overreach and do not cut above shoulder height. This helps prevent unintended tip contact and enables better control of the chainsaw in unexpected situations.
- Only use replacement bars and chains specified. Incorrect replacement bars and chains may cause chain breakage and/or kickback. Follow the sharpening and maintenance instructions for the chain. Decreasing the depth gauge height can lead to increased chance of kickback.

WARNING

In order to prevent kickback, please follow these safety instructions:

- Never cut with the tip of the guide bar! Be careful when continuing from previous cuts.
- Always start cutting only when the chain is already running.
- Make sure that the chain is always properly sharpened.
- Never cut through more than one branch at a time! When lopping off branches, be careful not to touch any other branches.
- When cross-cutting, pay attention to trunks standing very close to each other. If possible, use a sawing trestle.

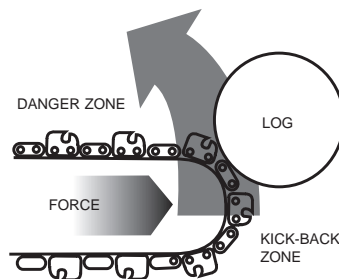
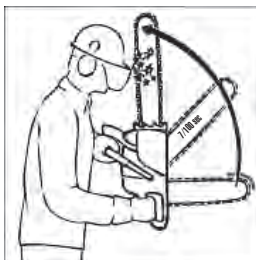



OPERATING INSTRUCTIONS

Installing the Battery

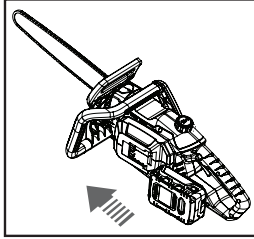
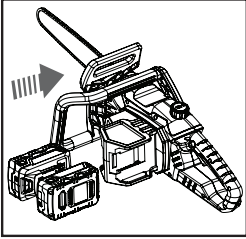

- Place the battery in the chainsaw battery housing by aligning the raised ribs on battery with grooves in the chainsaw's battery port.
- Make sure the locking latch snaps in place and that battery pack is fully seated and secure in the chainsaw before beginning operation.

Removing the Battery

1. Release the trigger to stop the chainsaw.
2. Wait until chain has completely stopped.
3. Press and hold the locking latch.
4. Remove battery from the chainsaw.

WARNING

Check the chain tension before each use of the chainsaw. Remove the battery from the chainsaw before checking the chain tension or making adjustments to the chain. Wear protective gloves while handling the chain, bar or areas around the chain. Please refer to the section "ADJUSTING THE CHAIN TENSION" later in this manual.

WARNING

Never operate the chainsaw without sufficient chain lubrication as this might damage the chainsaw and pose a threat to safety. Check the chain lubricant level and function before each use. Refer to maintenance section for details.

Holding The Chainsaw

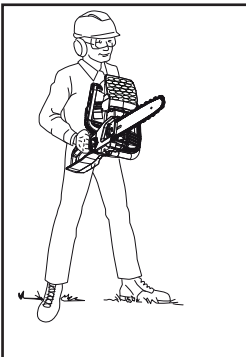

Figure 1

- Always hold the chainsaw with your right hand at the rear handle and your left hand at the front handle.
- Grip both handles with the thumbs and the handles.
- Ensure that your left hand is holding the front handle so that your thumb is underneath. This is important so that control of the saw is maintained and that the built in safety features can be of the most benefit in a kickback or unplanned event
- Always be sure of your footing and hold the chainsaw firmly with both hands while the motor is running.

WARNING

It is highly recommended that you seek professional training in the safe and effective use of a chainsaw.



Starting & Stopping

WARNING

Always keep the chain brake on when not in use to prevent accidental operation.

STARTING OPERATION

- Before starting operation, install the batteries into the machine.
- Press the on/off switch. The chainsaw will beep as the chain brake is on. Once ready turn the chain brake off, this makes the switch trigger operational.
- Start the machine: Press the trigger lock-off button and then pull the trigger.

STOPPING OPERATION

1. Release the power switch trigger to stop the chainsaw.
2. Press the on/off switch to deactivate the chainsaw.

WARNING

In an emergency go straight to step 2 to engage the chain brake. Alternatively activate the chain brake by rolling your left hand forward until the brake is activated. Know how to do this and practise doing it prior to operation.

WARNING

Always remove batteries from the chainsaw when not in use.

Chain Brake Operation

Always check the operating condition and function of the chain brake prior to each use and frequently during use.

- With the chain rotating at full speed, engage the chain brake by rotating your left hand around the front handle, allowing the back of your hand to push the chain brake lever/hand guard toward the bar. Be sure to maintain both hands on the chainsaw handles at all times.
- Reset the chain brake back into the off position by grasping the top of the chain brake lever/hand guard and pulling toward the front handle. Do not have your finger on the trigger whilst resetting the chain brake.

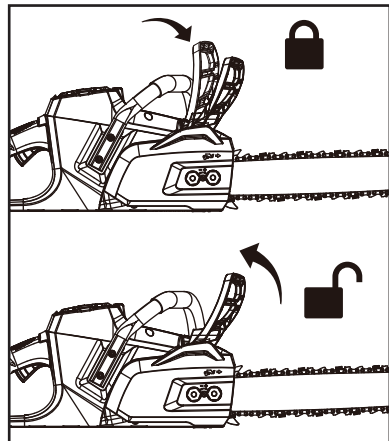

Figure 2

WARNING

If the chain brake does not stop the chainsaw immediately, or if the chain brake will not stay in the either position without assistance, take the chainsaw to an authorized service centre for repair prior to use.



OPERATING INSTRUCTIONS

Cutting Techniques

BUCKING A LOG

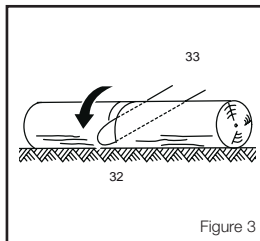

Figure 3

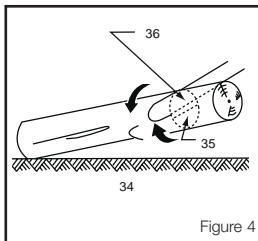

Figure 4

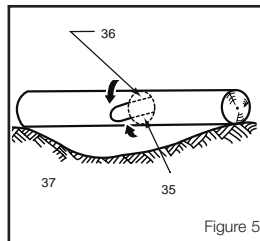

Figure 5

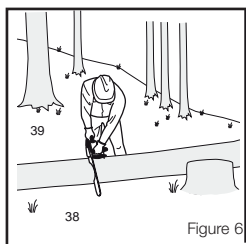

Figure 6

Bucking is cutting a log into lengths. It is important to make sure your footing is firm and your weight is evenly distributed on both feet. When possible, the log should be raised and supported by the use of limbs, logs or chocks.

Follow the simple direction for easy cutting:

1. When the log is supported along the entire length, it is cut from the top (Fig 3) (over buck).
2. When the log is supported on one end, cut 1/3 of the diameter from the underside (under buck). Then make the finished cut by over bucking to meet the first cut. (Fig 4)
3. When the log is supported on both ends, cut 1/3 of that diameter from the top (over buck). Then make the finished cut by under bucking the lower 2/3 to meet other first cut. (Fig 5)
4. When bucking on a slope, always stand on the uphill side of the log. When cutting through, to maintain complete control, release the cutting pressure near the end of the cut without relaxing your grip on the chainsaw handles. (Fig 6)

Do not let the chain contact the ground. After completing the cut, wait for the chain to stop before you move the chainsaw. Always stop the motor before moving from tree to tree.

LIMBING A TREE

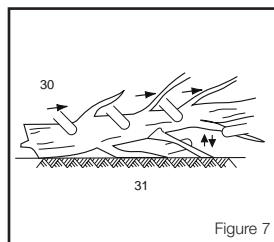

Figure 7

Limbing is removing the branches from a fallen tree. When limbing, leave the larger lower limbs to support the log off the ground. Remove the small limbs in one cut. Branches under tension should be cut from the bottom up, to avoid binding the chainsaw.



WARNING

It is highly recommended that you seek professional training in the safe and effective use of a chainsaw.



Chain & Bar Lubricant

ADDING CHAIN & BAR LUBRICANT

- Unscrew and remove the cap from the oil tank.
- Pour the oil into the oil tank and monitor the oil level gauge. Ensure that no dirt enters the oil tank while filling the oil in.
- Put the oil cap back on and tighten it up.
- One full oil tank will enable you to use the saw for 20-40 min, depending on application.

CHECKING THE CHAIN LUBRICANT

Check the amount of oil in the chainsaw by looking at the oil level gauge. If the oil is low, follow the steps shown in section "ADDING CHAIN & BAR LUBRICANT" of this manual.

Additionally check that the chain is being lubricated sufficiently by performing the following:

- Position the bar nose over a light background (tree stump) and run the chain at approximately half speed.
- Make sure it throws out an increasing trace of oil as shown in the picture below.

WARNING

Never operate the chainsaw without sufficient chain lubrication as this might damage the chainsaw and pose a threat to safety. Check the chain lubricant level before and frequently during use. Be careful not to allow the tip of the bar to contact any surface as kick back may occur.

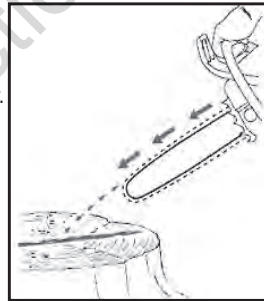

Chain Maintenance

WARNING

Always remove the battery from the machine before checking the chain tension or making adjustments to the chain. Wear protective gloves while handling the chain, bar or areas around the chain.

ADJUSTING THE CHAIN TENSION

- Untighten slightly by turning the chain adjusting knob counterclockwise.
- To increase the chain tension, turn the chain tensioner adjustment knob clockwise and check the chain tension frequently. To reduce the chain tension, turn the chain tensioner adjustment knob counterclockwise and check the chain tension frequently.
- The chain tension is correct when the gap between the drive link in the chain and the bar is between 3mm-4mm. Pull the chain in the middle of the lower side of the bar downwards (away from the bar) and measure the distance between the bar and the chain.



MAINTENANCE & CARE

Chain Sharpening

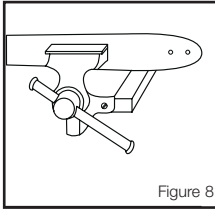

Figure 8

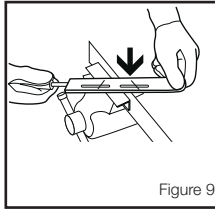

Figure 9

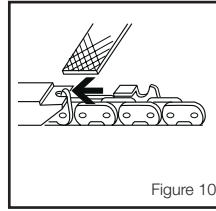

Figure 10

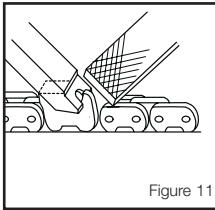

Figure 11

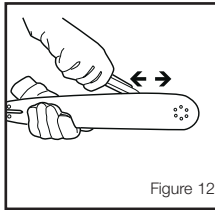

Figure 12

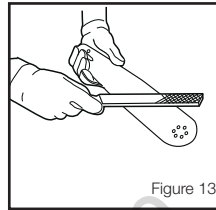

Figure 13

When the chain penetrates into wood with difficulty, it needs to be sharpened as follows:

1. Put the chain under tension.
2. Fasten the bar in a vice so that the chain can slide.
3. Fasten the file to the file holder and place it on chain tooth at 30° angle.
4. File with forward strokes only until all the worn out parts of the cutting edge are taken away.
5. Count the number of strokes given to the tooth as a reference and file away with the same number of strokes on all other cutters.
6. If the depth gauge protrudes from the template after sharpening a few times, reset its level. Use a flat file.
7. Finally, round off the depth gauge if necessary.

NOTE: It is recommended to have the deep gauge tuning and sharpening carried out by a service technician who is equipped with an electric sharpener.

GUIDE BAR MAINTENANCE

- When you have finished working, clean out the groove and the oil passages with a scraping hook.
- Periodically trim the sides of rails using a flat file. If not done in the long run, the feather edges might break away and damage the bar.
- If one rail is higher than the other one, it is necessary to make it even with a flat file then smooth it with a file or fine grain abrasive paper.

When servicing, use only identical replacement parts. Use of any other parts may create a hazard or cause product damage.

WARNING

To avoid serious personal injury, always remove the battery from the tool when cleaning or performing any maintenance.

Contacting the dirt/earth with the chain will blunt the chain quickly.



Bar and Chain Replacement

ASSEMBLY

The user should know how to assemble the guide bar and chain. Check the chain tensioning and add oil as described in this manual before each operation.

REPLACING THE GUIDE BAR AND CHAIN

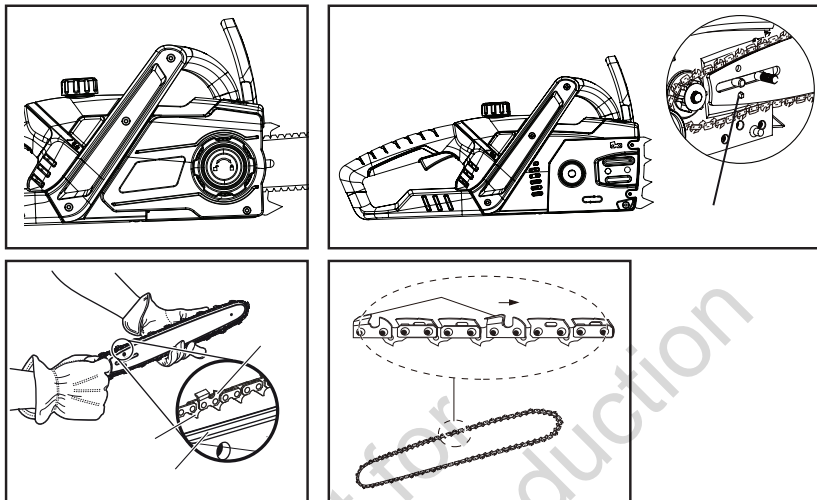

Make sure you remove the battery from the unit. Wear protective gloves.

- Unscrew the sprocket cover tighten knob and remove the sprocket cover.
- The chain should face in the direction of chain rotation. If they face backwards, turn the loop over.
- Place the chain drive links into the bar groove. Position the chain so there is a loop at the back of the bar.
- Hold the chain in position on the bar and place the loop around the sprocket and make sure it is correctly mounted. Make sure the bar hole fits well with bolt for chain tension.
- Replace the sprocket cover, turn the chain tension adjust knob clockwise until the chain is properly tensioned. The guide bar must then be pushed upwards and check chain tension again. Do not tension the chain too tight.
- After the chain is well-tensioned, tighten the knob again.

Note: The chain is properly tensioned if, in the middle of the guide bar, it can be lifted 3mm to 4mm from the edge of the guide bar. Start the chainsaw again with a new chain, allowing it to run-in for 2~3 minutes.

WARNING

After the run-in time, check the chain tension and retighten the chain if necessary.

WARNING

Ensure the chain direction is correct prior to starting the chainsaw operation.



MAINTENANCE & CARE

Service

Servicing requires extreme care and knowledge and should be performed only by a qualified service technician. For service we suggest you return the product to your nearest Authorized service centre for repair. When servicing, use only genuine replacement parts.

- Keep the handles dry, clean, and free of oil and grease.
- In order to reduce the risk of fire, keep the motor free of grass, leaves, and debris build-up.
- Check the chain tension frequently.
- For best and safest performance, maintain the chainsaw with care. Keep the chain sharp and clean. The chains are sharp, and can cut. Wear gloves and use extra caution when servicing.
- Keep all nuts, bolts, and screws tight in order to be sure that the equipment is in safe working condition.
- Never tamper with safety devices. Check them regularly for proper operation.
- For best and safest performance, maintain the chainsaw by;
 - Keeping the chain sharp and clean.
 - Regularly check the bar and guides for burrs. Refer to bar maintenance.
 - After each use, or as required remove the sprocket cover and blade to remove debris and excess chain lubrication to allow free sprocket and chain movement and to prolong chain sharpness and life.

NOTE: Refer to warranty card supplied with this product for service contact details.

Cleaning

To prevent serious personal injury remove the battery from the machine before servicing, cleaning, or removing debris.

- Clean the unit using a damp cloth with a mild detergent.
- Do not immerse the machine or any part of it in water.
- Moisture can cause a shock hazard. Wipe off any moisture with a soft dry cloth & ensure the machine is dry before replacing the battery & key.
- Use a small brush or vacuum cleaner to clean the air vents on the product
- Keep the air vents free of obstructions.
- Do not use solvents, strong detergents, certain aromatic oils such as pine and lemon when cleaning plastic parts. Chemicals can damage, weaken or destroy plastic component which may result in serious personal injury.
- Lubricate the bar after each use. Use a suitable oil for the environment the machine is operated in e.g. silicone based oil or spray. During extended periods of operation lubrication should be applied to the blades.
- Remove the Sprocket Cover and remove debris, oil etc after each use.
- Remove chain and bar and clean thoroughly using a solvent. Ensure all solvent is removed prior to attaching back onto the saw body.

Transporting

Before transporting the chainsaw, always remove the battery from the chainsaw and slide the chain/bar cover over the bar and chain. If the chainsaw is to be transported or stored for long periods it is advisable to drain the chain lubrication fluid from the product.



Storing

The following steps should be taken in order to prepare the machine for storage.

- Clean the machine as described in the previous section.
- Store the machine in a dry, clean location. Do not store it next to corrosive materials, such as fertilizer or fuel.
- Store the machine indoors, in a cool, dry place, out of the reach of children.
- Ensure battery is removed before storage.

Maintenance Chart

Refer to the following chart for routine maintenance.

Features	Requirements	Before Use	After Use	Refuelling bar lub & battery change	Monthly	Yearly	Damaged / Worn	As Required
Chainsaw	Visual Inspection	*	*	*			*	
Chainsaw	Clean (outer shell)	*	*					*
Chain & Bar	Tension	*		*				
Chain & Bar	Sharpen	*		*			*	
Chain & Bar	Replace						*	
Chain Brake	Replace						*	
Sprocket	Replace						*	
Oil Tank	Visual Inspection	*	*					
Lubrication Flow	Check	*						
Chain Catch	Replace						*	

Product Disposal

CORRECT DISPOSAL OF THE PRODUCT



Waste electrical products should not be disposed of with household waste. Please recycle where facilities exist. Check with your local authority or retailer for recycling advice.

The battery contains material which is hazardous to you and the environment. It must be removed and disposed of separately at a facility that accepts lithium-ion batteries.



Refer to Briggs & Stratton 18V Battery & Charger manual for further information relating to battery and charger disposal.

Emergency Contact

In the rare case a battery is damaged & any of the contents leaks or comes into contact with a persons skin, eyes, or is ingested, follow the first aid instructions inside the battery & charger manual. Seek further medical attention immediately.



TROUBLESHOOTING

Troubleshooting

PROBLEM	POSSIBLE CAUSE	REMEDY
Bar and chain running hot and smoking.	Check chain tension for overtightened condition Bar lube reservoir empty.	Tension chain. Refer to Chain Tension earlier in this manual. Check bar lube reservoir.
Motor runs, but chain is not rotating.	Chain tension too tight. Check guide bar and chain assembly. Check guide bar and chain for damage.	Retention chain. Refer to Chain Tension earlier in this manual. Refer to Replacing the Bar and Chain earlier in this manual. Inspect guide bar and chain
Chainsaw is not cutting or is not cutting straight	Chain is blunt	Sharpen or replace the chain

Warning Functions

The chainsaw will alert the operator via an audible "beep" and/or a LED will illuminate in the following situations.

Product Warning	Situation	User action
Green LED	Chainsaw is ON	The chainsaw is ready for use.
Red LED "Beep" sound	Trigger is pulled while the unit has been turned ON	Release trigger prior to turning the chainsaw on.
	Chain Brake is ON	Turn the chain brake off when the operator is ready. WARNING: The trigger is active once the chain brake is off. Always turn the chainsaw off and the chain brake on when the saw is unattended or between operations.
	Load Protection* has been activated	<ul style="list-style-type: none"> Remove the chainsaw from the wood. Inspect the chainsaw for damage. If no damage is observed, start the chainsaw and resume cutting reducing the applied load to prevent further load protection activations.
	The battery has insufficient power to continue chainsaw operation.	<ul style="list-style-type: none"> Stop operation, check the battery charge. If flat then remove and recharge the battery. Fit a charged battery, perform a full product safety inspection prior to restarting, including chain brake operation and lubrication oil level.

* LOAD PROTECTION

The chainsaw has built in load sensing. When the load is high, the chainsaw will shut the motor down immediately and emit beeping sound informing the user that the load protection has been activated protecting the product and user.



Product Specification

PRODUCT SPECIFICATION	18V TWIN CORDLESS CHAINSAW	18V SINGLE CORDLESS CHAINSAW
MOTOR TYPE	DC BRUSHLESS	DC BRUSHED
MOTOR SPEC	36V 1000W	18V 600W
MOTOR SPEED (RPM)	27000	17000
BAR LENGTH (in) / (mm)	14" / 356	10" / 254
BAR MAKE AND MODEL	OREGON 144MLEA041	OREGON 104MLEA041
CHAIN MAKE AND MODEL	OREGON 90PX052X	OREGON 90PX040X
CHAIN GAUGE (in)	0.043"	0.043"
CHAIN PITCH (in)	3/8"	3/8"
CHAIN SPEED (m/s)	14.5	7
BAR LUBRICATION CAPACITY (ml)	130	130
PRODUCT WEIGHT (KG)	3.3	3.3
PRODUCT WEIGHT WITH BAR AND CHAIN (KG)	4.0	3.8
SOUND PRESSURE LEVEL, dB(A) K = 3.0 dB(A)	88	81
MEASURED SOUND POWER LEVEL, dB(A) K = 3.0 dB(A)	98	92
GUARANTEED SOUND POWER LEVEL, dB(A)	102	95
VIBRATION ¹ (m/s ²)	3.5	2.7

¹ Value for use for assessment of user exposure. Actual vibration during use of the chainsaw may differ depending on actual conditions. Uncertainty of measurement, K = 1.5 m/s²

REMARKS:

- The declared vibration value has been measured with a standard test method and may be used to compare one tool with another.
- The declared vibration value may be used in a preliminary assessment of exposure.

WARNING

The actual vibration values during use of the tool can be different from the above stated and depend on the use of the tool; and the need to identify safety measures to protect the operator are based on an estimation of exposure in the actual conditions of use (taking account all parts of the operating cycle such as the times when the tool is switched off and when it is running idle in addition to the trigger time).

Not for
Reproduction

©2021 Briggs & Stratton LLC

Victa is a trademark of Briggs & Stratton LLC.

All rights reserved. No part of this booklet may be reproduced by any means without prior written permission. All information herein is subject to change without notice.