

# **VICTA**

Reproduction

## **Line Trimmer Attachment Assembly and Owner's Manual**



**WARNING!** Read this manual before operating your VICTA trimmer.



# IMPORTANT NOTES

## Please read the following

Thank you for purchasing your VICTA Combi-Tool attachment. VICTA prides itself in the quality and performance of all its products. This instruction manual will aid in the assembly, safe operation and maintenance of your trimmer attachment. Please read the following warnings to ensure safety and the long life of your product.

## Intended Use

This product is intended to be used with the following Victa Combi-Tool powerheads.

1. Petrol powerheads: Model numbers are: 1697411, 1697385, 1697386.
2. Li-ion battery powerheads: Model numbers are: 80102220, 1697389.

**Note:** In this manual, both the the petrol powerhead and Li-ion battery powerhead are termed as powerhead unit. Please refer to the powerhead unit manual as well for safe operation and usage.

**Note:** Before carrying out any maintenance in the attachment unit, powerhead unit must be switched off and the spark plug to be removed if using petrol powerhead or the battery to be removed if using Li-ion battery powerhead.

## Safety Markings and Symbols



Warning!



Be careful of objects being thrown out!



Read the directions for use before operating the machine.



Read the directions before carrying out any maintenance work.



Wear safety goggles, a helmet and ear protection.



Do not use rigid cutting disk.



Wear sturdy, non-slip footwear.



Do not use solid saw edged blades.



Wear safety gloves.

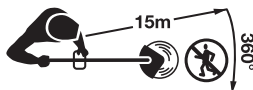

All bystanders must be kept at least 15 m from the machine.









Do not use the machine in wet conditions. Protect the machine from rain and damp.



Tool continues to run some seconds after stopping.



## Table of Contents

	Features & Definitions	
	Features Definitions	1
	Safety & Handling	
	Safety Instructions	2
	Personal Safety Equipment	3
	Safety Hazards	4
	Assembly Procedures	
	Guard Assembly	4
	Shaft Assembly	5
	Trimmer Line Assembly - (Bump Head)	6
	Trimmer Line Assembly (Cast Alloy Head)	8
	Cutting Head Assembly	9
	Operating Instructions	
	Before Starting	10
	Feeding the Bump Head Line	10
	Practical Tips	10
	Trimming Procedures	11
	Maintenance & Care	
	Storage	11
	Maintenance Chart	12
	Troubleshooting	
	Troubleshooting	13

NOTE – WARRANTY DETAILS ARE NOT WRITTEN WITHIN THIS OPERATOR'S MANUAL. REFER TO OTHER DOCUMENTS SUPPLIED WITH THIS MACHINE FOR WARRANTY DETAILS.



# FEATURES & DEFINITIONS

## Bent Shaft Attachment

- 1 Bent Shaft
- 2 Gear Head
- 3 Bump Head
- 4 Cut-Off Blade
- 5 Trimmer Guard
- 6 Tool Kit (Not Shown)
- 7 Instruction Manual and Warranty (Not Shown)

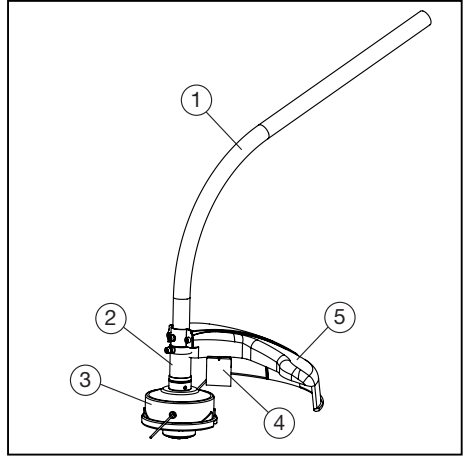

## Straight Shaft Attachment

- 1 Straight Shaft
- 2 Gear Head
- 3 Bump Head
- 4 Cut-Off Blade
- 5 Trimmer Guard
- 6 Tool Kit (Not Shown)
- 7 Instruction Manual and Warranty (Not Shown)

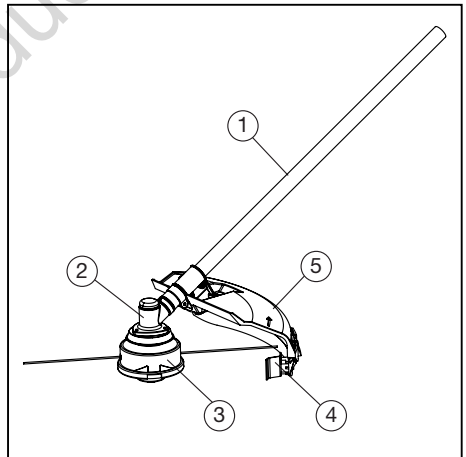

Do not operate the VICTA Combi-Tool Trimmer attachments before reading all safety and handling sections.



## Safety Instructions



**Do not operate the VICTA Combi-Tool attachments before reading all instructions & reading all safety & handling sections.**

### Operator Safety

- Wear the necessary safety equipment, as listed on page (5), in the Personal Safety Equipment section.
- Always wear heavy, long pants. Do not wear loose clothing, jewellery, short pants, sandals or go barefoot. Secure hair so it is above shoulder length.
- Do not operate the unit if you are tired, ill or under the influence of alcohol, drugs or medication.

### Unit Safety

- The product is intended for garden maintenance trimming of organic ground covering such as grass and lawn. The product must not be used for or modified for uses other than is intended, unless approved by the manufacturer.
- Inspect the entire unit and cutting head before each use.
- Ensure that the guard is properly attached.
- Do not use the unit if it is running erratically. Have it serviced promptly.
- Learn how to stop the powerhead unit quickly in an emergency.
- Stop the powerhead unit when the unit is unattended. Never leave powerhead unit running while unattended.
- Never allow children or unauthorised persons to operate the unit.
- Do not leave the unit on dry cuttings when it is hot, as a risk of fire is present. Do not cover muffler or restrict airflow to muffler.

### Starting Safety

- Start the powerhead unit with feet well away from the cutting head.
- Ensure that the area of starting and operation is clear of sticks, stones, glass, nails, wire, string and debris, which could be thrown by the cutting head.

### Cutting Safety

- Use only in good visibility and favourable weather conditions.
- Keep children, animals and bystanders outside the 15 metre hazard zone. Stop the powerhead unit immediately if approached.
- Keep the powerhead unit to the right of your body, holding the unit with both hands.
- Keep a firm footing and balance. Do not over reach.
- Keep the cutting head below waist level and do not raise the powerhead unit above your shoulder.



# SAFETY & HANDLING

## Safety Instructions

- Keep your body away from the cutting head and muffler when the unit is running.
- Do not strike objects that may cause harm or damage to the unit.

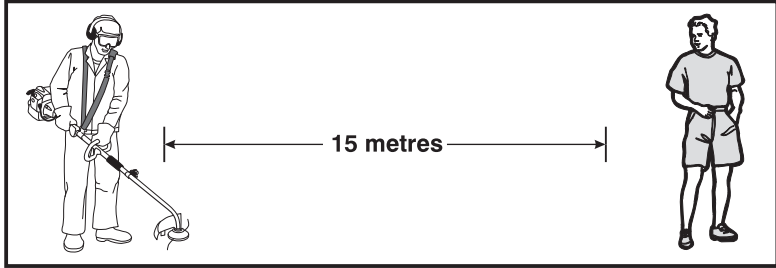

## Maintenance Safety

- Stop the powerhead unit and disconnect the spark plug (or remove the battery) before clearing blockages, checking or working on the unit. Clean carbon from the muffler at exhaust outlet frequently.
- Stop the powerhead unit and disconnect the spark plug (or remove the battery) and inspect the unit if it begins to vibrate abnormally or if it strikes a foreign object.
- Use only recommended trimmer line with diameter of 2.0mm to 3.0mm.. Never use wire, rope, string, etc.
- Use only genuine VICTA replacement parts.

## Transporting and Storage

- Hand carry the unit with the powerhead unit stopped and the muffler (in case of petrol powerhead) away from your body.
- Allow the powerhead unit to cool, empty the fuel tank (or remove the battery) and secure the unit before storing or transporting in a vehicle.
- Empty the fuel tank after each use and before storing the unit. In case of Li-Ion powerheads, remove the battery before storing the unit.
- Store the unit and fuel well away from sparks or open flames from water heaters, electric motors, switches or furnaces, etc.
- Store the unit out of reach of children and unauthorised persons.

## Personal Safety Equipment

Always use the following safety equipment when working with your trimmer:

- A safety helmet fitted with a visor or suitable eye protection.
- A set of ear muffs.
- A pair of protective gloves.
- A pair of safety boots.





## Safety Hazards

The following safety precautions must be strictly observed to avoid the risk of damage or personal injury.



Prior to using the unit, clear the operating area of objects which may be thrown up by the cutting head, such as rocks, glass and other debris.



Be careful when operating the unit on slippery ground or overgrown terrain. Be attentive for concealed hazards, such as ditches, tree stumps and roots.



Maintain solid footing and balance while operating the unit. Cut only on ground level.



Never use the attachment unit without the guard securely in place.



Do not touch the cutting head in motion. When handling blade for assembly or maintenance tasks, always wear protective gloves.



Bystanders must be at least 15 meters away during operation of the unit, as rocks and other materials may be thrown at high velocities. Switch the unit off immediately, if approached.

## Guard Assembly

### Fitting the Bent Shaft Guard

1. Remove screws and bracket from guard. (Fig 4).
2. Place the guard as shown below, using the center screw to align the location. (Fig 5).
3. Now, fasten the 2 other screws firmly. (Fig 6).

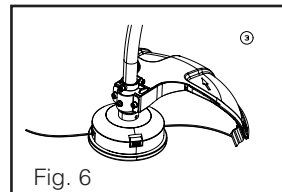
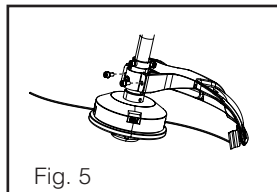
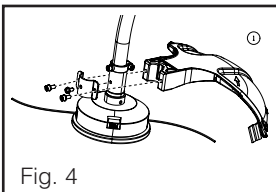

**CAUTION!** Do not use the trimmer without the guard.



# ASSEMBLY PROCEDURES

## Guard Assembly

### Fitting the Straight Shaft Guard

1. Remove four screws from bottom of the guard (Fig 7).
2. Position guard under the securing saddle (Fig 8).
3. Secure the two screws into the guard (Fig 9).

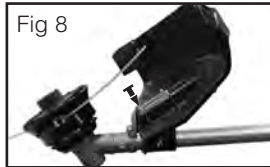

**CAUTION! Do not use the trimmer without the guard.**

## Shaft Assembly

### Assembling the Split Shaft

1. Loosen the knob (3) on the split shaft coupling (1). Refer Fig.-10.
2. Then push the pin (4) on the attachment shaft (2) inwards and carefully slide the attachment shaft in the coupling.

**Note:** When inserting attachment shaft into the coupling, shifting of the shaft alignment by slight rotation of the cutting head may assist with smoother engagement.

3. Ensure that the pin (2) on the attachment shaft locks into the corresponding hole on the coupling.
4. Then firmly re-tighten the knob (3).
5. To disassemble, reverse order of assembly.

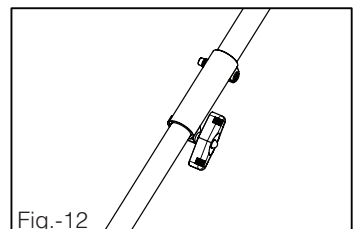
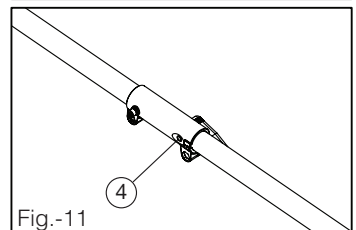
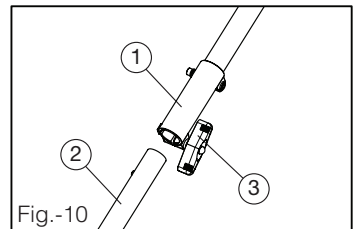

Locking the pin (2) into the shaft hole (5) ensures full engagement of drive shafts. Failure to fully engage drive shafts will damage the connection & void product warranty. (Fig.11).



Do not Start or Run powerhead unit without shafts & guards fully assembled.

Take care when fitting & tightening. Beware of pinch points.





## Trimmer Line Assembly - Bump Head

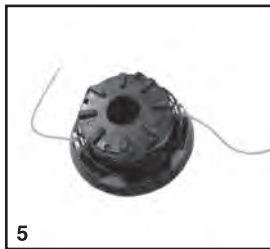
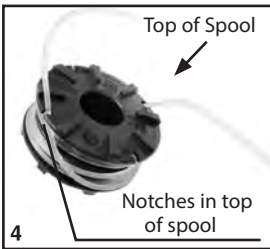
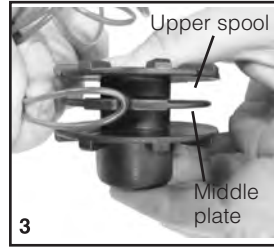
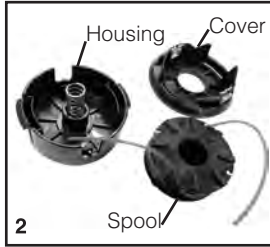

1. Press two cover clips inwards on the housing & remove the cover slowly.
2. Remove the remains of worn line from the spool (if any remains).
 

**Note:** Remaining line may be sufficient to rewind and reuse if it has been tangled or has retracted back into the housing.

**Note:** Ensure inside of housing and spool are clean and free of grass & soil before refilling.
3. Use 6 meters of diameter 2.4mm nylon line\*. Fold the full length of line in the center and insert the centre fold into one of the slots in the spool middle plate.
4. **For Straight Shaft Trimmer:** Wind the upper half of the line tightly '**CLOCKWISE**' onto the upper spool.
 

**Note:** '**CLOCKWISE**' direction when looking at the top of the spool as shown by the arrow in Fig.4.
5. **For Bent Shaft Trimmer:** Follow the same process as listed in point 4, but in '**ANTICLOCKWISE**' direction.
6. Continue winding until approximately 10cm remains at the end of the line and hold line end by locking into one of the four notches on the top of the spool. Refer Fig. 4.
7. Repeat process with other half of the line winding in the **SAME DIRECTION** on the lower spool and hold the line end in an opposite notch.
8. Put the spool back into the cover. Remove one end of the line from the spool notch & push it into an Eyelet slot. Repeat for the other end of the line into the opposing Eyelet slot. Pull both ends of line tightly through the eyelets to remove any excess slack in spool winding.
9. Push the spool and cover back into the housing so that the housing clips align with the cover and clicks back into place.

\* 2.4mmø nylon line is recommended to provide best performance. The bump head can be fitted with line diameters from 2.0mm to 3.0mm. The maximum length of the line that can fit the head varies according to the line diameter. The maximum length capacity using 2.4mmø is 6 metres. Do not overfill the head spool with excessive lengths of line as it will result in ineffective spool feeding of line.



# ASSEMBLY PROCEDURES

## Trimmer Line Assembly - Bump Head

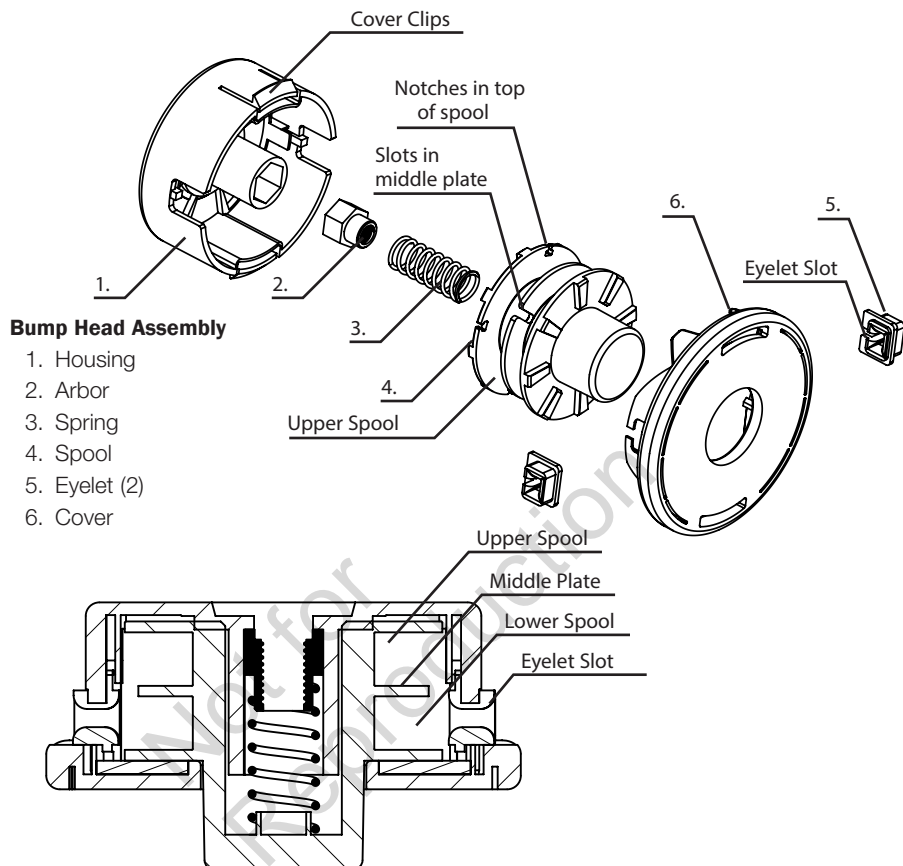

Follow the Operating Instructions on page (6) to adjust the length of the line.



Nylon line will deteriorate over time and may require replacement if line breakages and cut performance is not satisfactory

Do not operate the bump head with parts missing such as the spring or eyelets



Do not operate the bump head if the cover is not secured by the Cover Clips.

Do not operate the bump head if components are damaged or excessively worn.

Always ensure the line cutting blade on the guard is covered with the blade protector when fitting, changing or removing the bump head.



Never operate the machine without a cutting head fitted. Never fit an alternative cutting head that has not been recommended by the manufacturer.



## Trimmer Line Assembly - Cast Alloy Head

**Note:** Not provided in the package. Cast alloy head is available as an accessory with some models at Victa authorized dealers.

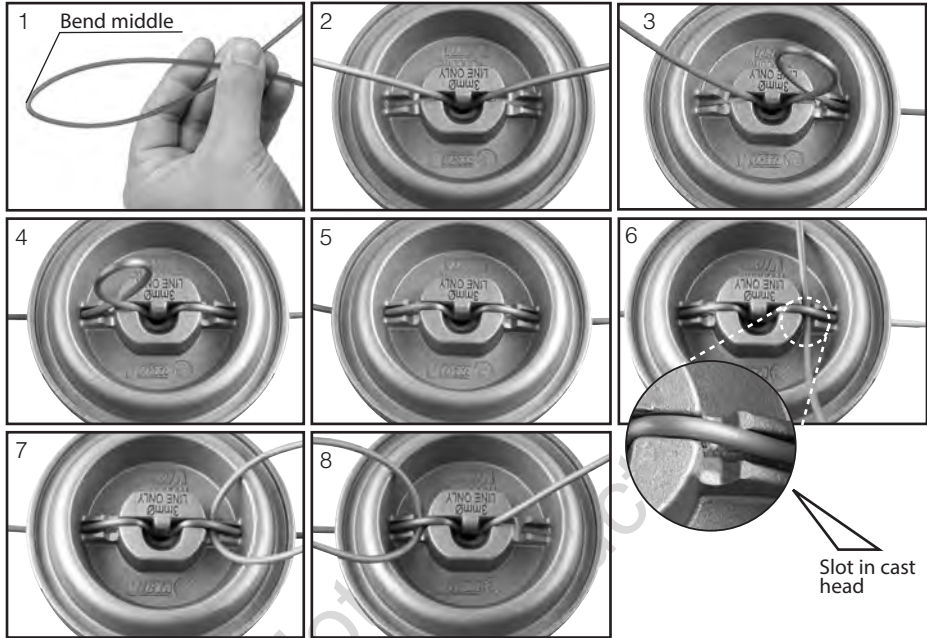

1. Cut a length of trimmer line to 44cm. Bend line in half at the centre (equal ends). Use only 3mm diameter Nylon line (Fig: 1)
2. Push the bent end of the line under the lug of the trimmer head
3. Push one end of the line into the hole on the same side of the head as the line end. Pull the line through the hole until loops or slack between the hole centre lug is removed.
4. Repeat step 3 for opposite side.
5. Refer to image for correct complete assembly of the nylon line into the head.
6. To remove used line, bend new line as in (1), slide new line under used line through slot in cast head.
7. Holding both ends of the new line together, pull the old line out of the cast head. Repeat process for the other side (8).



Only use recommended 3.0mm diameter nylon trimmer line in the Cast Alloy Head.

Unequal lengths of line, or mounting of line "off-centre" will cause vibration & damage to unit.



Excessive trimmer line length will damage guard and clutch or tangle in head gearbox. Do not fill head with excessive length line longer than limits of the guards.



Replace line when worn to approximately 50mm from trimmer head body. Remove line by pushing length back into head or by levering out from centre.

Nylon line will deteriorate over time and may require replacement if line breakages, line wear & cut performance is not satisfactory.



# ASSEMBLY PROCEDURES

## Cutting Head Assembly



Always ensure the line cutting blade on the guard is covered with the blade protector when fitting, changing or removing the trimmer head.

Always disconnect the spark plug lead before and work is done on the trimmer.



Never operate the machine without a cutting head fitted.

Never fit an alternative cutting head that has not been recommended by the manufacturer.

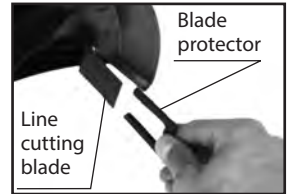

## CUTTING HEAD REMOVAL & REPLACEMENT

### BENT SHAFT CUTTING HEAD

1. Cover the cutting blade with protector.
2. Align hole in Gearbox Mounting & slot on the shaft.
3. Insert Allen Key into hole & firmly support to lock shaft rotation.
4. Grip the head & rotate **anti-clockwise** to remove.
5. Refit preferred head in reverse order & firmly tighten.

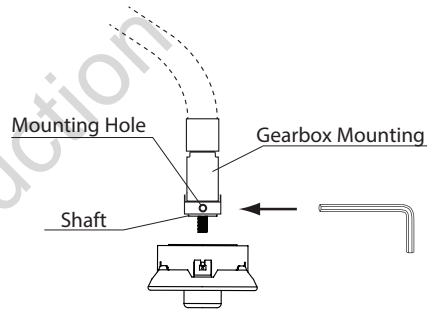

### STRAIGHT SHAFT CUTTING HEAD

1. Cover the cutting blade with protector.
2. Align hole in Mounting Washer and Gearbox slot.
3. Insert Allen Key through hole in Gearbox Flange, through hole in Mounting Washer. Firmly support Allen key to lock shaft rotation.
4. Grip the head & rotate **clockwise** to remove.
5. Refit preferred head in reverse order & firmly tighten.

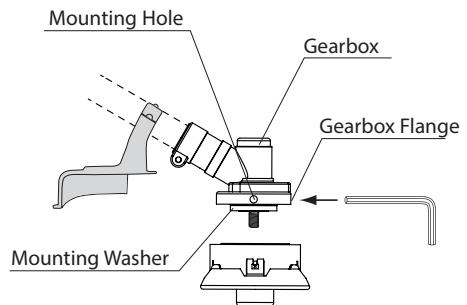

It is important to note the direction of rotation to tighten/remove heads & to avoid over-tightening or damage to the Gearbox, Spindle or mounting thread.

Not firmly supporting alignment locking of shaft with the Allen Key may cause damage to the Gearbox or Mounting Washer.



## Before Starting



Check the position & operation of controls to ensure you are comfortable before you start using the machine. Triggers, starter cord and grip position should provide smooth operation, balance and comfort before starting the machine. Check that all screws are securely fastened and also check all the safety devices.



Always use the shoulder strap when using the machine. Switch off the powerhead unit before you take off the shoulder strap.

Check the machine for the following each time before use:

- That the cutting unit and all safety devices are in perfect condition
- That all screws are securely fastened

## Feeding Bump Head Line

To increase the length of nylon trimming line when using the Bump Head;

1. Run the trimmer at maximum RPM while firmly bumping the spool on the ground.
2. The line will come out incrementally each time head is bumped.
3. Check the length after each bumping and repeat till the required length is achieved.
4. Bump and feed the line before it becomes too short and fall back into the bump head. If this happens refer to the section of "Trimmer Line Assembly – bump head" on page 6.

**Note:** refer to "Troubleshooting - Bump head" if the line is not coming out when bumping.



**DO NOT touch the bump head while the powerhead unit is running.**

**DO NOT Bump feed excessive lengths of line longer than the limits of the guards.**

## Practical Tips

- Practice all operating techniques with the powerhead unit switched off before you start to use the machine.
- Remove weed/grass wrapped around head/shaft.



**DO NOT use steel wire or plastic-coated steel wire of any kind with your string head. Serious operator injury can result.**



**Periodically remove weed wrap to prevent overheating the drive shaft. Weed wrap occurs when strands of weed become entangled around the shaft beneath the debris shield. This condition prevents the shaft from being properly cooled.**

- When properly equipped with a guard and cutting head, your unit will trim unsightly weeds and tall grass in those hard-to-reach areas – along fences, walls, foundations and around trees. It can also be used for scalping to remove vegetation down to the ground for easier preparation of a garden or to clean out a particular area.



**Trimming around foundations, brick or stone walls, curves, etc. will result in above normal string wear.**



# OPERATING INSTRUCTIONS

## Trimming Procedures

### Trimming / Mowing

- Swing trimmer with a sickle-like motion from side to side. Do not tilt the cutting head during the procedure. Test area to be trimmed for proper cutting height. Keep string head at same level for even depth of cut.

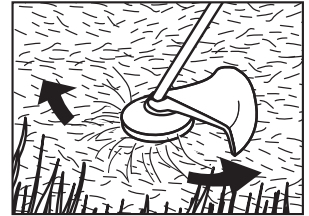

### Fence / Foundation Trimming

- Approach trimming around chain link fences, picket fences, rock walls and foundations slowly to cut close without whipping string against the barrier. If the string comes in contact with rock, brick walls, or foundations, it will break or fray. If string snags fencing, it will snap off.

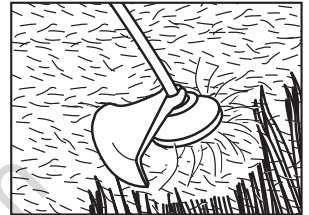

### Trimming Around Trees

- Trim around tree trunks with a slow approach so string does not contact bark. Walk around the tree trimming from left to right. Approach grass or weeds with the tip of the string and tilt cutting head slightly forward.

### Scalping

- Scalping refers to removal of all vegetation down to the ground. To do this, tilt the cutting head to about 30 degree angle to the left. By adjusting the handle you will have better control during this operation. Do not attempt this procedure if there is any chance flying debris could injure operator, other people or cause damage to property.



**Use extreme caution when SCALPING. Keep a distance of 100 feet (30 metres) between operator, other people and animals during these operations.**

## Storage

### Storage Preparation

1. Carry out all the maintenance work required prior to storing.
2. Leave the machine to cool (approximately 5 minutes).
3. Clean the exterior housing of the machine.
4. Store the machine in a cool, dry place where it is out of the reach of ignition sources & inflammable substances.
5. Fertilizers and other chemical garden products often contain substances that accelerate the rate of corrosion of metals. Do not store the machine on or near fertilizers or other chemicals.

**Note: Storage and other maintenance work can be either carried with the attachment tool assembled or disassembled from the powerhead unit.**



## Storage

### Before Using

1. Inspect the cutting head of any damage and make sure it is installed properly. Adjust the trim line length or change the trim line if damaged.  
**Note: Use recommended Trimmer line of diameter 2.0m to 3.0mm for replacement.**
2. Inspect the trimmer guard for any damage and make sure it is installed properly.
3. Assembly with the powerhead unit may or may not be required before using.

### Transport

1. Clean coarse dirt off the machine with a brush.
2. Cut-off blade on the attachment unit safety guard is covered with the blade protector.
3. If the attachment unit is not dismantled from the powerhead unit, please refer to the powerhead unit manual for instructions on transport.

## Maintenance Chart

Refer to the following table for routine maintenance.

Features	Requirements	Before	After finish	Refuelling	Monthly	Yearly	If damaged	As required
<b>Trimmer</b>	Visual inspection (leaks)	●		●				
<b>Cutting Head Assy</b>	Check & clean		●					●
<b>Nylon Line</b>	Stock replacement							
<b>Cast Trimmer Head</b>	Clean	●						
	Replacement						●	●
<b>All accessible fasteners</b>	Retighten	●						●
<b>Bump Head</b>	Inspect	●	●					●



Always stop the powerhead unit before any maintenance is done on the attachment tool. When all parts have stopped rotating, remove the spark plug (or remove the battery) to begin maintenance work or dismantling.



Never repair cutting attachments by welding, straightening or custom reworking of parts. This may result in product failure or serious injury.



Never attempt maintenance that is not outlined in this manual. All repair work must be carried out by a VICTA Authorised Service Centre.



# TROUBLESHOOTING

## Troubleshooting

Problem	Possible cause	Remedy
<b>Unit main body</b> Irregular vibration or trimmer head spins with powerhead unit idling	Loose trimmer head Broken clutch spring, bent main shaft Worn shaft bearings Loose gear head	Tighten firmly Contact Service Centre Contact Service Centre Tighten bolt securely/Contact Service Centre
<b>Bump Head</b> Line doesn't come out when head is bumped	Inappropriate winding of line. Line inside bump head is nearly finished.	Open bump head and rewind the line ("Fitting trimmer line - bump head" on page 9) Replace the residual line with the new line ("Fitting trimmer line - bump head" on page 9)

If running difficulties continue, contact your closest VICTA Authorised Service Centre in Australia or New Zealand. Please look up and locate your local Authorised Service Centre on [www.victa.com](http://www.victa.com) or contact Victa Lawncare Customer Service. Refer to the warranty card for the contact details.

Not for  
Reproduction





Not for  
Reproduction





Not for  
Reproduction

Not for  
Reproduction

©2021 Briggs & Stratton LLC

Victa is a trademark of Briggs & Stratton Australia Pty Ltd

ABN 13 006 576 856

All rights reserved. No part of this booklet may be reproduced by any means without prior written permission. All information herein is subject to change without notice.

**[WWW.VICTA.COM](http://WWW.VICTA.COM)**