

BWM 30 Ton Log Splitter

(With hydraulic lifting table)

User's Manual

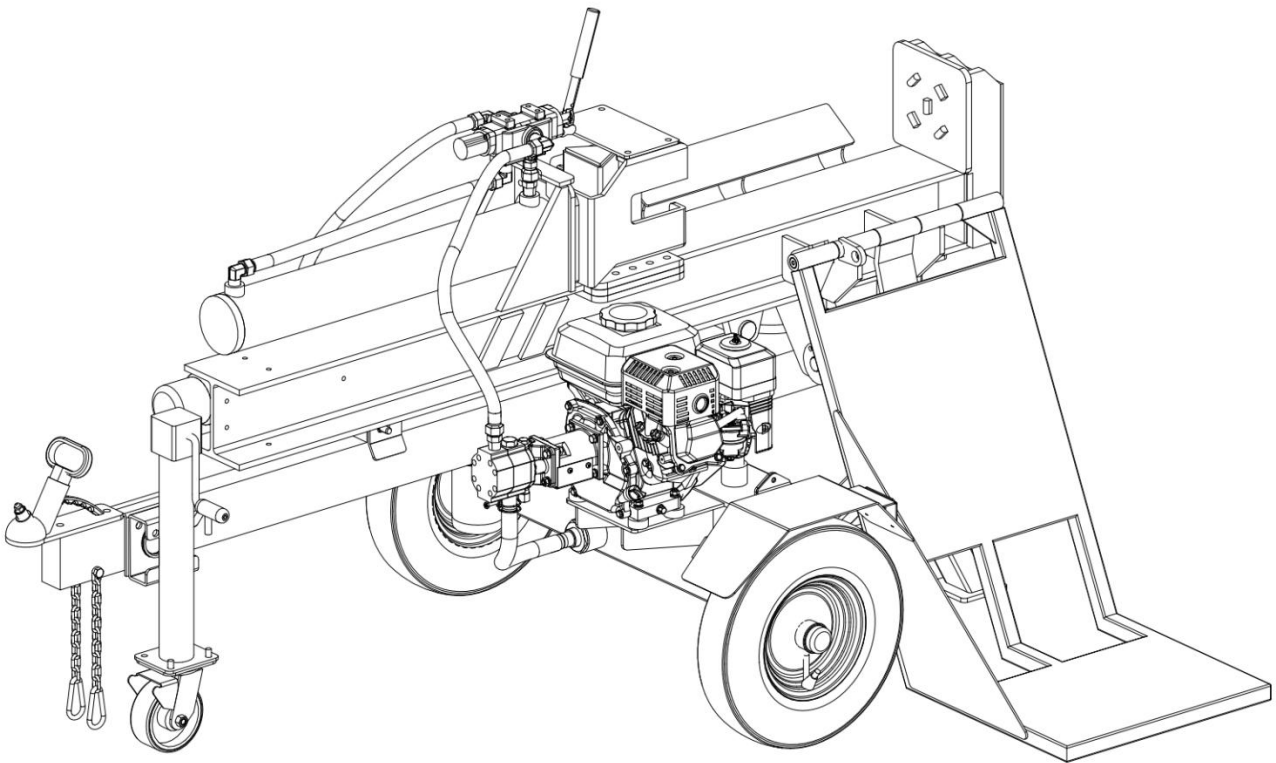

BWM LSD30 Deluxe Series

Please read through this owner's manual carefully before using the product, to ensure the safety of yourself and others.

**Due to continuing improvements, actual product may differ slightly from the product described herein.*

Index

1. General Warnings and Rules.....	3
2. Hazard Signal Definitions.....	4
3. Controls and Features Identification.....	5
4. Assembly Instructions.....	7
5. Operating Instructions.....	15
6. Maintenance and Storage.....	19
7. Troubleshooting.....	20
8. Specifications.....	21
9. Warranty.....	22
10. Illustrated Parts List.....	23



GENERAL WARNINGS



READ and UNDERSTAND this manual completely before using 30 Ton Log Splitter.

Operator must read and understand all safety and warning information, operating instructions, maintenance and storage instructions before operating this equipment. Failure to properly operate and maintain the log splitter could result in serious injury to the operator or bystanders.

Operation Warnings

- Do not at any time carry passengers, sit or stand on the log splitter.
- Do not allow children to play on, stand upon or climb on the log splitter.
- Always inspect the log splitter before using to assure it is in good working condition.
- Replace or repair damaged or worn parts immediately.
- Always check and tighten hardware and assembled parts before operation.
- Do not exceed equipment maximum load capacity of 30 tons.
- Avoid large holes and ditches when towing the equipment.
- Always operate the log splitter on clear and level ground.
- Do not operate the log splitter at night, only during daylight hours.
- Always tow at reduce speed in rough terrain, along creeks, ditches and on hillsides.
- To avoid personal injury and/or equipment damage **DO NOT EXCEED 72 KM/H.**
- Always refer to the vehicle owner's manual for proper towing.
- Always secure and lock the log splitter to the vehicle hitch before towing.

Crush and Cut Hazards

- Always keep hands and feet clear from moving parts while operating the equipment.
- Always clear and keep work area clean and free of debris when operating.
- Always wear safety gear, eye protection, gloves and work boots when operating the log splitter.







WARNING

The warnings, cautions, and instructions outlined in this instruction manual cannot cover all possible conditions or situations that may occur. It must be understood by the operator that common sense and caution are factors which cannot be built into this product and must be supplied by the operator.

Assembly Is Required

This product requires assembly before use. See "Assembly" section for instructions. Because of the weight and/or size of the log splitter, it is recommended that another adult be present to assist with the assembly. **INSPECT ALL COMPONENTS** closely upon receipt to make sure no components are missing or damaged.

Hazard Signal Word Definitions

	<p>This is the safety alert symbol. It is used to alert you to potential personal injury hazards. Obey all safety messages that follow this symbol to avoid possible injury or death.</p>
	<p>DANGER indicates an imminently hazardous situation which, if not avoided, will result in death or serious injury.</p>
	<p>WARNING indicates a potentially hazardous situation which, if not avoided, could result in death or serious injury.</p>
	<p>CAUTION indicates a potentially hazardous situation which, if not avoided, may result in minor or moderate injury.</p>
	<p>CAUTION used without the safety alert symbol indicates a potentially hazardous situation which, if not avoided, may result in property damage.</p>

ABOUT YOUR 30 TON LOG SPLITTER

This hydraulic log splitter has a heavy-duty steel construction and 30 tons of ram force. When there's work to be done, you need outdoor power equipment you can rely on, this log splitter will get the job done fast. It is designed to work in the horizontal position. It is easy to tow, easy to use and maintain. Never exceed the rated capacity of 30 tons when operating the log splitter.

Technical specifications on the log splitter are provided in the "Specifications" section of this manual.

Controls and Features Identification

Read this owner's manual before operating the equipment. Familiarize yourself with the location and function of the controls and features. Save this manual for future reference.

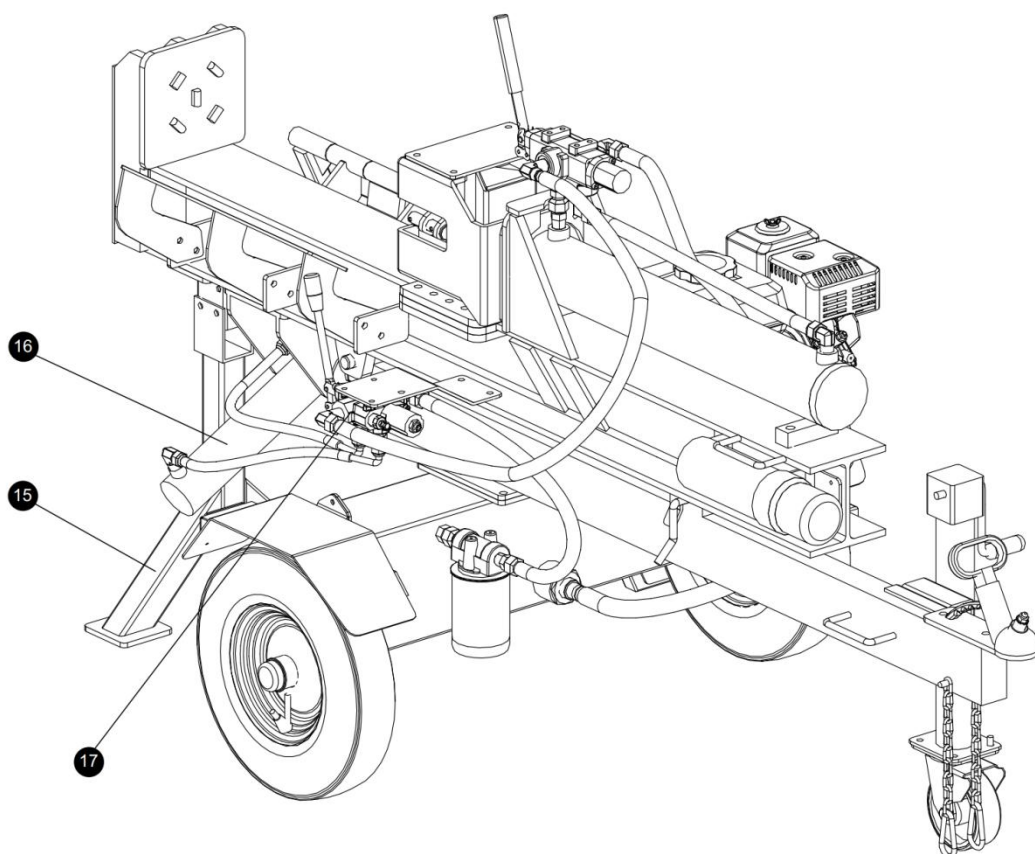
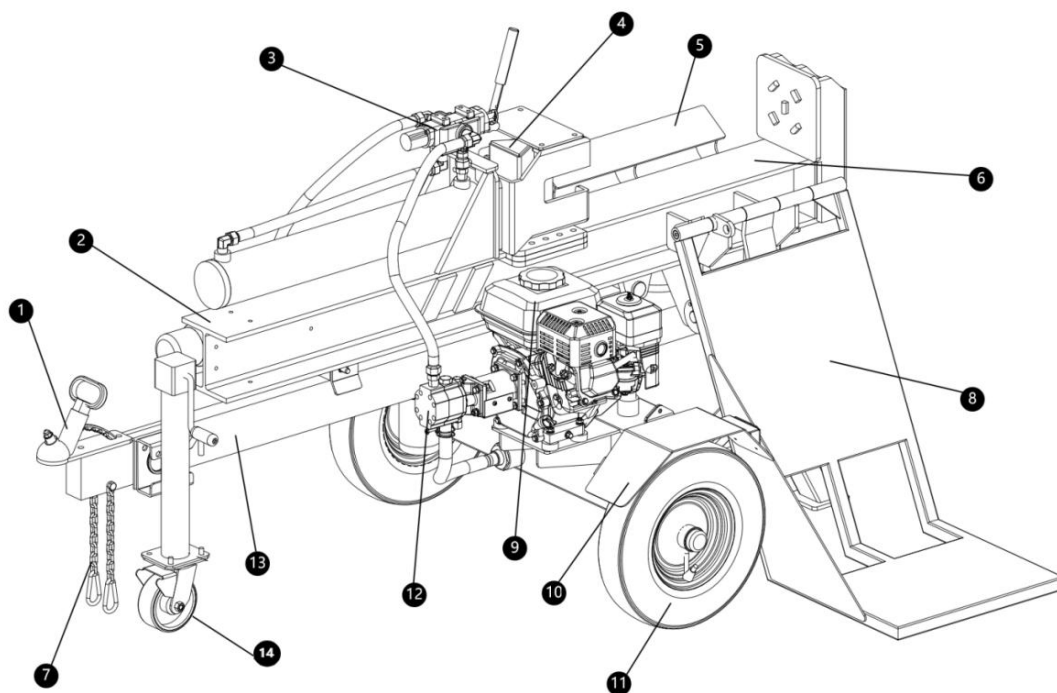

- 1) **50mm Coupler** – Attaches the log splitter to the 50mm hitch ball.
- 2) **Hydraulic Cylinder** – 4½" (115mm) bore and a 23.6" (600mm) stroke.
- 3) **Control Valve Lever** – Controls the forward and backward movement of splitting wedge.
- 4) **8" (20cm) Wedge** – Features wedge wings and tapered ends making splitting easier.
- 5) **Log Cradle** – Keeps the log on the beam without operator assistance.
- 6) **Beam** – 6" extra wide flange.
- 7) **Safety Chains** – Safety feature to prevent loss of log splitter while towing.
- 8) **Hydraulic Lifting Table** – used to lifting the log
- 9) **Engine** – HONDA GX200, Briggs & Stratton 6.5HP or Loncin 6HP.
- 10) **Fenders**
- 11) **Tyres** - Maximum rated towing speed is 72KM/H
- 12) **Gear Pump**- Pumps the hydraulic oil through the system.
- 13) **Tow Bar**
- 14) **Jockey Wheel** – 8"
- 15) **Rear Support Leg** – The leg supports the log splitter steadily while operating
- 16) **Hydraulic Table Lift Ram** – To lift and lower the hydraulic table
- 17) **Hydraulic Table Control**



WARNING



Engine Shipped Without Oil.

Before starting engine, fill with 600ml of Briggs SAE30 engine oil or Honda 10W30 engine oil, depending on your model. See engine manual for engine oil capacity.

Hydraulic Oil Tank is Shipped Without Oil.

Add 18L of AW32/AW46 hydraulic oil before the first use. When topping up oil verify the oil level using the Oil filter/Dip Stick on the top of hydraulic oil tank.

Inspect all Log Splitter Components.

If you have damaged components: Contact the freight company that delivered the log splitter and file a claim.

Read and follow all instructions for assembly and operation. Failure to properly assemble this equipment could result in serious injury to the user or bystanders, or cause equipment damage.

Assembly Instructions

30 TON LOG SPLITTER ASSEMBLY

Set the shipping crate on a solid flat surface and carefully remove the lid. Use two people and take all parts out of the shipping crate and inspect the components to ensure there are no missing pieces before starting to assemble the log splitter follow steps 1 through 8.

TOOLS REQUIRED

- Rubber or Wooden Hammer
- 10mm,13mm,14mm, 16mm, 17mm, 18mm, 19mm, 27mm Wrenches
- Large Adjustable Wrench
- Phillips or Standard Screwdriver
- Pliers

STEP 1: Wheel Assembly

1. Attach the Wheels (#72) to the Oil Tank Axle Secure using Flat Washer (#73), Nut (#74), Pin (#75), and Axel Cap (#76).

Note: Use a black plastic bushing to fix the axel cap like below picture. Please cover the black bushing onto the axel cap, and use rubber/wooden hammer knocking the end of the plastic bushing and make the axel cap fixed on wheel.



STEP 2: Attach Tow Bar to the Oil Tank

1. Attach Tow bar (#54) to the Oil tank (#71) and Secure using Four Sets of M12x40 Hex Bolts (#83), Flat Washer M12 (#15), Lock Washer M12 (#16) and Lock Nut M12 (#11).

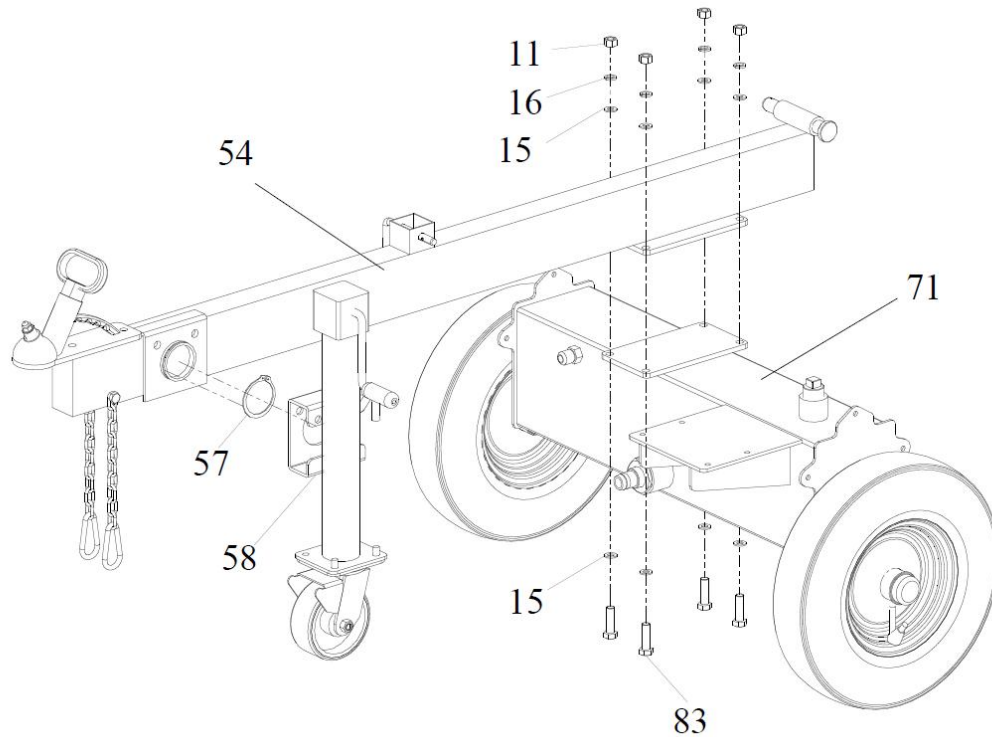

STEP 3: Attach the Beam Assembly to the Tow Bar

1. Attach the Beam (#43) to the Tow Bar (#54), using a Hinge Pin (#81) and secure with Cotter Pin (#84).

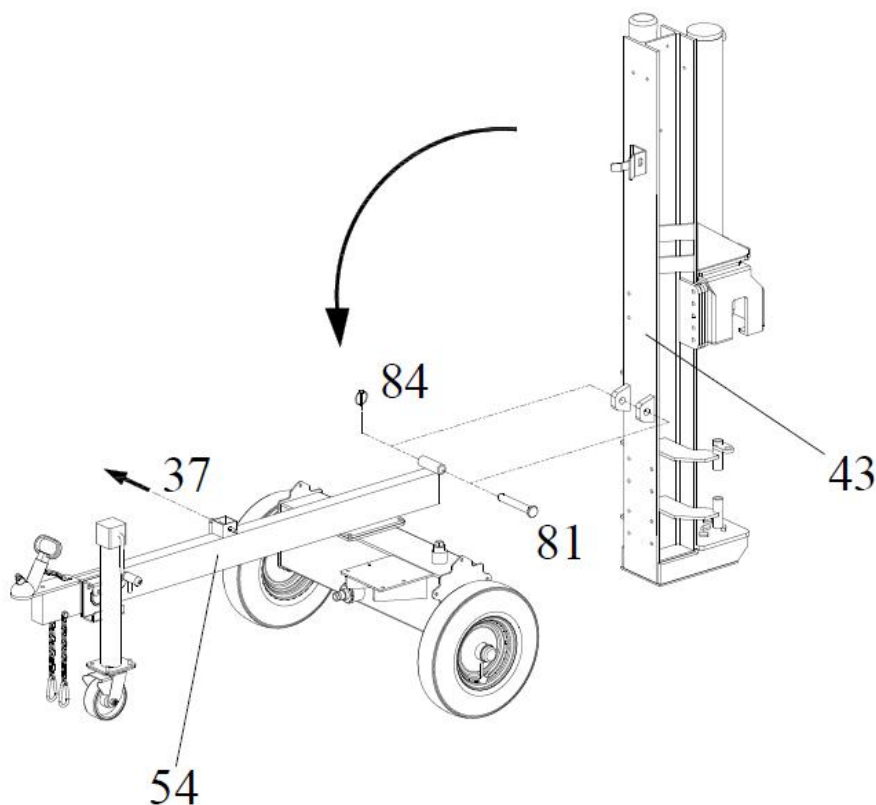

STEP 4: Attach the Rear Support Leg

1. Attach the Rear Support Leg (#99) to the Support Leg Holder (#104), by using Hex Bolt M10X80 (#100), Pin (#101), Flat Washer M10 (#21), Lock Washer M10 (#20) and Nut M10 (#47).
2. Attach the Support Leg Holder (#104) to the Beam (#43), by using Hex Bolt M10X35 (#91), Lock Washer M10 (#20) and Nut M10 (#47).

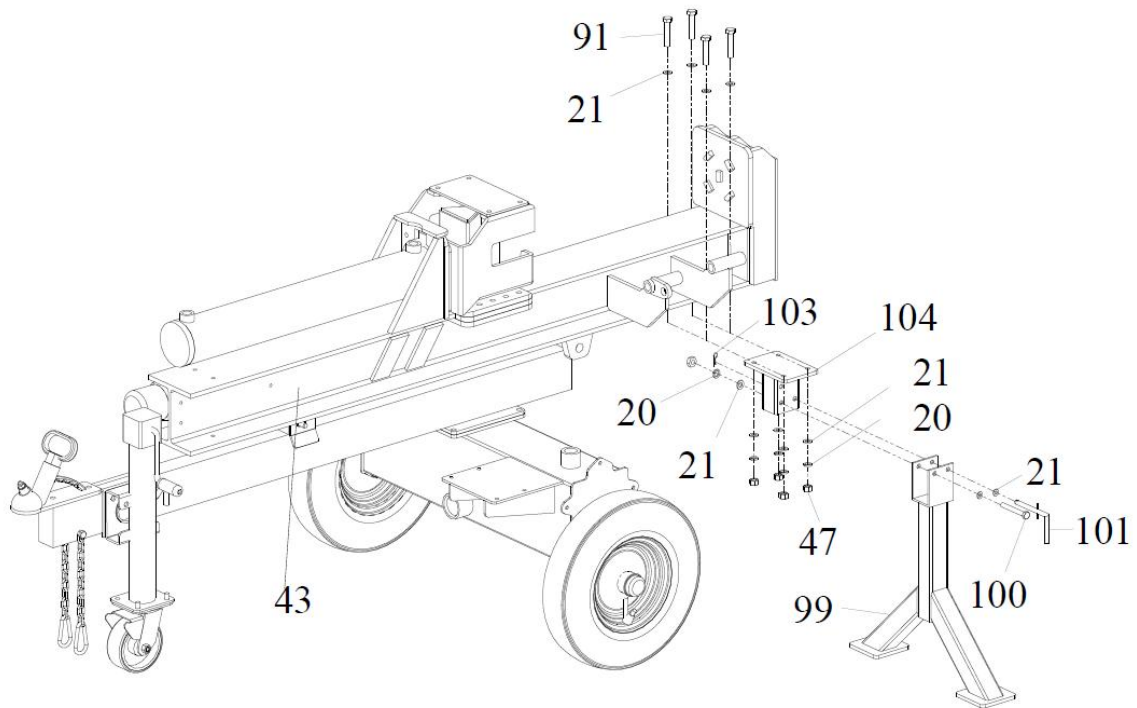

STEP 5: Attach the Wheel Fenders

1. Attach the Wheel Fenders (#79, #80) to the Oil Tank (#71), using Nut M8 (#34), Lock Washer M8 (#51), Flat Washer M8 (#50), and Hex Bolt M8x25 (#78).

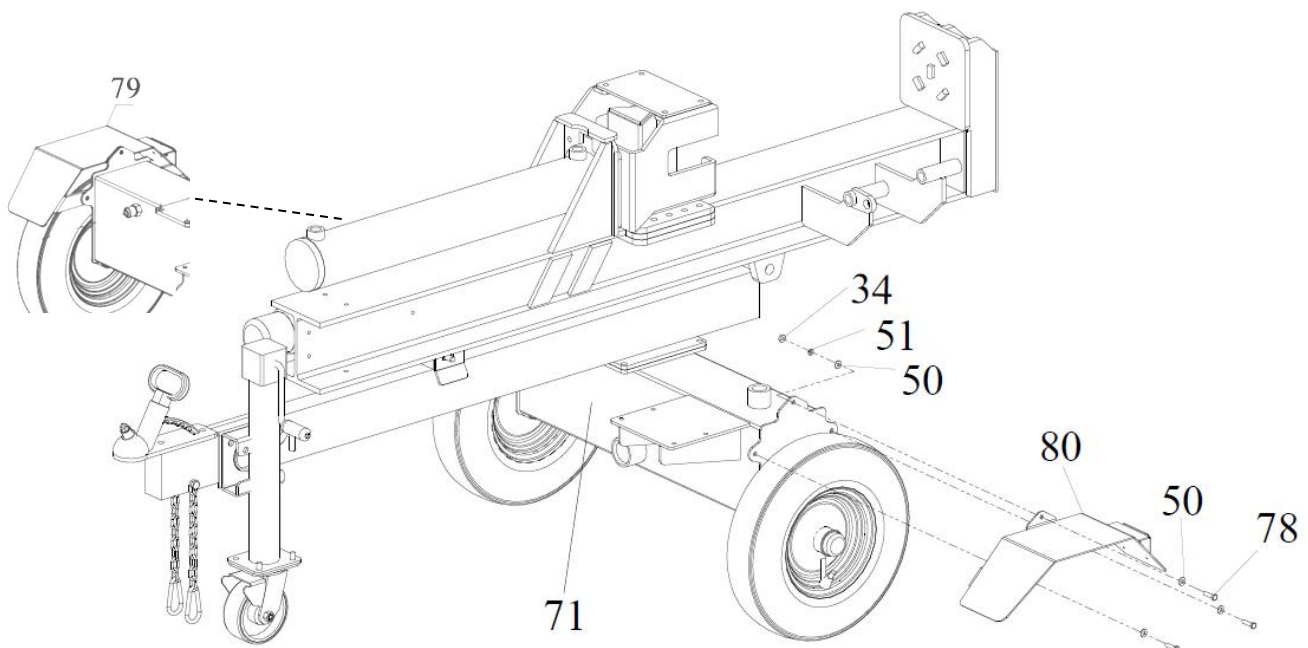

STEP 6: Attach the Engine

1. Attach the Engine (#116) to the Oil Tank (#71), using Hex Bolt M8x60 (#117), Flat Washer M8 (#50), Lock Washer M8 (#51), M8 Nut (#34).
2. Place the Anti Vibration Pad (#118), and Big Flat Washer M8 (#119) between the Engine and Mounting Plate.

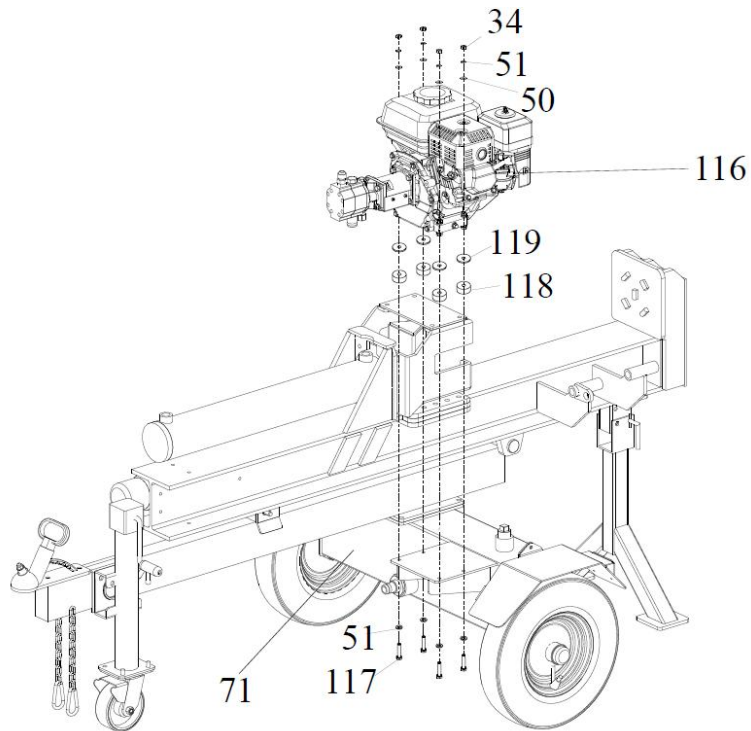

STEP 7: Attach the Log Cradle

1. Attach the Log Cradle, using Hex Bolt (#49), Lock Washer M10 (#20), Flat Washer M10 (#21), Nut M10 (#47).

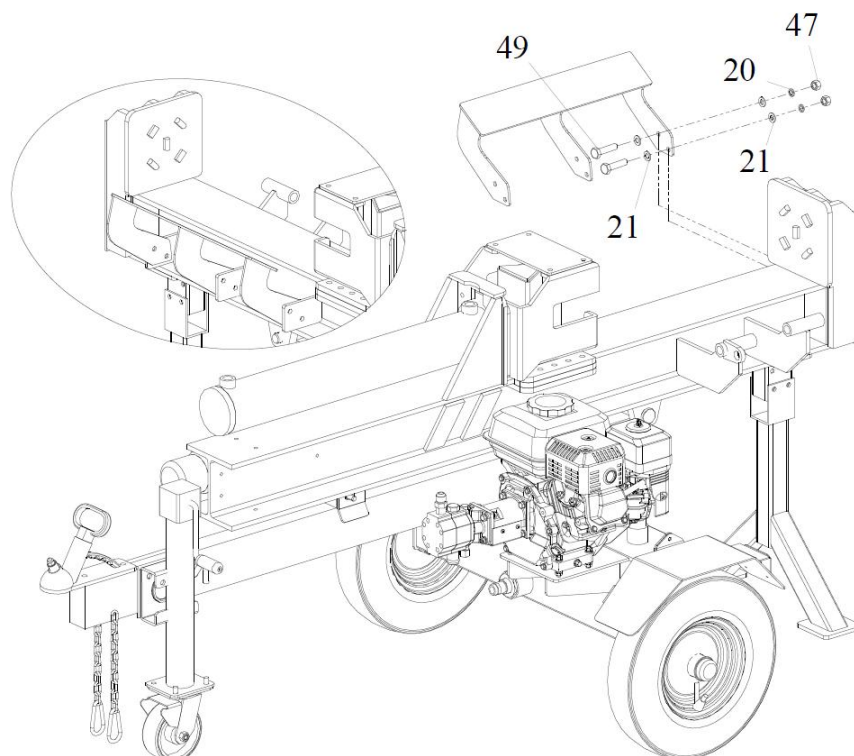

STEP 8: Attach the Lifter Cylinder Holder and Lifter Cylinder

1. Attached the Lifter Cylinder Bracket (#92), using Hex Bolt M10x35 (#26), Flat Washer M10 (#21), Lock Washer M10 (#20), Nut M10 (#47).
2. Fix it, using Lifter Cylinder Support Ring (#93), Hex Bolt M8x16 (#89), Flat Washer M8 (#50), Lock Washer M8 (#51).

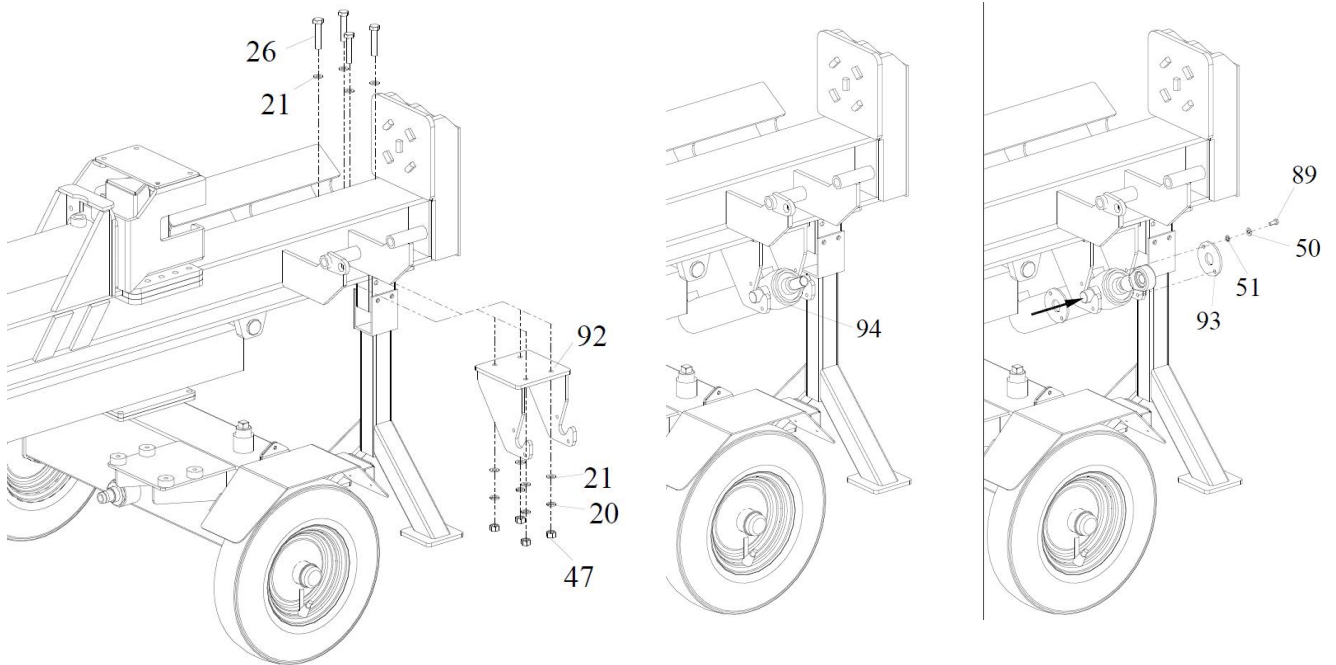

STEP 9: Attach the Lifting Table

1. Attach the Lifting Table (#98), using Lifter Pin (#97), Lifter Cylinder Holder (#96), Hex Bolt M6x16 (#85), Flat Washer-Big M6 (#82), R pin (#102), Lifter Safety Pin (#103).

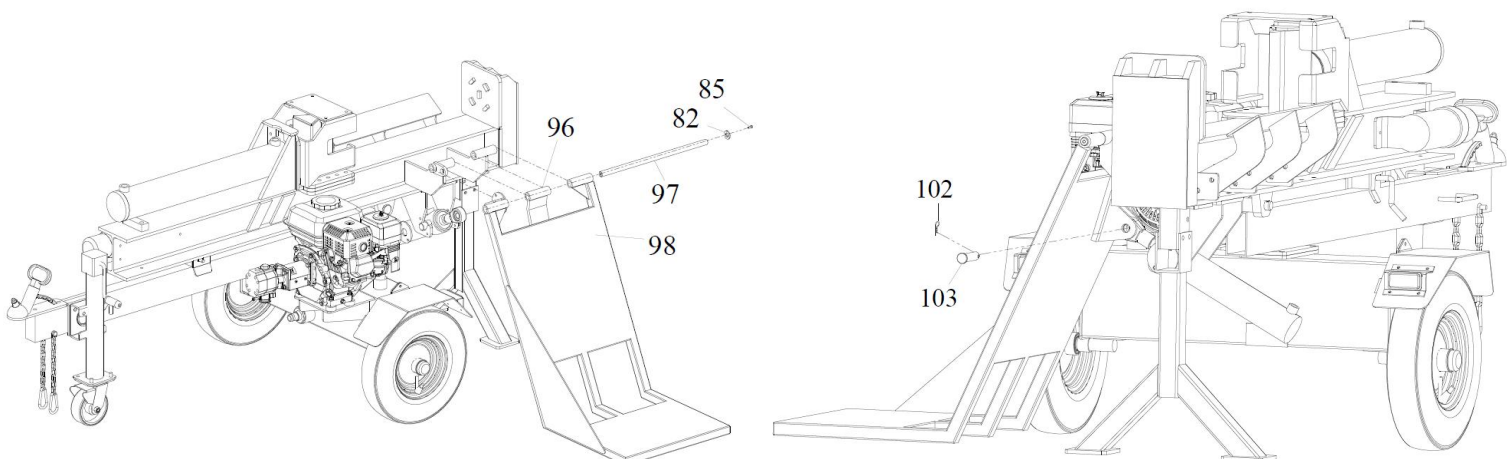

STEP 10: Attach the Lifter Control Valve and Hydraulic Hose

1. Attach the Lifter Control Valve (#27) to the Beam (#43), using Hex Bolt M8x40 (#24), Hex Bolt M10x35 (#91), Flat Washer M10 (#21), Lock Washer M10 (#20), Nut M10 (#47), Flat Washer M8 (#50), Lock Washer M8 (#51), Nut M8 (#34).

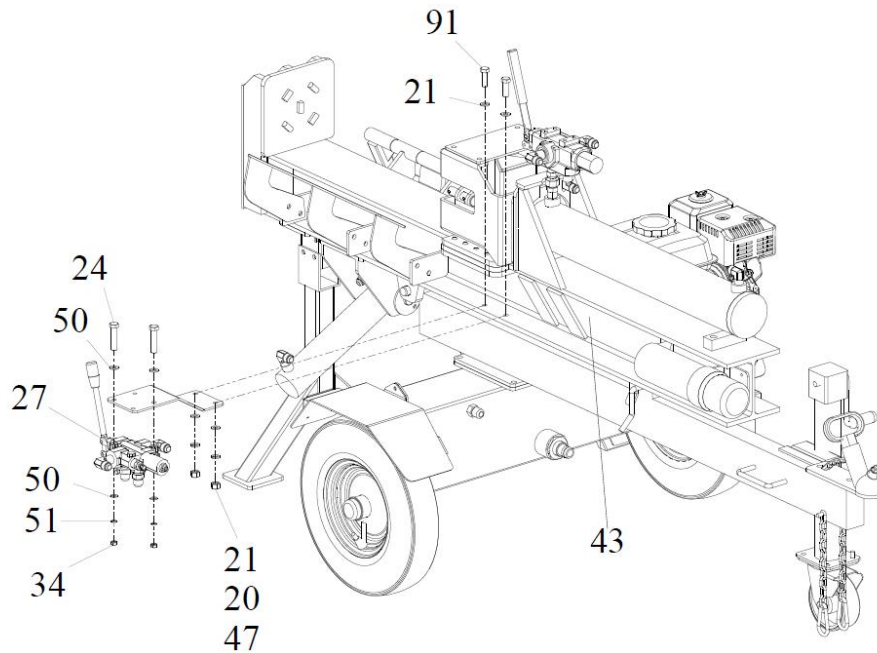

STEP 11: Attach the Hydraulic Oil Hose

1. Attach the Hoses to the locations corresponding to each alphabet letter, eg attach Hose A to Location A on the diagram.

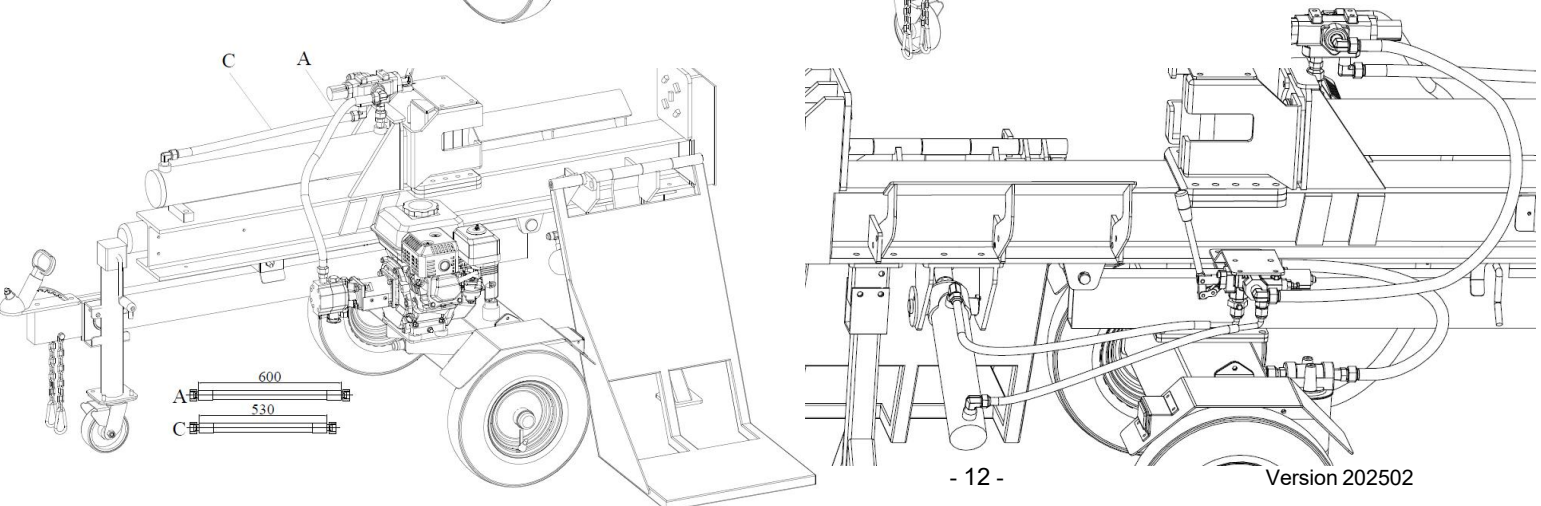
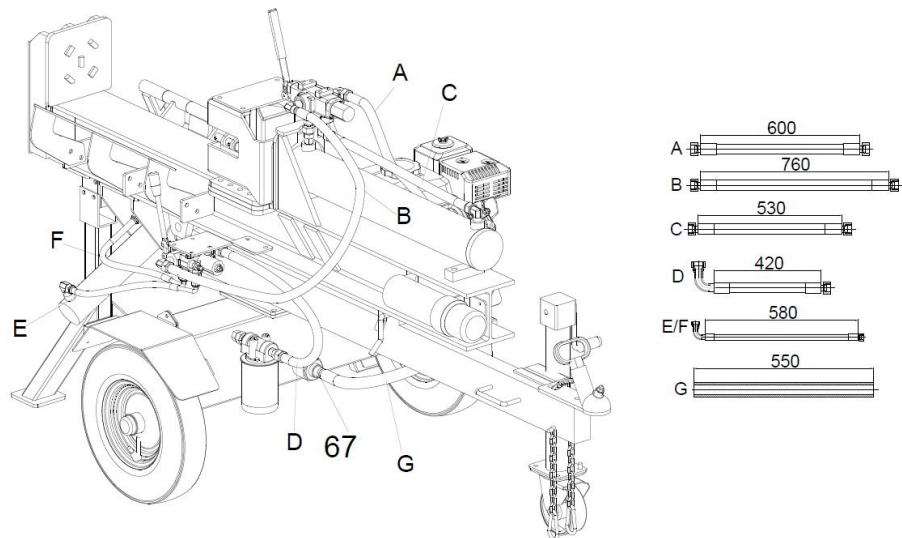

STEP 12: Add Engine Oil

1. Make sure the log splitter is on a level surface.
2. Unscrew the oil fill cap/dipstick to add oil.
3. Add 600ml of engine oil (SAE30 or 10W30, depending on your model). Refer to owner's engine manual for more details. Replace the oil fill cap/dipstick.
4. Check engine oil level each use and add as needed.

NOTE: During the break-in period check the engine oil level more often.

CAUTION

DO NOT attempt to crank or start the engine before it has been properly filled with the recommended type and amount of oil. Damage to the log splitter as a result of failure to follow these instructions will void your warranty.

STEP 13: Add Fuel to the Engine

1. Use only clean, fresh, regular unleaded 91 fuel.
2. DO NOT mix oil with fuel.
3. Remove the fuel cap and slowly add fuel to the tank. DO NOT overfill, allow approximately ¼ inch of space for fuel expansion.
4. Screw on the fuel cap and wipe away any spilled fuel.

DANGER

Log splitter engine exhaust contains carbon monoxide, a colourless, odourless, poison gas. Breathing carbon monoxide will cause nausea, dizziness, fainting or death. If you start to feel dizzy or weak, get to fresh air immediately.

Operate log splitter outdoors only in a well ventilated area.

DO NOT operate the log splitter inside any building, enclosure or compartment.

DO NOT allow exhaust fumes to enter a confined area through windows, doors, vents or other openings.

DANGER: CARBON MONOXIDE, using a log splitter indoors **CAN KILL YOU IN MINUTES.**

CAUTION

Fuel and fuel vapors are highly flammable and extremely explosive.

Fire or explosion can cause severe burns or death.

Unintentional startup can result in entanglement, traumatic amputation or laceration.

Only use regular unleaded 91 fuel.

DO NOT mix oil and petrol together.

Fill tank approximately ¼" below the top of the tank to allow for fuel expansion.

DO NOT fill fuel tank indoors or when the engine is running or hot.

DO NOT light cigarettes or smoke when filling the fuel tank.

STEP 14: Add Hydraulic Oil

1. The log splitter needs to be on a flat, level surface before adding the hydraulic oil.
2. Remove the oil cap from the hydraulic oil tank.
3. Add 18 liters of AW32/AW46 hydraulic oil.
4. Check the hydraulic oil level.
5. Start engine and use the control lever to extend and retract wedge several times to remove air from the lines.
6. With the wedge retracted, check hydraulic oil level again and fill if necessary.

WARNING

DO NOT remove the hydraulic oil fill cap when the engine is running or hot. Hot oil can escape causing severe burns. Always allow the log splitter to cool completely before removing the hydraulic oil cap.

High fluid pressure and temperatures are created in the hydraulic log splitters. Hydraulic fluid will escape through a pin-size hole opening and can puncture skin and cause severe blood poisoning.

Inspect hydraulic system regularly for possible leaks. **Never check for leaks with your hand while the system is pressurized. Seek medical attention immediately if injured by escaping fluid.**

Make sure all fittings are tight and secure before applying pressure. Relieve system pressure before servicing.

Make sure the hydraulic hoses do not touch any hot surfaces or cutting areas.

Hoses need to be positioned where they are clear from the engine and cutting wedge. To avoid serious bodily injury always inspect the hoses before operating the log splitter.

Operating Instructions

! WARNING

Before operating or using the log splitter, review the instructions below and all safety information. Failure to follow these instructions may result in property damage or injury to the operator or bystanders

! WARNING

ALWAYS use the log splitter for its intended use.
ONLY use the log splitter to split wood logs, length wise with the grain.
NEVER modify, alter or change the log splitter in anyway, modifications will void the warranty.
NEVER attach a rope, cable or other device to the control lever on the log splitter.
ONLY operate the log splitter in daylight.
NEVER leave the log splitter unattended while the engine is running.
DO NOT change the splitting position with the engine running. Contact with the muffler can cause serious burns.
ALWAYS make sure the beam is in the locked position.
DO NOT let the beam drop as it could crush fingers or cause damage to the log splitter.
NEVER operate or let anyone else operate, the log splitter while under the influence of alcohol, drugs, or medication.

USING YOUR LOG SPLITTER

1. DO NOT at any time carry passengers, sit or stand on the log splitter.
2. Check the hydraulic oil level and visually inspect all hoses and attachments for problems.
3. Inspect the engine and make sure the engine oil level is correct.
4. Before towing the log splitter the tyres need to be fully inflated.

! TYRE WARNING

DO NOT over inflate tyres. Serious injury can result if tyres explode.
DO NOT tow the log splitter if the tyres are worn or will not hold air.
DO NOT exceed the maximum 72 KM/H towing speed.

5. Refer to the vehicle owner's manual for proper safety and towing instructions.

! TOWING WARNING

Serious injury or death can occur if towing safety rules are not followed.
Always use safety chains, secure and lock the log splitter to the vehicle hitch before moving.
Drive safely. Be aware of the added length of the log splitter.
Never exceed the maximum travel speed of 72 KM/H.
Never ride or transport cargo on the log splitter.
Turn off the vehicle before leaving the log splitter unattended.
Block the log splitter wheels to prevent unintended movement.

6. The log splitter must have at least 2 meters of clearance from combustible material. It needs to be on a dry and level surface with good footing. Do not work on mud, ice, brush or snow.
When using the log splitter the work zone must be maintained at all times.

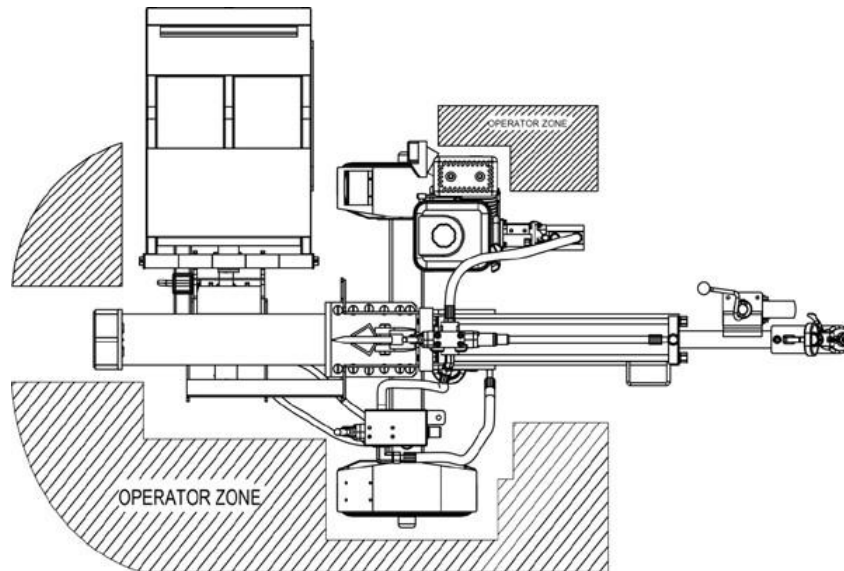

NOTE: Serious accidents can happen when other people are allowed inside the work zone. Keep everyone else outside the work zone while operating the control lever.

7. Always wear safety gear, eye protection, gloves and work boots when operating the log splitter.
8. Start the engine and make sure the log splitter is on level ground before operating.

NOTE: The hydraulic oil needs to be above -12C° before starting the engine. Cold hydraulic oil can damage the hydraulic pump. If outdoor air temperature is below 0C° allow the log splitter to warm up by extending and returning the wedge several times before splitting wood.

9. Put the support leg in the down position and jockey wheel with brake on to prevent the log splitter from moving during operation and block both tyres.
10. Set the log splitter in the horizontal position.
11. Load a log onto the beam against the endplate (Max Log Length-24").

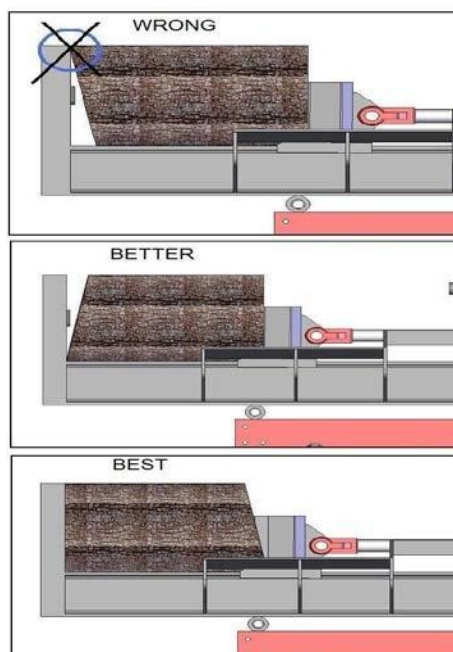

12. Make sure hands are clear from the wedge and crush hazard areas.

CRUSH WARNING

Wedge can cut through skin and break bones. Keep both hands away from wedge and beam slide. Serious accidents can happen when other people are allowed inside the work zone. Keep everyone else out of the work zone while operating control lever.
DO NOT wear loose clothing. It can get tangled in moving parts of log splitter.
Only use the log splitter in daylight so you can see what you are doing.

13. Push control lever FORWARD by one hand to split the log.

14. Push control lever BACKWARD by one hand to return wedge to its original position.

CAUTION

If a log gets stuck, embedded or will not split completely, push the control lever in the reverse direction and allow the splitter to strip the log from the wedge.

If the log still remains stuck, embedded or will not split, turn the machine off and use a sledge hammer and crow bar to remove the log.

ALWAYS keep hands clear of the log and wedge while it is retracting.

15. Always keep work zone clean and free of split wood and debris.

Operating Instructions

HORIZONTAL WORKING POSITION ONLY

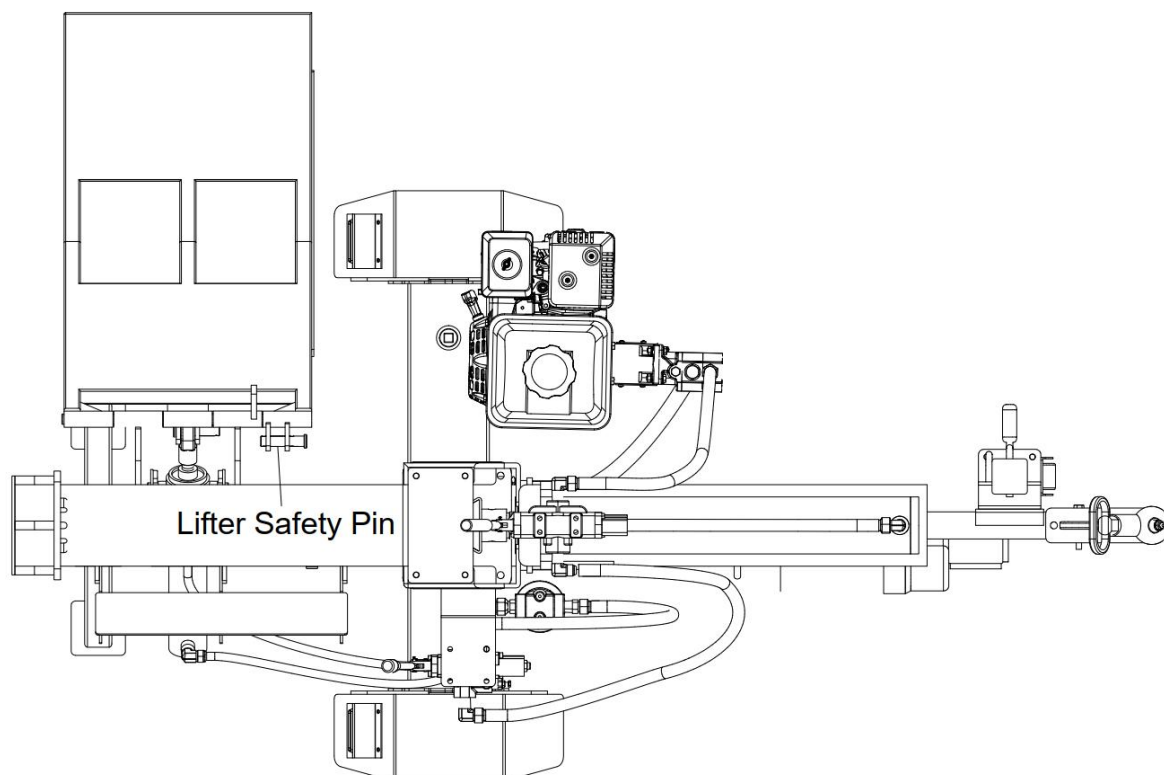

FOR VEHICLE TOWING

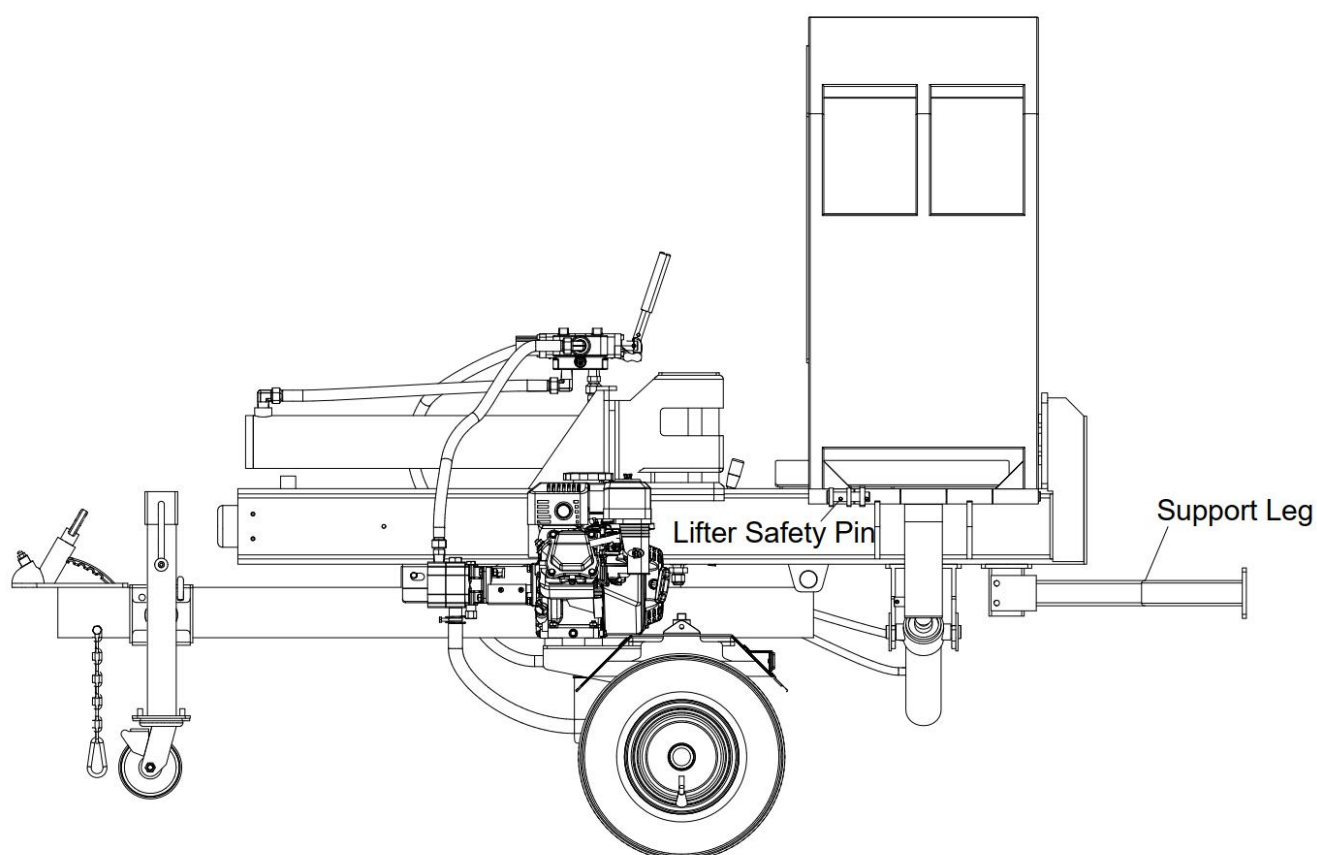

Maintenance and Storage

CAUTION

Improper maintenance and storage of the log splitter may void your warranty.

MAINTENANCE

- Before performing any maintenance, the log splitter must be placed in maintenance mode. Turn off the engine and move the control lever forward and backwards to relieve the hydraulic pressure.
- After performing any maintenance, make sure all guards, shields and safety features are put back in place before operating the log splitter.
- Before operating make sure the tyres have the RECOMMENDED TYRE PRESSURE.
- Regularly grease axle and wheel bearing area or when needed.
- Periodically check all fasteners and hoses for tightness and leaks.
- Annually clean and lightly lubricate all moving parts or when needed.
- Use a glossy enamel spray paint to touch up scratched or worn painted metal surfaces.
- Never exceed load capacity rating of 30 tons it will damage the log splitter.

What	When	How
Hoses	Each Use	Inspect hoses for exposed wire mesh and leaks. Replace all worn or damaged hoses before starting the engine.
Hydraulic Fittings	Each Use	Inspect fittings for cracks and leaks. Replace all damaged fittings before starting the engine.
Nuts and Bolts	Each Use	Check for loose bolts, tighten before operating.
Beam	Each Use	Apply grease to beam surface.
Moving Parts	Each Use	Clear debris from log splitter.

Refer to the Engine Owner's Manual for engine maintenance.

IMPORTANT:

If a part needs replacement, only use parts that meet the manufacturer's specifications. Replacement parts that do not meet specifications may result in a safety hazard or poor operations.

STORAGE

- Before storing make sure the log splitter is clean and dry for years of trouble-free service.
- Lightly lubricate all log splitter surfaces and moving parts to prevent rust.
- Store indoors or protected area during severe weather and winter months.

Troubleshooting

Problem	
Cylinder rod will not move	SOLUTION: A, D, E, H, J
Slow cylinder rod speed when extending or retracting	SOLUTION: A, B, C, H, I, K, L
Wood will not split or splits extremely slowly	SOLUTION: A, B, C, F, I, K
Engine bogs down during splitting	SOLUTION: G, L
Engine stalls under low load condition	SOLUTION: D, E, L, M
Engine starts problem	SOLUTION: N
Cause	Solution
A -Insufficient oil to pump	Check oil level in reservoir
B -Air in oil	Check oil level in reservoir
C -Excessive pump inlet vacuum	Check pump inlet hose for blockage or kinks
D -Blocked hydraulic lines	Flush and clean the splitter hydraulic system
E -Blocked control valve	Flush and clean the splitter hydraulic system
F -Low control valve setting	Adjust control valve with a pressure gauge
G -High control valve setting	Adjust control valve with a pressure gauge
H -Damaged control valve	Return control valve for authorized repair
I -Internal control valve leak	Return control valve for authorized repair
J -Internal cylinder leak	Return cylinder for authorized repair
K -Internally damaged cylinder	Return cylinder for authorized repair
L -Engine Control out of adjustment	Adjust idle control nuts
M -Engine is loaded during idle down mode	Use shorter log length (24" or less) to allow engine to speed up before contact.
N -Engine operation	Refer to the Engine Owner's Manual

Specifications

Ram Force.....	30 Ton
Cycle Time.....	16 Sec
Wedge Size.....	8” Hardened Steel
Hydraulic Tank Capacity.....	22L
Max. Log Length.....	24” (610mm)
Gear Pump.....	.. 2-Stage
Hydraulic Oil.....	AW32/AW46 Hydraulic Oil
Hydraulic Cylinder.....	4 1/2” x 23.6”(115mm x 600mm)
Max. Pressure	3200 PSI
Max. Flow.....	15 GPM
Wheel Size	16” / 4.80 x 8
Hitch Type.....	2” Ball Coupler
Max. Towing Speed.....	72 KM/H
Engine.....	HONDA GX200, Briggs & Stratton 6.5HP or Loncin 6 HP

NOTE: For Engine Details Refer to the Engine Owner’s Manual.

Warranty

Limited Warranty

The warranty period for the log splitter is 3 years (Domestic use) and 1 year (Commercial use) from the purchase date. The engine has a 3 years warranty for Honda and Briggs & Stratton models, and a 2 years warranty for the Loncin model. The warranty will not apply to any unit which was not assembled correctly, misused, overloaded or which has been used or operated contrary to our instructions, or which has been repaired or altered by anyone other than an authorized representative.

Warranty Exclusions

Warranty will not cover:

- Pieces worn out due to normal wear and tear.
- Misuse, negligence of care, and lack of maintenance.
- Failures due to using non genuine replacement parts.

Warranty will be voided if the machine has been modified in any way.

Parts Illustration List

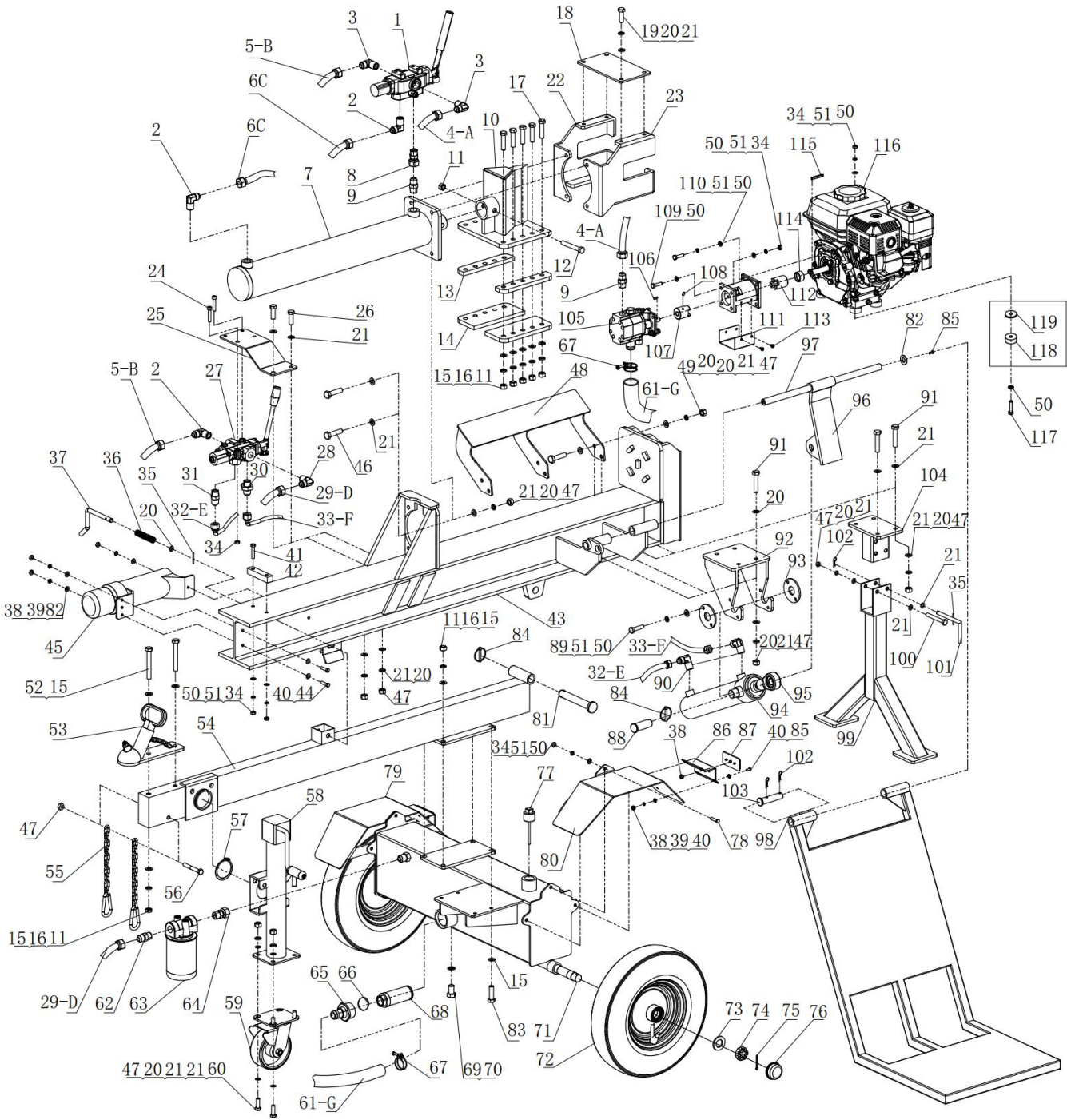

Parts Illustration List

Ref #	Part No.	Description	Qty
1	BWMLSD3025001	Control Valve	1
2	BWMLSD3025002	1/2-1/2D Connector	3
3	BWMLSD3025003	3/4-1/2D Connector	2
4	BWMLSD3025004	Hydraulic Oil Hose A	1
5	BWMLSD3025005	Hydraulic Oil Hose B	1
6	BWMLSD3025006	Hydraulic Oil Hose C	1
7	BWMLSD3025007	Cylinder	1
8	BWMLSD3025008	1/2-1/2C Connector	1
9	BWMLSD3025009	1/2-1/2D Connector	2
10	BWMLSD3025010	Wedge	1
11	BWMLSD3025011	Nut M12	17
12	BWMLSD3025012	Hex Bolt M12X75	1
13	BWMLSD3025013	Keeper Spacer	2
14	BWMLSD3025014	Lower Keeper Plate	2
15	BWMLSD3025015	Flat Washer M12	22
16	BWMLSD3025016	Lock Washer M12	16
17	BWMLSD3025017	Hex Bolt M12X55	10
18	BWMLSD3025018	Log Stripper Plate	1
19	BWMLSD3025019	Hex Bolt M10X20	4
20	BWMLSD3025020	Lock Washer M10	34
21	BWMLSD3025021	Flat Washer M10	55
22	BWMLSD3025022	Log Stripper(Left)	1
23	BWMLSD3025023	Log Stripper (Right)	1
24	BWMLSD3025024	Hex Bolt M8X40	2
25	BWMLSD3025025	Lifter Control Valve Plate	1
26	BWMLSD3025026	Hex Bolt M10X35	2
27	BWMLSD3025027	Lifter Control Valve	1
28	BWMLSD3025028	1/2-M22X1.5D Connector	1
29	BWMLSD3025029	Oil Return Hose D	1
30	BWMLSD3025030	Flow Valve	1
31	BWMLSD3025031	1/2-1/4D Connector	1
32	BWMLSD3025032	Hydraulic Oil Hose E	1
33	BWMLSD3025033	Hydraulic Oil Hose F	1
34	BWMLSD3025034	Nut M8	18
35	BWMLSD3025035	Pin Ø3	2
36	BWMLSD3025036	Spring Ø12	1
37	BWMLSD3025037	Lock Pin	1
38	BWMLSD3025038	Nut M6	13
39	BWMLSD3025039	Lock Washer M6	11

40	BWMLSD3025040	Flat Washer M6	19
41	BWMLSD3025041	Hex Socket Bolt M8X40	2
42	BWMLSD3025042	Cylinder Pad	1
43	BWMLSD3025043	Beam	1
44	BWMLSD3025044	Hex Bolt M6X25	3
45	BWMLSD3025045	Manual Canister	1
46	BWMLSD3025046	Hex Socket Bolt M10X45	4
47	BWMLSD3025047	Nut M10	26
48	BWMLSD3025048	Log Cradle	1
49	BWMLSD3025049	Hex Bolt M10X30	6
50	BWMLSD3025050	Flat Washer M8	38
51	BWMLSD3025051	Lock Washer M8	24
52	BWMLSD3025052	Hex Bolt M12X130	2
53	BWMLSD3025053	Hitch Coupler	1
54	BWMLSD3025054	Tow Bar	1
55	BWMLSD3025055	Chain	2
56	BWMLSD3025056	Hex Bolt M10X75	1
57	BWMLSD3025057	Jockey Wheel Circlip	1
58	BWMLSD3025058	Front Support Leg	1
59	BWMLSD3025059	8" Jockey Wheel	1
60	BWMLSD3025060	Hex Bolt M10X25	4
61	BWMLSD3025061	Suction Hose G	1
62	BWMLSD3025062	1/2-M22X1.5D Connector	1
63	BWMLSD3025063	Oil Filter	1
64	BWMLSD3025064	3/4-M22X1.5C Connector	1
65	BWMLSD3025065	Oil Outlet Joint	1
66	BWMLSD3025066	Oil Outlet Joint Seal	1
67	BWMLSD3025067	Hose Clamp	2
68	BWMLSD3025068	Filter Elements	1
69	BWMLSD3025069	Oil Drain Bolt	1
70	BWMLSD3025070	Oil Drain Bolt Gasket	1
71	BWMLSD3025071	Oil Tank	1
72	BWMLSD3025072	Wheel	2
73	BWMLSD3025073	Flat Washer Ø24	2
74	BWMLSD3025074	Nut M24X2	2
75	BWMLSD3025075	Pin Ø4X36	2
76	BWMLSD3025076	Axel Cap	2
77	BWMLSD3025077	Oil Dipstick	1
78	BWMLSD3025078	Hex Bolt M8X25	6
79	BWMLSD3025079	Left Fender	1
80	BWMLSD3025080	Right Fender	1
81	BWMLSD3025081	Hitch Pin	1
82	BWMLSD3025082	Big Flat Washer M6	5
83	BWMLSD3025083	Hex Bolt M12X40	4
84	BWMLSD3025084	Ring Pin	2

85	BWMLSD3025085	Hex Bolt M6X16	10
86	BWMLSD3025086	Tail Light Holder	2
87	BWMLSD3025087	Tail Light	2
88	BWMLSD3025088	Lifter Cylinder Pin	1
89	BWMLSD3025089	Hex Bolt M8X16	4
90	BWMLSD3025090	3/8-1/4D Connector	2
91	BWMLSD3025091	Hex Bolt M10X35	8
92	BWMLSD3025092	Lifter Cylinder Bracket	1
93	BWMLSD3025093	Lifter Cylinder Support Ring	2
94	BWMLSD3025094	Lifter Cylinder	1
95	BWMLSD3025095	Lifter Cylinder Ear Ring	1
96	BWMLSD3025096	Lifter Cylinder Top Plate	1
97	BWMLSD3025097	Lifter Pin	1
98	BWMLSD3025098	Lifting Table	1
99	BWMLSD3025099	Rear Support Leg	1
100	BWMLSD3025100	Hex Bolt M10X80	1
101	BWMLSD3025101	Rear Support Leg Pin	1
102	BWMLSD3025102	R Pin	3
103	BWMLSD3025103	Lifter Safety Pin	1
104	BWMLSD3025104	Support Leg Holder	1
105	BWMLSD3025105	Pump	1
106	BWMLSD3025106	Pump Key	1
107	BWMLSD3025107	Pump Coupler	1
108	BWMLSD3025108	Hex Socket Bolt M6X10	1
109	BWMLSD3025109	Hex Bolt M8X30	4
110	BWMLSD3025110	Hex Bolt 5/16-24x1	4
111	BWMLSD3025111	Pump Coupling Cover	1
112	BWMLSD3025112	Engine Coupler	1
113	BWMLSD3025113	Bolt M5X8	4
114	BWMLSD3025114	Engine Bushing	1
115	BWMLSD3025115	Engine Bushing Key	1
116	BWMLSD3025116	Engine	1
117	BWMLSD3025117	Hex Bolt M8X60	4
118	BWMLSD3025118	Anti Vibration Pad	4
119	BWMLSD3025119	Big Flat Washer M8	4

Customer Service:

303 Warrigal Road, Cheltenham, Victoria 3192, Australia

Telephone: 13000 454 585

Website: www.BWMachinery.com.au

Email: admin@bwmachinery.com.au

Spare parts are available from our dealers and our official website