

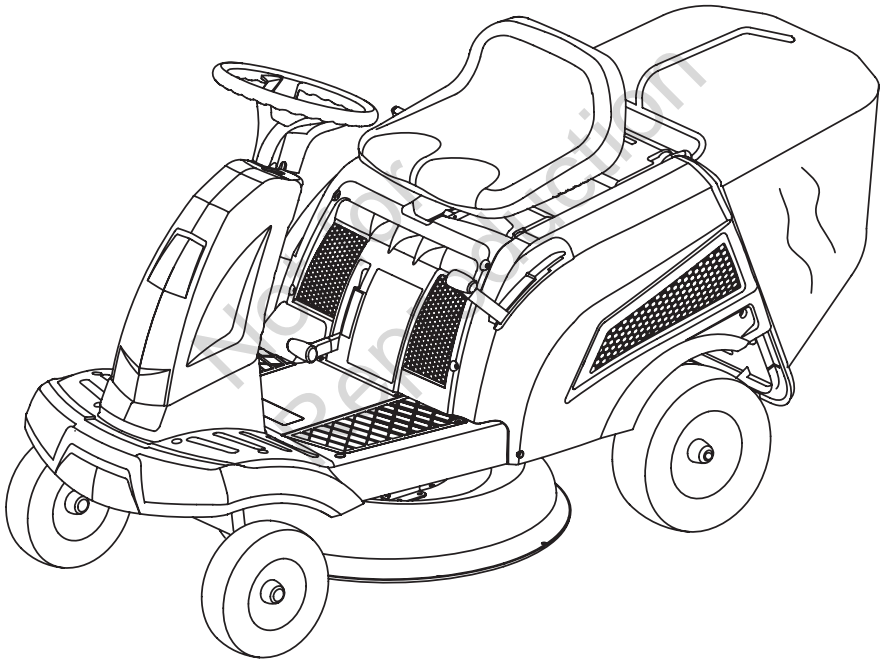

OPERATOR MANUAL

RIDE - ON LAWNMOWER

2691868, 2691869, 2691873
2691969, 2691970, 2691971



WARNING! Read this manual before operating your product.



INTRODUCTION

Dear Customer,

Thank you for choosing a Victa Ride-on lawnmower.

This manual describes and illustrates the safety, assembly, operation and maintenance instructions to be followed to ensure the safe and efficient operation of the machine.

Please remember that this manual is an integral part of the machine; look after it and keep it handy for future reference; In the event the machine is sold, this user manual must be provided to the new owner.

If your ride-on lawnmower needs assistance or repair, please contact your local Victa authorised service centre. Visit victa.com.au to find your closest Victa authorised service centre.

IMPORTANT

The ride-on lawnmower must always be used with utmost caution. To ensure safety precautions and operating instructions are readily on hand, labels with pictographs have been affixed to your ride-on lawnmower. As these labels are applicable to safety standards, they are considered an integral part of the machine. Therefore the user is responsible for replacing them in the event they become detached or illegible are considered an integral part of the machine, the user is therefore responsible for replacing them in the event of their become detached or illegible.

For any replacement, contact your authorised Victa service centre.

Not for
Reproduction



Label Position	3
----------------	---



Definitions of Symbols	5
------------------------	---



Safety Precautions	6
--------------------	---

- Get to know the machine
- General Rules
- Training
- Preparation
- Rules for correct operation
- Maintenance
- Machine Safety
- Intended Use



Machine Assembly	12
------------------	----

- Machine Parts
- Identification of Main Machine Parts and Controls
- Machine Assembly



Preparation	22
-------------	----

- Checking and Filling Oil
- Tyre Pressure



Operations	25
------------	----

- Controls and Start-up
- Preparing for Start-up
- Driving and Cutting
- Transport



Maintenance	32
-------------	----

- Cleaning the Machine
- Blade Replacement



Trouble Shooting	38
------------------	----



Technical Specification	41
-------------------------	----



Notes	42
-------	----



LABEL POSITION

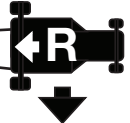
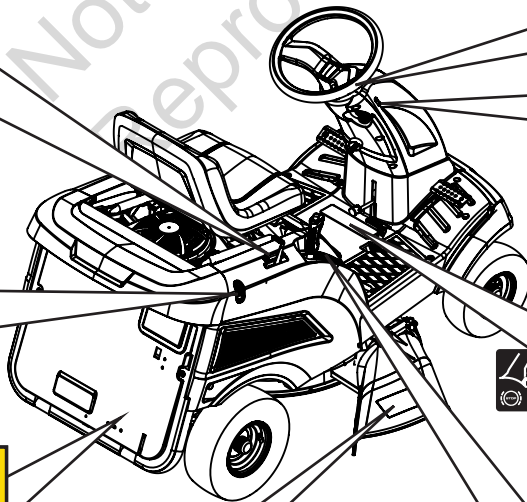
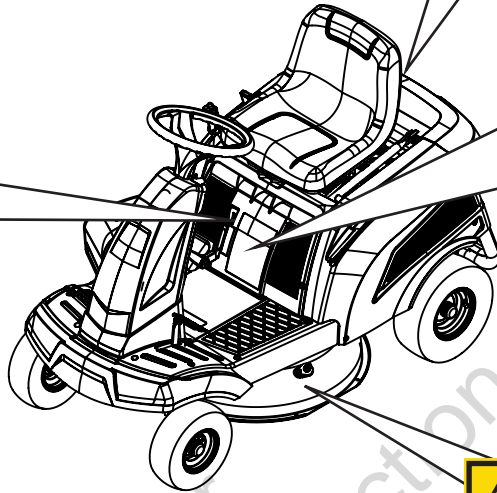
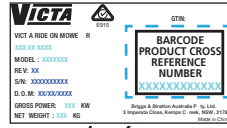

Hydrostatic drive model



LABEL POSITION



Gear drive model

VICTA  

VICTA RIDE ON MOWER R
 1000 50 5000
 MODEL : XXXXXXXX
 REV. XX
 S/N: XXXXXXXXXX
 D.O.M. XXXXXXXXXX
 GROSS POWER: 100 kW
 NET WEIGHT : 1100 kg

STRIP

BARCODE
 PRODUCT CROSS
 REFERENCE
 NUMBER

Victor & Graham Australia P. 10, L.L.C.
 2 Kingsford Drive, Ararat, Vic. 3470, AUSTRALIA
 Made in China

4
3
2
1
N
R

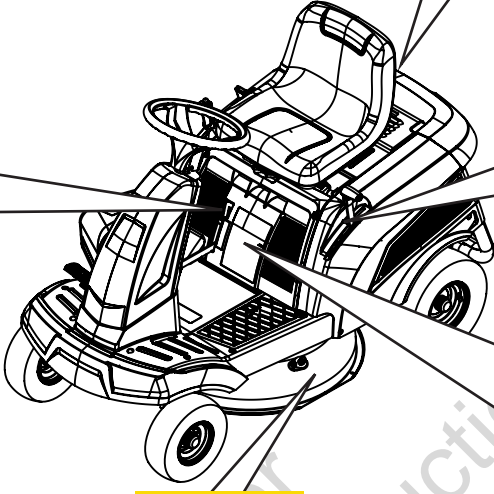

1	2	3	4	A
B				B

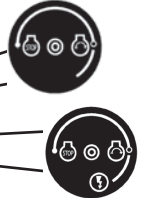
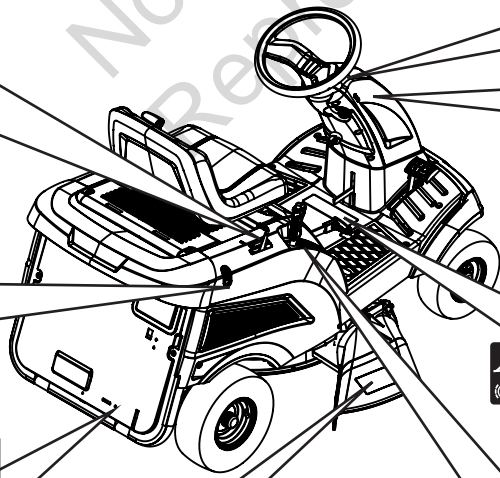

1 2 3 4

DEFINITIONS OF SYMBOLS

Your machine must be used with care. This is why labels with illustrations have been placed on the machine, to remind you of the main precautions to take during use.

These labels are to be considered an integral part of the machine.

Should a label come off or become illegible, contact your authorised Victa service centre to replace it. Their meaning is explained below:



Warning



Warning: Read the operating and service instruction manual carefully.



Danger! Ejected objects: Keep bystanders away.



Warning: Disconnect the ignition key and read the instructions before carrying out any repair or maintenance work.



Hazard: The blades are sharp; risk of serious injury. Before carrying out any inspection, cleaning and repair operations on the cutting parts, stop the engine and take out the ignition key. Now disconnect the spark plug wire and keep the cap away from the plug to prevent accidental starting.



Warning: Keep away from hot surfaces.



Hazard: The blades are sharp; risk of serious injury. Wait for the blade and all the moving parts to come to a halt before touching them. The blade will continue turning for some time after switching off the engine or disabling the blade control.



Warning: Risk of overturning on steep gradients.



Warning: Risk of overturning on steep gradients. Do not use the machine on lawns with gradients of more than 25% (14°). Do not use the machine on lawns with side gradients above 15% (8°).



Get to know the machine



HAZARD! Carefully read this instruction manual completely. Abide by all the “**SAFETY PRECAUTIONS**”, before during and after using the machine.



Keep this manual and all the attachments for any future consultation.

In case of any change in ownership, the manual must be handed over together with the machine.

General Rules



IMPORTANT Anyone using the lawnmower should first of all be acquainted with the instructions in this manual and completely familiar with the controls to ensure correct and safe machine use.

Never allow children under 16 and people not fully acquainted with these instructions to use the lawnmower. Specific national regulations may indicate the minimum operator's age.



Never start and use the lawnmower near other people, especially children or pets.

Keep in mind that the operator or user is liable in the event of accidents or damages occurring to other people or to their property.



HAZARD for people.

- Do not carry passengers.
- Do not carry loads or hook on any type of trailer.
- Such overloads could negatively affect the stability of the machine and overstress the mechanical parts.
- Do not make any changes to the machine.
- Incorrect use of the machine, as indicated in this paragraph, will invalidate the warranty and relieve the manufacturer of any liability in case of any ensuing injuries or damage.



IMPORTANT Users of the lawnmower must be in good psycho-physical shape; do not use the machine when fatigued or under the influence of drink, drugs or medicinal products that reduce promptness of reactions.



SAFETY PRECAUTIONS

Training

The driver must be suitably trained and should focus in particular on:

- Being careful and focus during work;
- The fact that a machine sliding down a gradient cannot be controlled using the brakes. The main causes of losing control of the machine are:
 - Lack of wheel grip;
 - Too much speed;
 - Inadequate braking;
 - Machine not suitable for job to be done
 - Lack of familiarity with effects deriving from terrain conditions, especially on slopes.

Preparation



Carefully inspect the area where you intend to use the lawnmower and remove any objects that could be launched by the machine.

Do not use the equipment if you are wearing loose-fitting clothes that may get caught up.



Always use a hearing protection headset, protective eye wear or a visor.



Do not use the equipment if you are barefoot or wearing sandals.

During work, wear solid shoes with non-slip soles, and protective clothes.



Fire HAZARD. **Petrol is highly inflammable**

Keep the petrol in containers that are specifically designed for the purpose. Only refuel the machine outdoors; do not smoke during refuelling.



Explosion HAZARD.

Refuel the machine before starting the engine. Do not remove the tank cap and do not supply with petrol while the engine is running or hot.



Should the petrol overflow, or spill, do not attempt to start the engine, but move the machine well away from the spot where you spilled the petrol; avoid any cause of sparks or fire until the petrol fumes have completely disappeared. Close the petrol tank and the containers by safely tightening their caps.

Replace the Muffler if it is faulty or damaged.



THROWN OBJECT HAZARD: Before use, always visually check that the blade, the blade fastening screws and the cutting edges are not worn or damaged. Replace any damaged or worn blades, as well as their fastening screws to maintain proper balancing. Repairs and maintenance of mechanical parts must be done by an authorised Victa service centre.

Rules for correct operation



HAZARD! Do not operate the engine in a secluded or restricted area where the dangerous carbon monoxide contained in the exhaust fumes may build up.



Only operate on grounds that are lit by daylight or by adequate artificial lighting.
Before starting the engine, disengage the blade, place in “neutral” (N) or release drive pedal and engage the parking brake.

As far as possible, avoid using the lawnmower on wet grass.

Do not operate on excessively steep slopes.

Check the limits indicated in the manual.



CAUTION - Risk of overturning on steep gradients.

Do not use the machine on lawns with gradients of more than 25% (14°).

Do not use the machine on lawns with side gradients above 15% (8°).



>25%



>25%



>15%

Remember, there is no such thing as a “safe” gradient. Mowing on sloped lawns requires special care and experience.

To prevent overturning:

- Never stop or start suddenly on slopes;
- Engage the drive gently and always keep the drive engaged, especially on downward slopes;
- Speed must be reduced on slopes and sharp bends;
- (Gear models only) Never move down slopes with the gear shift in neutral (N) ; engage a lower gear;
- Be careful of mounds, bumps and hidden hazards;
- Never mow across slopes, but always either up or down.



SAFETY PRECAUTIONS

Be very careful when changing direction on slopes. Stop the blade when crossing terrain other than lawns and when the lawnmower is transported to and from the work area.

Do not use the lawnmower with faulty guards or without safety devices fitted, for example, the grass catcher.

Do not modify the engine (where fitted) or grass chute (where fitted) adjustments and do not tamper to increase the engine speed. If the speed of the engine is too high, this could cause personal injuries.

Disengage the blade and drive control before starting the engine.

Hands and feet must be kept away from the blade. Always keep away from the grass chute opening.

Before leaving the driving seat:

- Place the gear-shift in neutral (N) or release drive pedal and engage the parking brake (fig.37-38)
- Disengage the blade and lower the blade deck;
- Stop the engine and remove the key.



HAZARD - Before carrying out any inspection, cleaning and servicing operations on the machine or before unblocking the grass chute, stop the engine, take out the ignition key and follow the instructions in the manual.



HAZARD - The blades are sharp; risk of serious injury. Before carrying out any inspection, cleaning and repair operations on the cutting parts, stop the engine and take out the ignition key. Now disconnect the spark plug wire, and keep the cap away from the plug (fig.51), to prevent accidental starting.



HAZARD - The blades are sharp; risk of serious injury. Wait for the blade and all the moving parts to come to a halt before touching them. The blade will continue turning for some time after switching off the engine or disabling the blade control.

Disengage the blade during transport and every time it is not used.

Stop the engine and remove the key and disengage the blade:

- Before leaving the machine;
- Before filling up with petrol;
- Before removing the grass catcher;
- Before adjusting cutting height if the operation is not performed from the driving seat.



Make sure the throttle control is at minimum before switching off the engine.

Stop the engine, remove the key and disconnect the spark plug wire;

- If you strike a foreign body, stop the engine, disconnect the spark plug wire and carefully inspect the lawnmower for any damage.
- Have any damage repaired before you start the engine again by an authorised service centre.
- Should the machine display unusual vibrations, stop the engine and immediately seek the cause of the vibrations. As a rule, unusual vibrations are an indication of a problem.

Maintenance

Make sure all the nuts and screws are tight, so the lawnmower is in good operating condition and safe to use.

Wait for the engine to completely cool down before cleaning, adjusting or repairing.



DANGER of burns

Never store the lawnmower indoors with petrol in the tank, as the fumes may reach a naked flame or a source of sparks.

Wait for the engine to cool down, before storing the lawnmower in a secluded area.

In order to reduce the risk of fire, keep the engine, the muffler (battery housing) and petrol deposit area free of grass, leaves or excessive grease.

Frequently make sure the grass catcher is not worn or torn.

For safety reasons, repair any worn or damaged parts. Only use original spare parts. Non-original spare parts may not fit properly and cause damage or danger.

Should you need to empty the fuel tank, do so in an open well ventilated space.

When the machine has to be put away or left unguarded, lower the blade deck and remove the ignition key to prevent unauthorised persons starting the machine.

Regularly check or have a authorised Victa service centre check, the tightening of the blade and the engine supporting bolts.

For safety reasons the following operations must be carried out by an authorised Victa service centre;

- Blade adjustment, sharpening, balancing or replacement.
- Any demanding operations which require specific competence or specialised equipment.

The lawnmower blade is sharp and can cut the skin.

You need to take the necessary precautions whenever you work near or on the blade.



Wear heavy gloves



SAFETY PRECAUTIONS

Machine Safety

Your lawnmower has been designed in accordance with specific safety standards. This is why safety systems have been fitted, which operate as follows:

A) The engine will not start unless all machine safety conditions are in place.

Conditions to be complied with:

- 1) start switch in position
- 2) parking brake engaged
- 3) cutting blade disengaged
- 4) Gear selector in N (Neutral) position or Drive pedals disengaged.

B) The engine will stop if one of the machine safety conditions are not met;

The engine stops if:

- 1) the operator leaves the driving seat without engaging the park brake
- 2) the operator leaves the driving seat with blade rotation enabled.
- 3) the grass catcher is lifted without having disengaged blade rotation (where fitted).
- 4) blade rotation is engaged without the catcher having been fitted (where fitted).
- 5) reverse gear is engaged without having disengaged blade rotation (Gear model only - for more information on reverse mowing, refer to Driving and Cutting section in this manual)



**HAZARD! Never tamper with the safety switches and their power leads.
In case of a fault, do not use the machine, but contact an authorised Victa service centre.**

Intended Use

This machine is designed to be used in the open-air only as a lawnmower for lawns and grassed area in gardens and in compliance with the safety and operating instructions indicated in this manual.

Any other use should be deemed "hazardous" and shall invalidate the warranty and relieve the Manufacturer of all liability.



HAZARD! This machine is not allowed to circulate on public roads and is not approved to transport persons.



Machine Parts

Fig 3

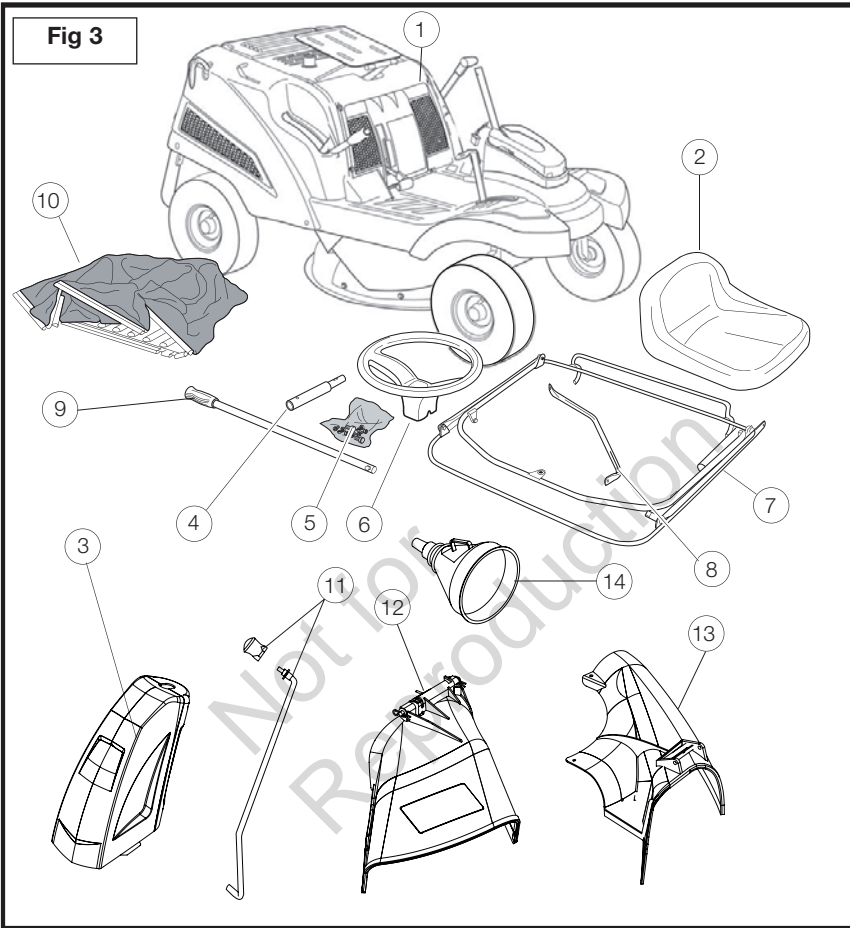

The component parts of the machine to be assembled appear as in fig.3.

1) Machine body

2) Seat

3) Steering column covers

4) Steering wheel shaft extension

5) Tool bag (includes tools and keys)

6) Steering wheel

7) Catcher frame (where fitted)

8) Catcher handle (where fitted)

9) Catcher overturning lever (where fitted)

10) Fabric grass Catcher (where fitted)

11) RMO lever (where fitted)

12) Side chute

13) Housing side chute

14) Funnel



MACHINE ASSEMBLY

Identification of main machine parts and controls

Refer to fig. 4

- 1) **Blade deck** - the housing protecting and enclosing the rotating cutter blade;
- 2) **Rotating blade** - (under the blade deck) the blade cuts the grass and expels the cut grass into the grass catcher.
- 3) **Grass chute** - on rear catcher models only, this transfers cut grass from the blade deck to the grass catcher.
- 4) **Grass catcher** - besides collecting the cut grass, this is a safety element that prevents the launching of grass and collected materials.
- 5) **Engine** - (refer to manufacturer's engine manual supplied with the machine).
- 6) **Battery**.
- 7) **Driving seat** - operator drive and control position. The seat activates safety switches when operator is seated.
- 8) **Notice and safety labels** - indicating the main rules for working safety (see specific chapters in this manual).
- 9) **Steering wheel**.
- 10) **Engine compartment cover** - (lift seat to access) must be raised to fill up with petrol and oil.
- 11) **Brake / clutch pedal (gear model)**.
- 12) **Parking brake lever**.
- 13) **Ignition key**.
- 14) **Engine pull start**.
- 15) **Engine throttle lever**.
- 16) **Blade deck and cutting height adjustment up/down lever**.
- 17) **Blade rotation engagement lever**.
- 18) **Drive and speed change engagement lever (Gear driven models only)**.
The lever selects:
 - the four forward gears; (1-2-3-4);
 - the neutral position (N);
 - the reverse gear (R);
- 19) **Front steering wheels**.
- 20) **Rear driving wheels**.
- 21) **Rear cover**
- 22) **Hydrostatic transmission release/engagement lever (hydrostatic models only)**.
- 23) **Reverse drive pedal (hydrostatic models only)**.
- 24) **Forward drive pedal (hydrostatic models only)**.
- 25) **Brake (Hydrostatic models only)**
- 26) **Grass catcher overturning lever**
- 27) **Reverse mowing operation (RMO) lever**
- 28) **Side discharge chute**
- 29) **Catcher hook**
- 30) **Deck wash port**



Fig 4

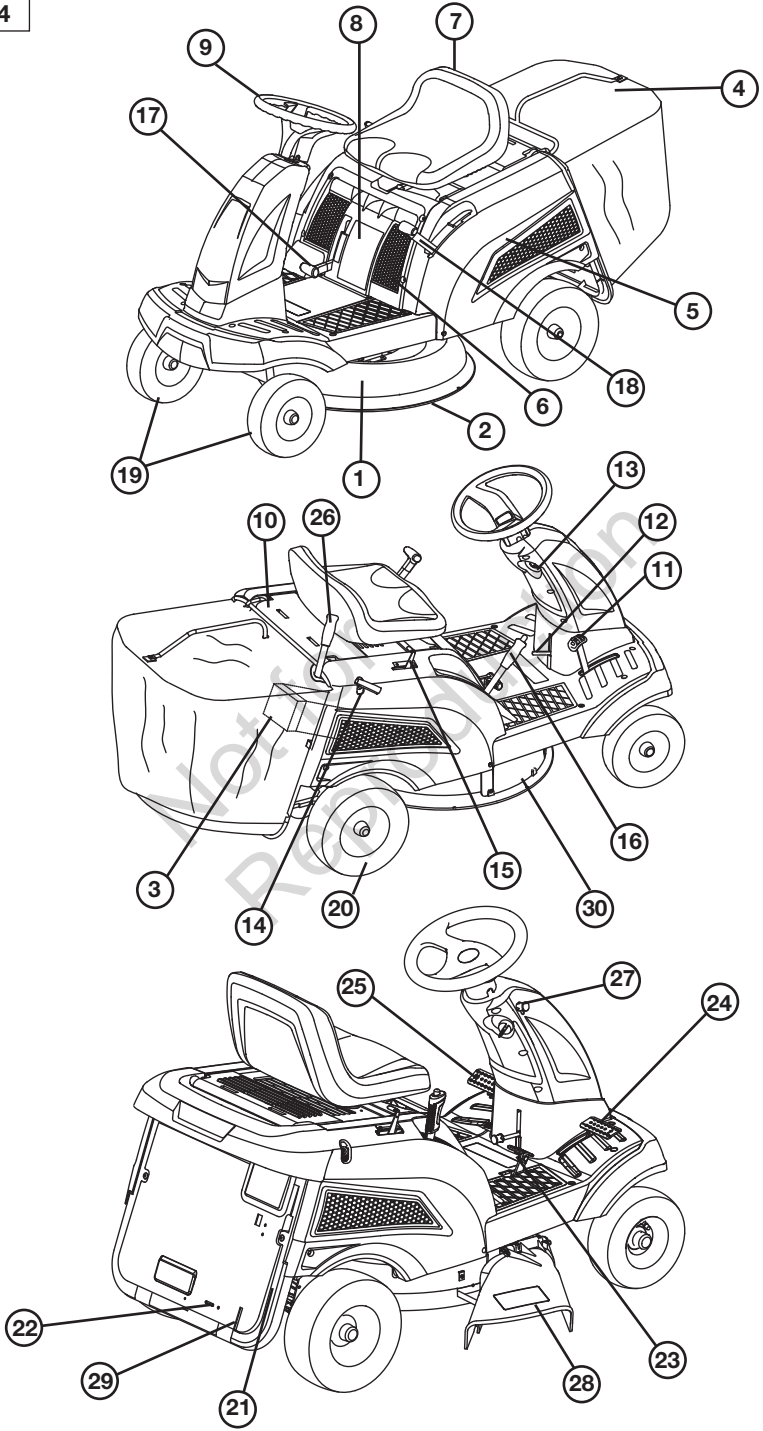



MACHINE ASSEMBLY

Fitting the steering wheel

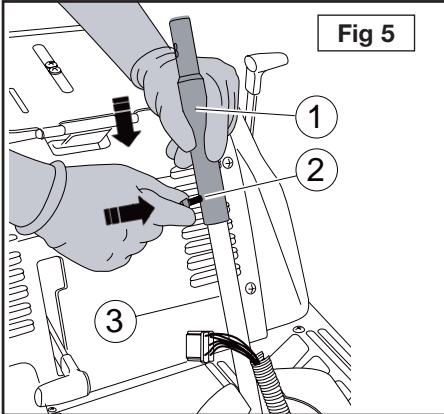

1) Fit the steering wheel column extension (fig.5 part 1) on the shaft (part 3) and secure it with the screw (part 2) and the nut provided. Tighten well.

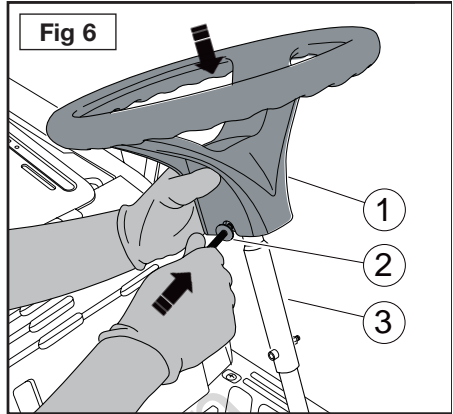

2) Position the steering wheel (fig.6 part 1) on the extension (part 3) and secure with the screw (fig.6 part 2) and the nut provided. Tighten well.

Steering Column Covers

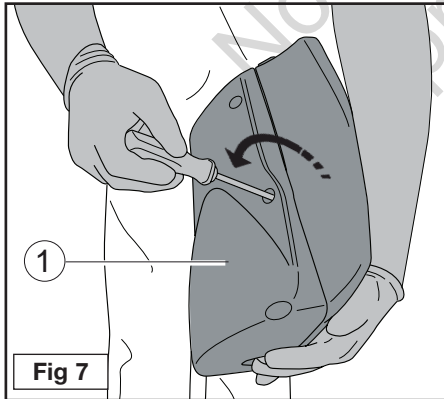

1) Remove the 6 screws (fig.7) to separate the covers (fig.7 part 1).

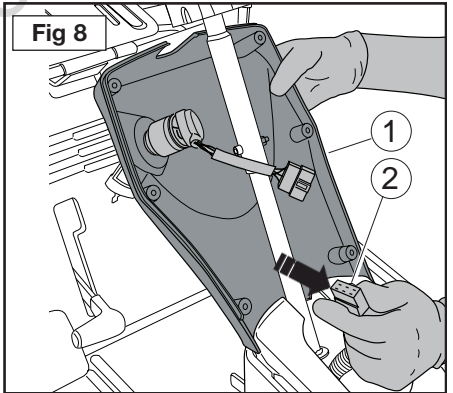

2) Position the rear steering column cover (part with key switch, fig.8 part 1). locking the fastening tangs into the support base (see fig.8). Keep the switch power plugs handy (fig.8 part 2).

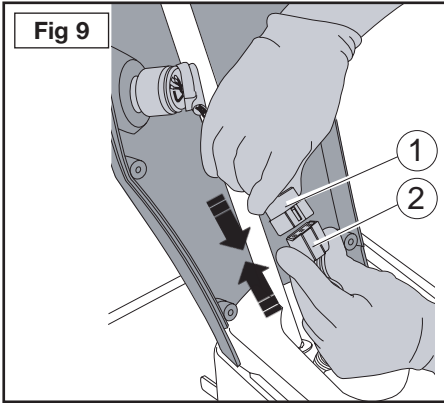

3) Connect the two plugs (fig.9 part 1-2), ensuring clip is engaged

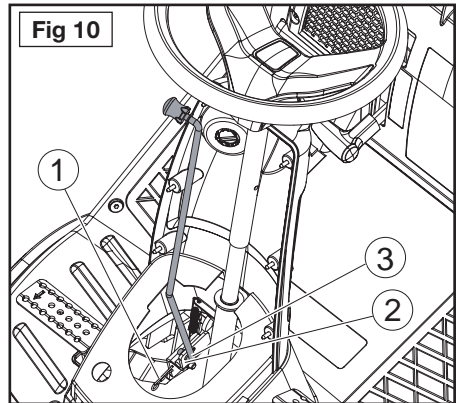

For Hydrostatic models, fit RMO Lever (FIG.3, part 12)

1. Remove 'R' Clip (1) from bottom of RMO lever.
2. Locate RMO bracket (2) near bottom of steering column.
3. Fit bottom end of RMO lever (3) into hole in bracket and refit 'R' clip to lever to secure.

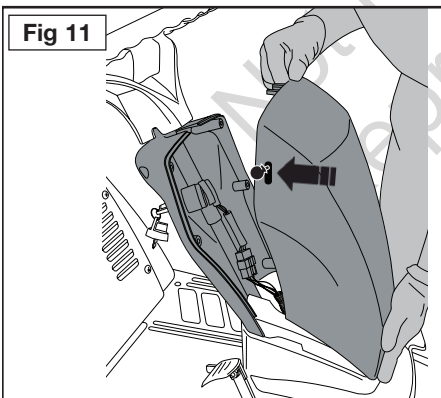

4) Position the front cover and align the screw fastening holes (fig.11 part 1). If your machine is fitted with RMO. Unscrew knob from RMO lever. Position top of RMO lever through slot in front cover and re-fit knob, tightening well.

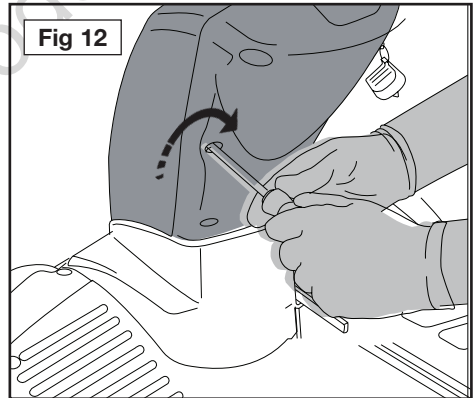

5) Align holes, fit and tighten the 6 screws (fig.12).



MACHINE ASSEMBLY

Fitting the seat

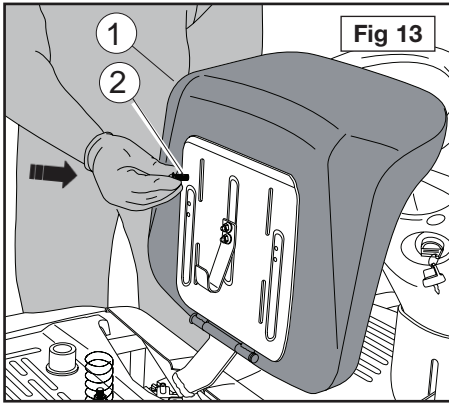

1) Fit the seat (fig.13 part 1) to the mounting plate, with the screws (fig.13 part 2)

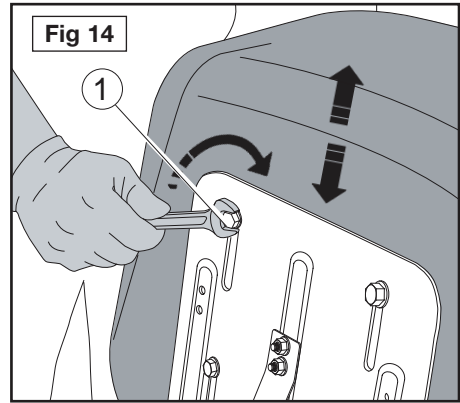

2) Before tightening the 4 screws (fig.14 part 1) adjust the forward/backward position of the seat, to best suit the driver.

Fitting the catcher-hook spring

(Rear catcher models only)

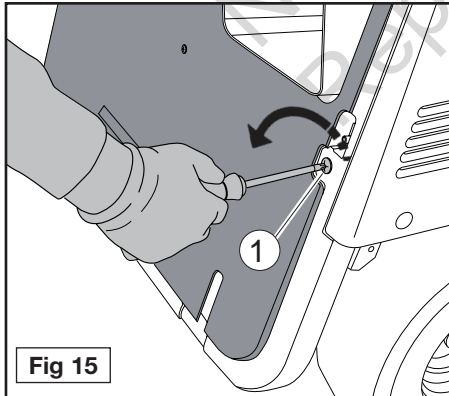

1) Loosen the screws (fig.15 part 1) and pull out the rear cover.

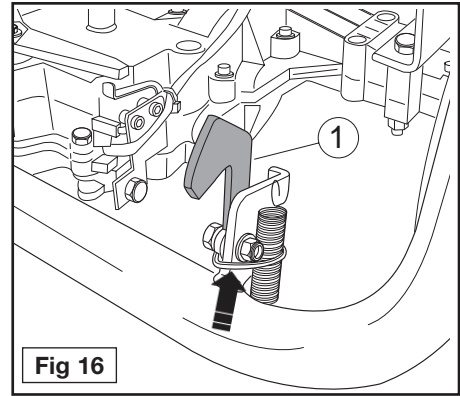

2) Cut the plastic straps (fig.16 part 1) to free the hook and spring. (catcher model only)

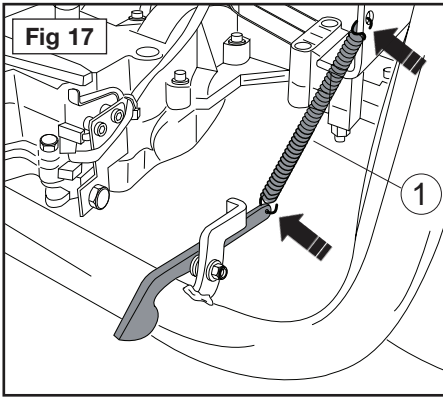

3) Secure the two spring hooks (fig.17 part 1) in the two holes indicated by the arrows (fig.17).

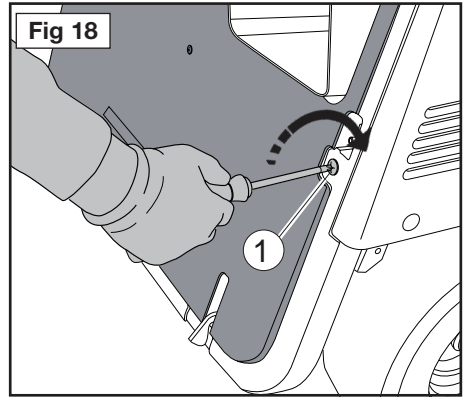

4) Reposition the cover by pressing with your hands and refit screws (fig.18 part.1)

Fitting the grass catcher

(Rear catcher models only)

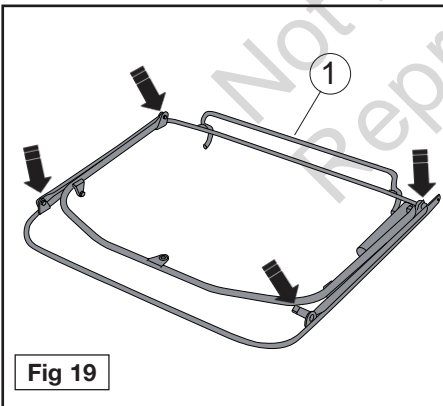

The catcher frame (fig.19 part 1) is pre-assembled and the screws and nuts for complete fitting are secured at the points indicated by the arrows in fig.18.

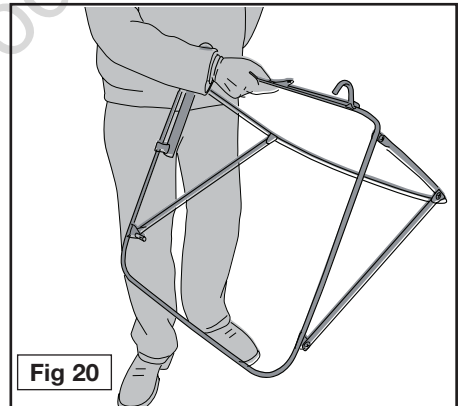

1) Loosen the screws and nuts so as to be able to open and fasten the frame (fig.20).
2) Tighten all the screws and the nuts of the frame.



MACHINE ASSEMBLY

Fitting the grass catcher

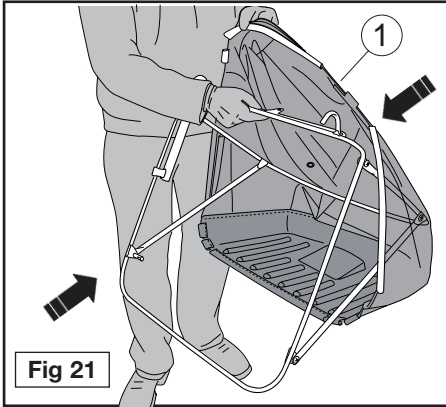

3) Fit the frame inside the bag (fig.21 part 1).

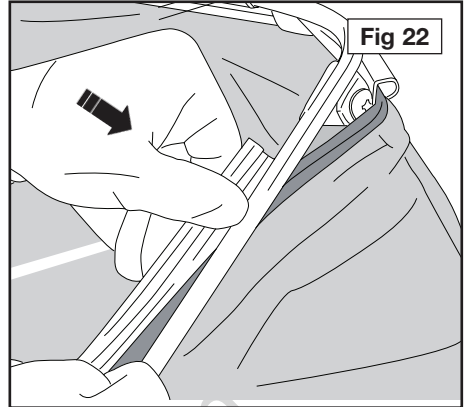

4) Secure all the plastic profiles (fig.22) to the frame tubes, with the aid of a screwdriver (fig.23).

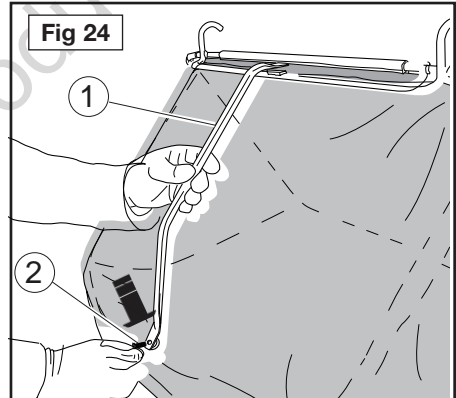
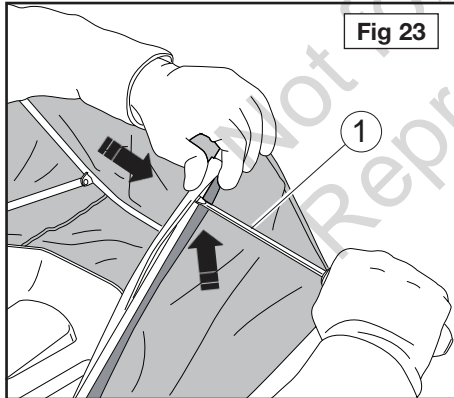

5) Fasten the handle (fig.24 part 1) to the catcher frame, using the screws provided (fig.24 part 2).

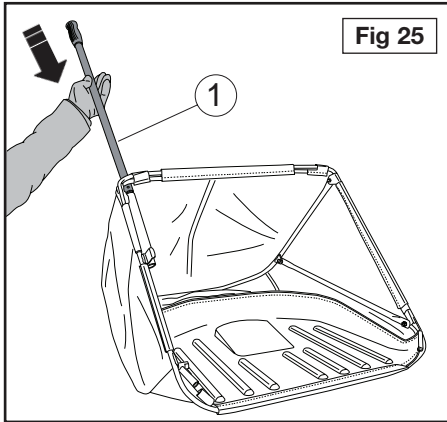

6) Fit the catcher overturning lever in the housing provided as shown in fig.25, after removing the screw and locknut (fig.26 part 1)

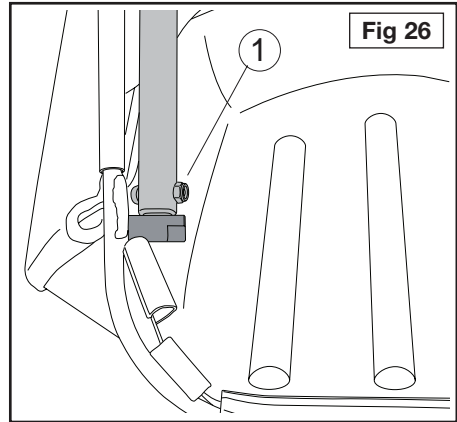

7) Fasten the rod with the screw and nut (fig.26 part 1) once positioned.

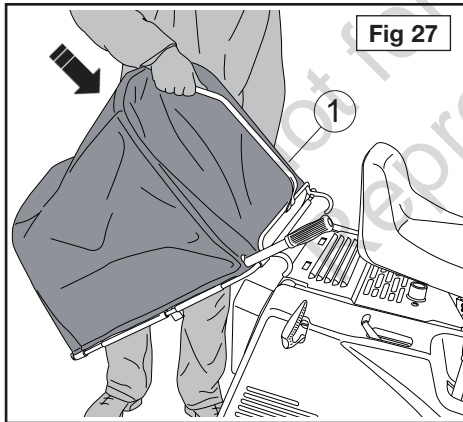

8) Secure the catcher to the machine (fig.27)



MACHINE ASSEMBLY

Fitting the Side Discharge Chute

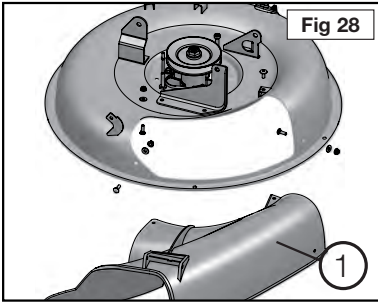

Remove 4 screws supplied pre assembled to cutting deck.

Position chute housing (1) aligning with screw holes. Re-position the cable located on top of the deck so that it is not clamped under the housing. Locate the 3 screws with nuts into the square holes provided from the inside of deck and assemble washers and nuts. Fit remaining screw. Firmly tighten all 4 screws.

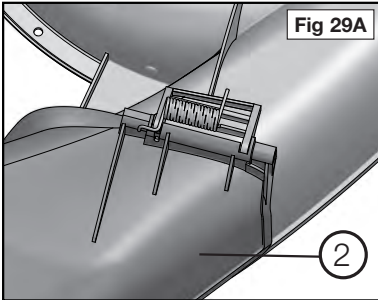

Remove pin and spring from Side Discharge Chute (2). Place Side Discharge Chute (2) on Housing and align holes.

Position and orientate spring as shown

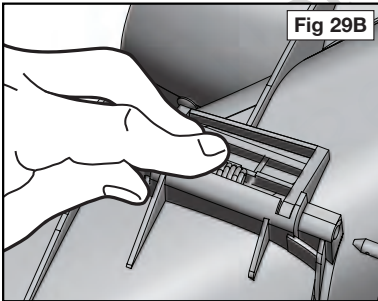

Hold spring down and twist straight leg up to sit on top of ribs

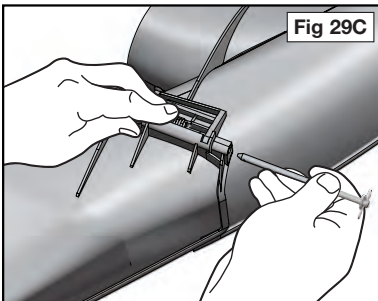

Push pin through holes and centre of spring. Align left hand holes and push pin all the way through. Fit washer and retaining clip to pin.



Connecting the Battery



HAZARD: Batteries should never be put in the recycling bin or in your waste bin. If the battery needs to be replaced, contact local authorities or recycling facility for correct, safe disposal.

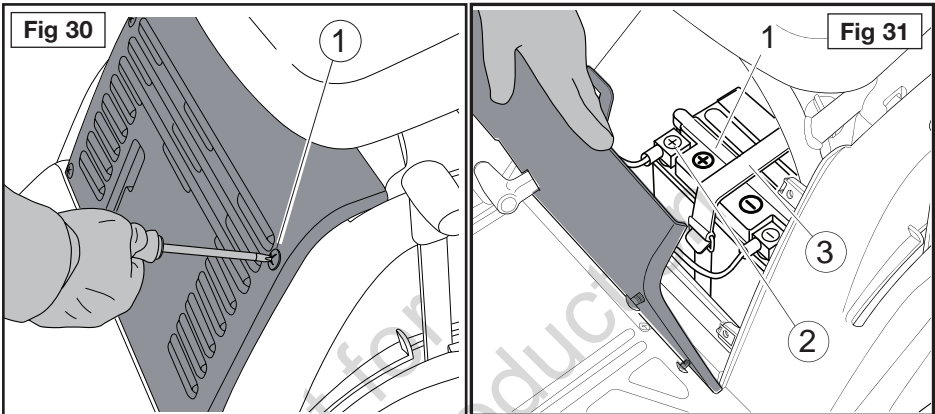

- 1) Remove the 6 screws (fig.30 part 1) which secure the front cover of the engine compartment. Hold cover away as shown in fig.31.
- 2) Locate the battery (fig.31 part 1).
- 3) Connect the battery connectors to the machine connection leads and tighten the 2 screws (fig.31 part 2).
- 4) Secure the battery with the small rubber strap (fig.31 part 3).
- 5) Replace cover. Firstly locate bottom tabs, then slide side tabs under side panels before replacing screws.



IMPORTANT Position the battery with the polarities **+** and **-** as indicated in fig.29.



HAZARD When attaching the leads, mind the polarities **+** and **-** of the battery.



PREPARATION

Connecting the Battery



HAZARD - Hot surfaces: danger of burns.

Wait for the engine to completely cool down before making any adjustments or servicing the engine.

Filling with petrol



HAZARD - Filling up must be done with the engine switched off in an open and well ventilated environment.

Always remember that petrol fumes are highly inflammable.



DO NOT USE OPEN FLAMES NEAR THE MOUTH OF THE TANK TO CHECK THE LEVEL AND DO NOT SMOKE WHEN FILLING UP.



Follow the instructions in the manufacturer's engine manual supplied with the machine.

Keep the petrol in a container designed for the purpose and with cap properly tightened.

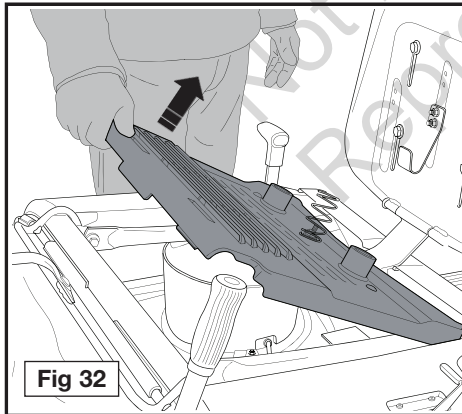

Fig 32

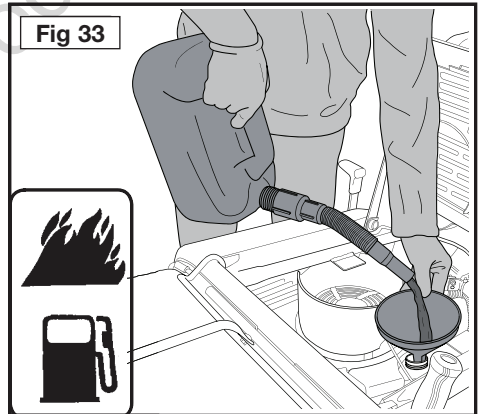

Fig 33

1) Lift the seat and engine compartment cover (fig.32)

2) Loosen the petrol tank cap (fig.33)

3) Use a funnel to fill up. Do not fill the tank up completely to prevent fuel overflowing. Tighten the petrol tank cap well after filling up.



Filling and Checking Engine Oil



IMPORTANT The machine is shipped without lubricating oil in the engine.

CAUTION Irreparable damage to engine; fill up with oil before starting the engine.



HAZARD Filling up must be done with the engine switched off.

- 1) Lift the seat and the engine compartment cover (fig.32)
 - 2) Unscrew the oil cap.
 - 3) Use a funnel to fill up (fig.34)
- The oil level must be between the MIN and MAX notches of the dipstick (see fig.34).
Do not exceed the maximum level.
Screw the oil cap back on.

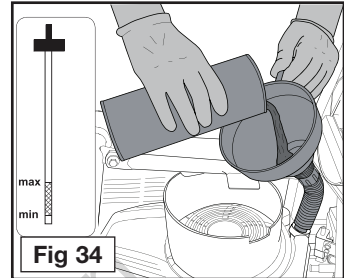

Fig 34

Follow the instructions in the manufacturer's engine manual supplied with the machine.

Tyre Pressure

Correct tyre pressure ensures machine stability and the correct alignment of the blade with the ground. Periodically check the pressure of the tyres and regulate according to the pressures shown on the technical data table.
To inflate the tyres use an inflation gun featuring pressure gauge (fig.35).

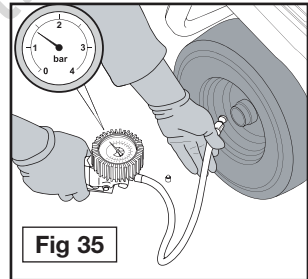

Fig 35

Controls and Start-up



IMPORTANT Only the preliminary machine control functions are explained in this section. Refer to subsequent Start-Up section on how to use controls.

Controls and control instruments

Steering wheel (fig.4 part.9) - Directly steers the front wheels.

Brake: press the pedal fully down to slow down or stop the machine.

The brake operates on the rear wheels.





OPERATIONS

Controls and Start-up

GEAR MODELS

Brake/Clutch Pedal: This pedal has a dual function (fig.4 part.11)

Parking Brake: with machine stopped:

- 1) Keep the pedal pressed
- 2) Lift the parking brake lever and keep lifted
- 3) Release the pedal

This way, the rear wheels remain braked. To release the parking brake, fully press the pedal (the parking brake lever is automatically released and returns to down position).



Clutch: the same brake pedal, in the top part of its stroke, works as a clutch pedal for machine movement.

With the pedal released, the clutch is completely engaged and transmits movement to the rear wheels. Speed depends on which gear has been engaged.

Movement engagement and speed change lever (fig.4 part.18)

- Selects machine forward / reverse movement. This lever has 6 positions, corresponding to 4 forward gears “1-2-3-4”, neutral position “N” and reverse gear “R”.
- To switch from one gear to another, at mid stroke press the “brake/clutch” pedal (fig.4 part 11) and move the lever to the required position.



CAUTION: Only engage the reverse gear when the machine is stopped.

CAUTION: Before engaging the reverse gear, disengage blade rotation.

HYDRO MODELS

Brake pedal (fig.4 part.25): Press pedal down to slow or stop machine.

Parking Brake: with machine stopped

- 1) Keep the pedal pressed.
- 2) Lift the parking brake lever and keep lifted.
- 3) Release the pedal.

This way, the rear wheels remain braked. To release the parking brake, fully press the pedal (the parking brake lever is automatically released and returns to down position).

Forward Drive Pedal: Press pedal down to move forward and accelerate.

Reverse Drive Pedal: Press pedal down to move in reverse direction.

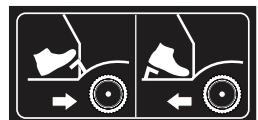



Ignition Key (for manual starting) (fig.4 part 13) - if inserted and turned to position “2” manual start will be enabled. If turned to “1” position, it switches engine off.

Ignition Key (for electric starting) (fig.4 part 13) - Rotation to “3” position - automatic start. When released, the key automatically returns to “2”
If returned to “1” position, it switches off engine.

Engine pull start cable (fig.4 part.14) - By giving the handle a good pull, the engine starts. After pulling, return the handle into its housing to facilitate automatic cable rewinding.

Throttle lever (fig.4 part 15) - reduce or increases engine revs.

SLOW pos.  engine minimum speed

FAST pos.  engine top speed.

Blade deck up/down lever (fig.4 part 16)



Lifts or lowers the blade deck and thereby adjusts the grass cutting height.

There are 4 possible height adjustments. Press the handle on the lever and accompany the lever to the required position.

When the button is released, the lever remains in the selected position.

Cutting heights: see technical data table.

Blade rotation engagement lever (fig.4 part 17) - starts or stops blade rotation.



Blade engaged



Blade disengaged

If the lever is engaged without observing safety conditions, the engine will not start or will automatically switch off if it is running.

See chapter **Safety Precautions**

Preparing for start-up

If the machine has not been used for a long time, the operator must perform preliminary checks in order to be able to start and use the machine safely.

Safety system operation check

Make sure the safety systems are in good working order by simulating the operating conditions indicated in **Safety Precautions**. Make sure that each operation corresponds to the indicated effect.



OPERATIONS

Start-Up

To start the engine:

- 1) Operate the parking brake.
Press down the brake pedal (fig.36 part 1)
Move the parking brake lever up (fig.36 part 2).
Release the brake pedal. Lever will remain in up position (see fig.37).

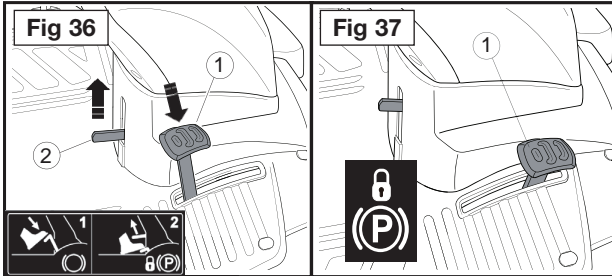

- 2) Lift the blade deck as far as it will go.
- 3) Disengage the blade.
- 4) For gear models shift the gear lever to neutral "N" (fig.38 part 3).
For hydrostatic models ensure drive pedal has returned to neutral position.
- 5) Shift the accelerator lever to accelerated position
- 6) For electric start turn the key (fig.39 part. 1) to "3" position
As soon as the engine starts, release the key which will return to "2" position

For manual pull-start

- Turn the key (fig.39 part. 1) to "2" position
- 7) Grip the handle (fig.40). Give a strong and quick pull.
Repeat the operation until the engine starts.

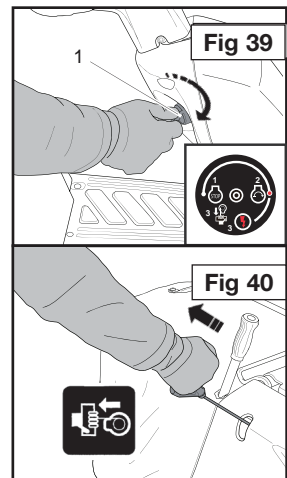
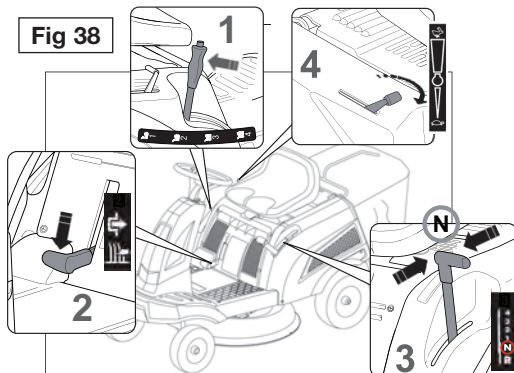



Start-Up

Engine Switch-Off

After using the machine:

- 1) Shift the accelerator lever (fig.40 part 4) to intermediate position. Let the engine run for at least 20 seconds.



In case of an EMERGENCY, switch off immediately.

- 2) Move the key to “1” position.
- 3) Before leaving the machine, engage the parking brake and take out the ignition key.

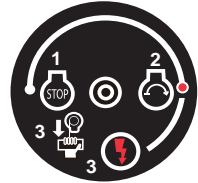

Driving and Cutting

Moving

IMPORTANT For hydrostatic models the hydrostatic lever in the rear cover must be engaged. With engine off, push lever in to engage.



CAUTION Be very careful when reversing. Never change direction of movement without first stopping the machine.

- 1) Start the engine.
- 2) Sit in the driver's seat.
- 3) Increase the number of engine revs to maximum position . 
- 4) For Gear models:
 - Move the speed change lever to speed required.
 - Release the parking brake by pressing the brake pedal and slowly release pedal to start forward movement of the machine.
- 5) For Hydrostatic models:
 - Release the parking brake by pressing the brake pedal.
 - Press the Forward Drive Pedal down to move forward.
- 6) Use the fastest gear “4” only for moving from one place to another and with the blade disengaged.



CAUTION This machine is not approved for travelling on public roads. It must only be used in private areas, closed to traffic.



OPERATIONS

Stop

- 1) Press the brake pedal to stop the machine.

Grass Cutting

- 1) Start the engine.
- 2) Sit in the driver's seat.
- 3) Place the throttle control lever to the maximum position .
- 4) For Gear models, select the speed change lever on one of the first 3 gears (fig.38 part 3).
- 5) Operate the cutting blade by lifting the engaging lever (fig.41 part 2).

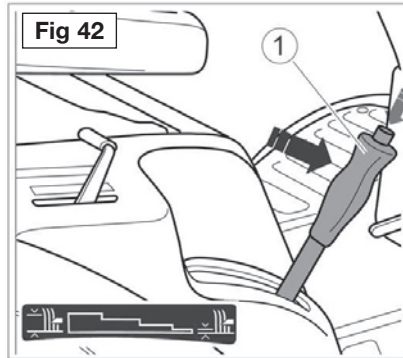
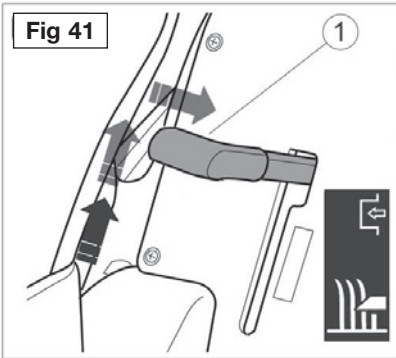

- 6) Lower the blade deck to the required height (fig.42 part 1) Slowly release the brake pedal.

- 7) For Hydrostatic models press the Forward Drive Pedal down to move forward



CAUTION Pedal release must always be gradual to prevent sudden engagement of the drive causing the vehicle to jump forward, with loss of control by the driver, especially on slopes.

For gear models:



Before starting reverse travel "R", lift and disengage the blade.



Cutting in Reverse



CAUTION For Gear Models the reverse gear cannot be engaged with the cutting blade engaged. The engine would switch off immediately.

For Hydrostatic models:

Reverse mowing operation (RMO) function:

When reverse is selected and blades are engaged the ground speed is limited. Activating RMO overrides the limited ground speed.

To activate RMO, engage reverse and push RMO lever (FIG.11) down until it locks in place.

The RMO function will automatically deactivate if:

Blades are re-engaged; or

Engine is restarted; or

Direction control is moved from the reverse position.



Emptying the grass catcher:

(Rear catcher models only)

Grass catcher models are fitted with an alarm to indicate that the catcher is full. However if cut grass trails behind on the ground, this means the grass catcher is full or that the grass chute is blocked:

- 1) Move to the cut grass emptying and storage area.
- 2) Stop the machine and operate the parking brake.
- 3) Disengage the blade.
- 4) Lift the catcher overturning lever as show in fig.43-44.
- 5) Push lever forward to overturn and empty the contents (see fig.45).
- 6) Lower the catcher so it completely adheres to the rear cover; if it does not, the safety switch will stop the engine when the blades are engaged.

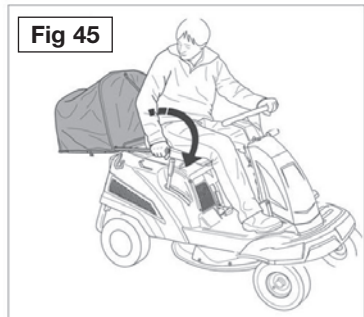
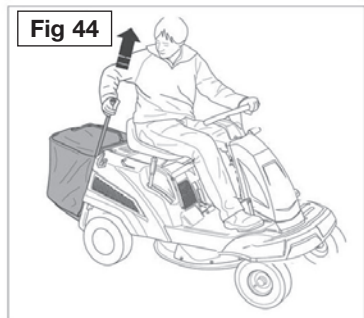
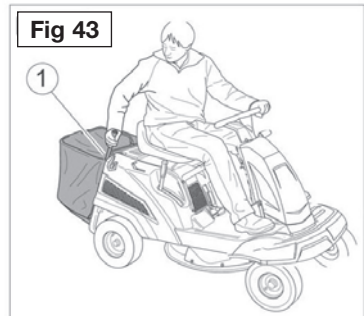

Cleaning the grass chute

CAUTION This operation must always be performed with the engine switched off and the ignition key removed.

Grass could block the chute due to:

Catcher full.

Speed too high.

Grass too high.

Grass too wet



OPERATIONS

Before cleaning the grass chute:

- 1) Operate the parking brake
- 2) Disengage blade rotation.
- 3) Lift the blade deck as far as it will go.
- 4) Switch off the engine and remove the key.
- 5) Release the catcher.
- 6) Remove the accumulated grass from the rear part of the chute.

Cutting Suggestions

CAUTION The machine is not suitable for heavy-duty work and for mowing large quantities of grass.

When adjusting the cutting height and machine speed, be careful not to overstress the machine. For problem-free use, the cutting height and the mower ground speed must be adapted to the height of the grass to be cut.

In case of blockages and drop in engine speed, engage a lower gear and further raise the blade deck.

On particularly rough surfaces, work with greater cutting height to prevent the blade knocking against any surface irregularities, with resulting damage to the blade and mechanical parts.



CAUTION When cutting on slopes, reduce speed of movement to ensure safety conditions.

Disengage the blade and move the deck to max height position every time an obstacle or hump has to be overcome.

The blade must be in perfect condition and sharp, so the cut is clean and without frays which could cause the grass to turn yellow.

The engine must be used at top speed, both to ensure a clean cut of the grass and to achieve good ejection of the cut grass through the chute.

In case of drought, do not use very low cutting levels so as not to damage the lawn.

It is best to cut the grass when the lawn is dry.

If the grass is very tall, two separate cutting operations are best performed, on different days; start with maximum height cutting and a low gear.

Operating times and days

The time of operation of the lawnmower could be regulated by specific national or local laws.

Contact the local authorities to find out.

Transport

The machine can only cover short distances.

For longer distances, use a transport vehicle featuring loading ramps.

Push the machine by hand and with the gear lever in neutral or hydrostatic drive disengaged.

Do not lift using cables.

Secure the machine adequately during transport.



Safety Precautions



CAUTION - HAZARD - Always carefully follow the instructions in the chapter: "Basic safety precautions".



HAZARD - Always replace the grass catcher if this is torn, unstitched or shows damage to the plastic profiles.



HAZARD - Due to the possible launching of grass and material collected up by the blade.



HAZARD - Before carrying out any inspection, cleaning and servicing operations on the machine, and before unblocking the grass chute, stop the engine, take out the ignition key and follow the instructions in the manual.

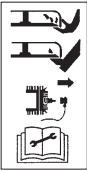

HAZARD - The blades are sharp: risk of serious injury to persons. Before cleaning, inspecting and repairing cutting parts, stop the engine and take out the ignition key. Now disconnect the spark plug wire and keep the cap away from the plug to prevent accidental starting (fig.50).



HAZARD - Hot surfaces: danger of burns. Wait for the engine to completely cool down before making any adjustments or servicing the engine itself.



HAZARD - Wear adequate clothes and work gloves to clean the blade and the blade deck and in all situations in which risks exist for your hands.



HAZARD - Never throw old oils, petrol or other polluting products away into the environment.



MAINTENANCE



HAZARD - Blade sharpening and balancing adjustment, including removal and refitting, are demanding operations which require specific competence, as well as special equipment. For safety reasons, these operations must be carried out by an authorised Victa service centre. The same applies to blade replacement with a new one.



HAZARD - Any damaged or bent blades must always be changed for safety reasons. Always use original blades.

Safety Recommendations



WARNING - Before cleaning or doing maintenance work, take out the ignition key and read the relevant instructions. Wear adequate clothing & work gloves whenever your hands are at risk.



WARNING - Never use the machine with worn or damaged parts. Faulty or worn-out parts must always be replaced and not repaired. Only use original spare parts: The use of non-original and/or incorrectly fitted parts will compromise the safety of the machine, may cause accidents or personal injuries for which the Manufacturer is under no circumstance liable or responsible.

IMPORTANT - Never dispose of used oil, fuel, batteries or other pollutants in unauthorised places!



WARNING - Any adjustments or maintenance operations not described in this manual must be carried out by your Dealer or a specialised Service Centre. Both have the necessary knowledge and equipment to ensure that the work is done correctly without affecting the safety of the machine.

All and any operations performed in unauthorised centres or by unqualified persons will totally invalidate the warranty & all obligations & responsibilities of the manufacturer. You must go to a specialised Service Centre or contact your Dealer if the following are malfunctioning:

- the brake;
- the engagement and stop of the blades;
- the drive engagement in forward and in reverse gears.



Routine Maintenance

The table is to help you maintain your machine's safety and performance. It summarises the main interventions to be made and the frequency applicable to each of them.

Operation	Hours	Completed (Date or Time)
1. MACHINE		
Check of fastening and sharpness of blades 3)	25	
Blade replacement 3) (immediately if damaged)	100	
Transmission belt check 3)	25	
Transmission belt replacement 2) 3)	-	
Blade belt check 3)	25	
Blade belt replacement 2) 3)	-	
Drive adjustment and check 3)	25	
Blade brake and engagement check 3)	25	
Bolt and screw check	25	
General lubrication 4)	20	
Grease steering gear (hydro models), tension arm assembly, stub axle shafts	20	
2. ENGINE 1) refer engine manufacturer's manual for frequency		
Engine oil change	
Air filter cleaning and check	
Air filter replacement	
Fuel filter check	
Fuel filter replacement	
Spark plug contacts check and cleaning	

- 1) See the engine manual for the full list and frequency.
- 2) At the first signs of any malfunction, contact your Dealer immediately.
- 3) The operation must be carried out by your Dealer or a specialised Service Centre.
- 4) General lubrication should also be carried out whenever the machine is to be left unused for a long period.

Rear axle

This is a sealed single unit that does not require maintenance. It is permanently lubricated and its lubricant does not need changing or topping up.

Cutting deck alignment

The cutting deck should be properly set to obtain an evenly cut lawn and reduce vibrations. If the cut is uneven, check the tyre pressure.

If this is not sufficient to achieve an even cut, please contact your Dealer who will test and make the necessary adjustments to the alignment of the cutting deck.



MAINTENANCE

Routine Maintenance

Battery

The machine is supplied with a sealed battery and does not require maintenance. During normal use the machine will automatically recharge the battery. After a long period of disuse the battery may lose charge.

Replacing the fuse

The machine is fitted with a 20A fuse located on top of the relay/starter solenoid.

IMPORTANT A blown fuse must always be replaced by one of the same type and ampere rating

Replacing Wheels

If wheels or tyres need to be replaced ensure the replacement is the same external diameter. A change in wheel/tyre size may cause an uneven cut & may be necessary to adjust the alignment of the cutting deck.

Machine Cleaning

Machine

Do not use high-pressure nozzles or aggressive liquids to wash the body and engine. Remove any deposits of dry grass or leaves from around engine, battery and fuel tank before and after use.

Engine

(Refer to engine manual supplied with machine)

Periodically clean the air filter (fig.46-48) and check the ignition plug electrodes (fig.49-51). To service the engine, follow the instructions in the manufacturer's engine manual supplied with the machine. At the start of each season, check the machine and have it serviced by an authorised Victa service centre.

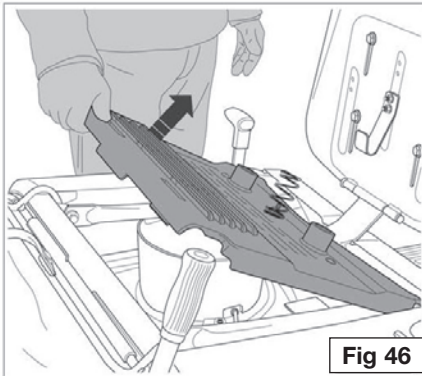

Fig 46

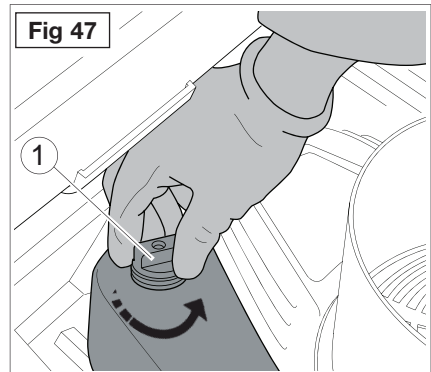

Fig 47



Machine Cleaning

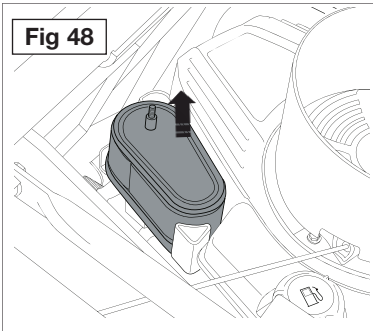

Fig 48

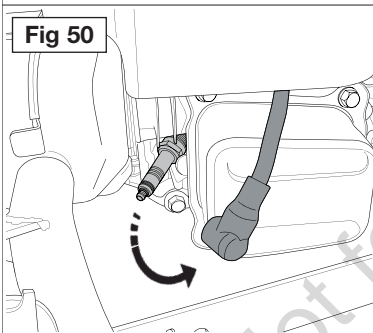

Fig 50

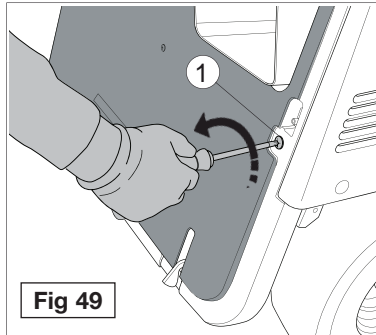

Fig 49

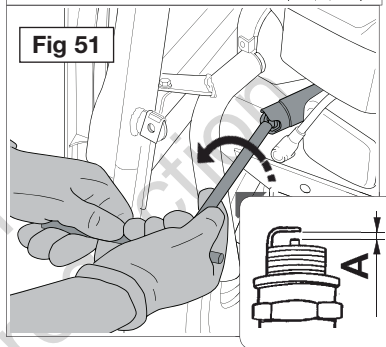

Fig 51

Grass Catcher

The grass catcher (where fitted) can be cleaned by means of a strong jet of water.

Blade Deck

Washing the inside of the blade deck and of the grass chute can be done as follows:

- 1) position the machine on an outside floor.
- 2) fit the grass catcher.
- 3) connect hose (fig.52 part 1) to the blade deck. (fig.52 part 2)
- 4) sit in the seat and engage the parking brake; move the gear lever to neutral (N).
- 5) move the blade deck to minimum level (full down).
- 6) start the engine.
- 7) allow the blade to turn for a few minutes.

Remove the catcher and rinse it with a strong jet of water.

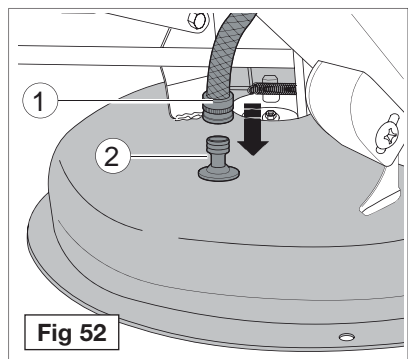

Fig 52



MAINTENANCE

Dismantling, Sharpening and Balancing the Blade

Check that the blade is sharpened properly and firmly fixed to the bracket.

- A badly sharpened blade pulls at the grass and causes the lawn to turn yellow.
- A loose blade causes unusual vibrations and can be dangerous.



WARNING! All operations on the blade (dismantling, sharpening, balancing, remounting and/or replacing) require a certain familiarity and special tools. For safety reasons, go to a specialised centre if you do not have the right tools or experience.

To remove the blade (fig 53-54), lock blade with purpose made jig or a block of wood. Wearing strong gloves, undo the central screw (1). Sharpen the two cutting edges using a medium grade grinding wheel and check the balance by holding the blade up with a round Ø20 mm bar inserted in the central hole.

To ensure that it works properly without unusual vibrations any imbalance between the two parts of the blade must be below one gram.

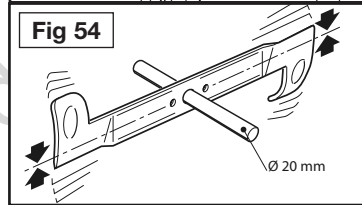
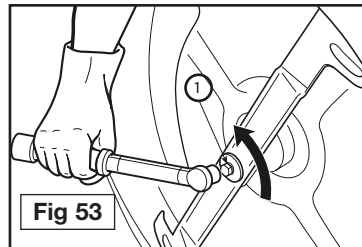

WARNING! Always replace the damaged or bent blade; never try to repair it! Always use Victa genuine replacement blades!



WARNING! When re-fitting the blade, always follow the indicated sequence, making sure that the blade's wings are facing towards the interior of the cutting deck and that the concave part of the cup spring (1) is pressing against the blade. Tighten the fixing screw (2) using a torque wrench set to 60-70 Nm. If the shaft hub (3) came off when dismantling the blade, make sure that the key (4) is firmly in its right position.

Replacing the belt

The belt replacement must be carried out at a by an authorised Victa service centre.

Note: Replace the belts as soon as they show obvious signs of wear! ALWAYS USE GENUINE REPLACEMENT BELTS!

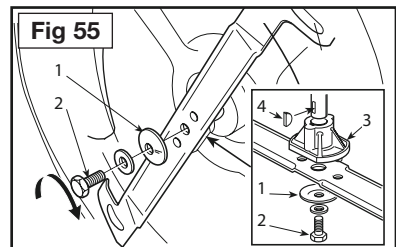



PROBLEM	LIKELY CAUSE	SOLUTION
With the key on "START" the starter motor does not run.	Turn the key to position «OFF» and look for the causes:	<ul style="list-style-type: none"> • Conditions are not met to allow starting.
	Conditions are not met to allow starting.	<ul style="list-style-type: none"> • Check that the conditions allowing starting are met.
	Badly connected battery.	<ul style="list-style-type: none"> • Check connections.
	Battery terminals crossed.	<ul style="list-style-type: none"> • Check connections.
	Completely flat battery or eroded battery plates.	<ul style="list-style-type: none"> • Recharge the battery.
	Fuse blown.	<ul style="list-style-type: none"> • Replace the fuse.
	Malfunction on the starter relay.	<ul style="list-style-type: none"> • Contact your authorised Victa service centre.
With the key on «START», the starter motor runs but the engine does not start.	Insufficiently charged battery.	<ul style="list-style-type: none"> • Recharge the battery.
	Faulty fuel supply.	<ul style="list-style-type: none"> • Check the level in the tank. • Open the fuel stopcock (if present). • Check the fuel filter.
	Faulty ignition.	<ul style="list-style-type: none"> • Check that spark plug cap is securely fitted. • Check that the electrodes are clean and have the correct gap.
Starting is difficult or the engine runs erratically.	Fault in carburation.	<ul style="list-style-type: none"> • Clean or replace the air filter. • Empty the fuel tank and refill with fresh fuel. • Check and replace the fuel filter if necessary. • Refer to engine manual. • Check oil level
Poor engine performance during cutting.	Forward speed too high compared to cutting height.	<ul style="list-style-type: none"> • Reduce the forward speed and/or raise the cutting deck.
	Worn or damaged blades.	<ul style="list-style-type: none"> • Check blades and replace if damaged or worn.



TROUBLESHOOTING

PROBLEM	LIKELY CAUSE	SOLUTION
The motor shuts down whilst working.	The safety devices have cut in.	<ul style="list-style-type: none">• Check that the conditions allowing starting are met.
	Fuse blown.	<ul style="list-style-type: none">• Replace the fuse.
The blades do not engage or do not stop promptly when they are disengaged.	Problems with engagement mechanism.	<ul style="list-style-type: none">• Contact your authorised Victa service centre.
Uneven cut.	Cutting deck not parallel to the ground.	<ul style="list-style-type: none">• Check pressure and the external diameter of tyres.
	Blades worn or damaged.	<ul style="list-style-type: none">• Contact your authorised Victa service centre.
Unusual vibrations while working.	Cutting deck full of grass.	<ul style="list-style-type: none">• Clear the cutting deck.
	Blades are unbalanced or loose.	<ul style="list-style-type: none">• Contact your authorised Victa service centre.
	Bolts and screws are loose.	<ul style="list-style-type: none">• Check and tighten all the engine and frame bolts.
Uncertain or ineffective braking.	The brake is not adjusted correctly.	<ul style="list-style-type: none">• Contact your authorised Victa service centre.
Erratic forward movement, poor drive when going uphill or if the machine has a tendency to rear up.	Problems with the belt or the engagement device.	<ul style="list-style-type: none">• Contact your authorised Victa service centre.
With the engine running, the machine does not move when the drive pedal is pressed (for hydrostatic drive models).	Hydrostatic transmission engagement lever is not engaged.	<ul style="list-style-type: none">• With engine off, push hydrostatic transmission engagement lever in to engage.

Technical Data Table

Blade Diameter	61.6 cm		
Blade screw tightening torque	60-70 Nm		
Cutting height (on 4 levels)	32-89mm (1.25"-3.5")		
Front wheels	11 X 4.00-5		
Rear Wheels	13 X 5.00-6		
Wheel inflation pressure	140kPa/20psi or as indicated on tyre.		
Fuel tank capacity	1L		
Power sound level (LwA)	100dB(A)		
Vibrations at handlebar (max)	4.01m/s ² , k = 1.5m/s ²		
Forward movement speed (theoretical with engine revs 3000 / min)			
Gear Models:			
- In first gear	1,5 km/h	- In second gear	2,5km/h
- In third gear	3,3 km/h	- In fourth gear	4,5km/h
- In reverse	1,5 km/h		
Hydrostatic drive models:			
- Forward	6km/h	- Reverse	3.5km/h
Grass catcher capacity	130L		
Weight (side discharge models)	117kg		
Weight (catcher models)	125kg		

Machine Dimensions

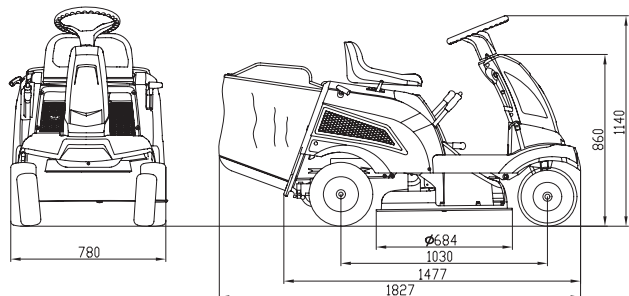

Not for
Reproduction

©2022 Briggs & Stratton

Victa is a trademarks of Briggs & Stratton Australia Pty. Ltd.

ABN 13 006 576 856

All rights reserved. No part of this booklet may be reproduced by any means without prior written permission. All information herein is subject to change without notice.