



OPERATION MANUAL

**GFORCE**

**GARDEN  
PRODUCTS  
22 INCH  
WHEEL  
TRIMMERMOWER**

GH201-22W





**WARNING!**

Read this manual carefully before using your lawn mower and keep it in a safe place for future reference.

DESCRIPTION OF PRODUCT PARTS	4
TECHNICAL SPECIFICATIONS	6
INTENDED USE	6
SAFETY INFORMATION	7
ASSEMBLY	10
PREPARING THE ENGINE	11
ADJUSTMENT	12
OPERATION	13
MAINTENANCE AND STORAGE	14
TROUBLESHOOTING	18
WARRANTY	19

## DESCRIPTION OF PRODUCT PARTS

As shown below

1. Control level
2. Engine
3. Trimmer line
4. Spindle
5. Trimmer shield
6. Recoil starter

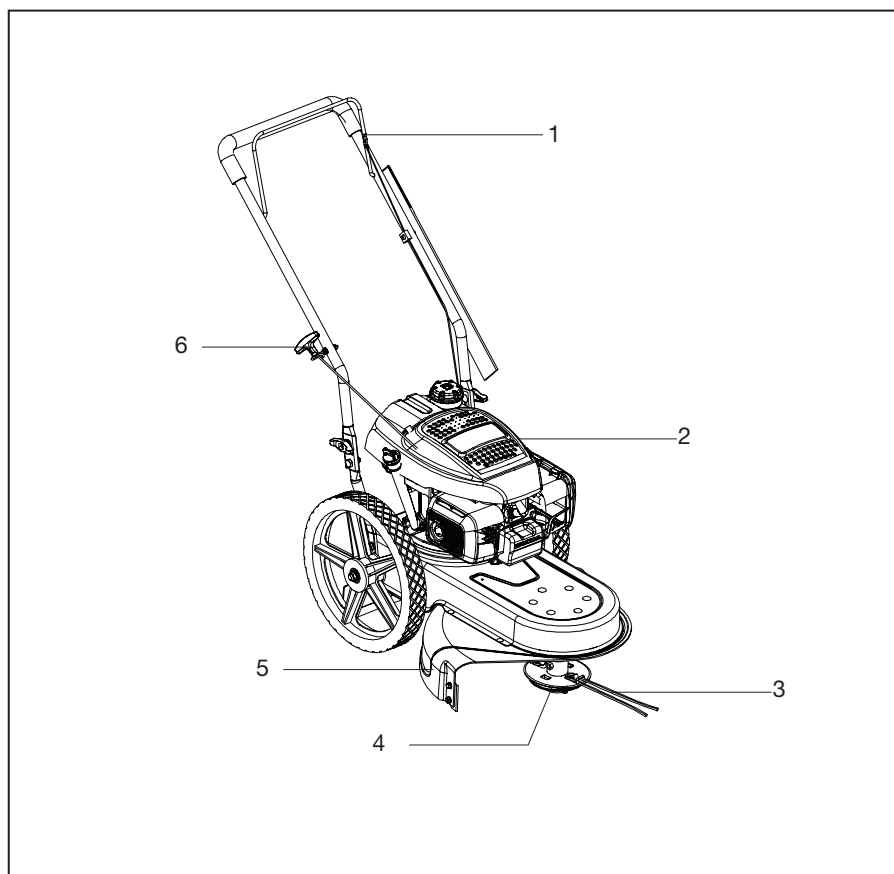

## Check the delivery parts

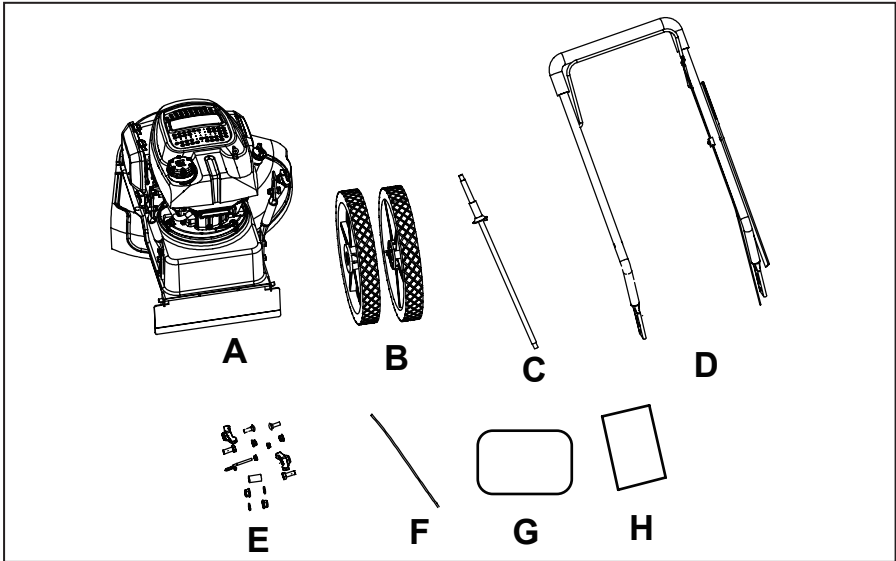

- A. 1 x Wheel trimmer
- B. 2 x Wheels
- C. 1 x Axle
- D. 1 x Handle
- E. 1 x Pack of bolts and nuts
- F. 1 x Pack of trimmer line
- G. 1 x Pack of tools
- H. 1 x Instruction manual

- **Remove all packing materials**
- **Ensure all parts on the content list are present**
- **Check the product and all accessories for transportation damages**



**WARNING!** Packaging material are not toys! Children must not play with plastic bags! Danger of suffocation!

**If any parts are missing or damaged, please contact your dealer.**

















## **TECHNICAL SPECIFICATIONS**

<b>Wheel trimmer</b>	
Model	GH201-22W
Trimmer line diameter	4.0 mm
Trimmer line length	0.47 m
Cutting Width	560 mm
Cutting Height	50 mm- 105 mm
<b>Engine</b>	
Model	Honda GCV200H-S4BB
Engine type	OHV, 4-stroke
Engine displacement	201 cc
Engine oil capacity	0.4 L
Fuel tank capacity	0.91 L
Spark plug model	NGK/BPR5ES

## **INTENDED USE**

This wheel trimmer is used for clearing weeds and vegetation, especially for thick brush and long grass in a large area. It is designed for domestic use and is not designed for commercial, trade, or industrial use.

**SAFETY INFORMATION**

 	<p>WARNING!</p> <p>To reduce the risk of injury, user must read and understand the instruction manual before using the mower</p>
 	<p>WARNING! Beware of thrown objects</p> <p>Keep bystanders away</p>
 	<p>WARNING! Keep hands and feet away from the blades</p> <p>Unplug the spark plug before maintenance</p>
 	<p>Risk of fire</p> <p>Never refuel while the engine is running</p>
 	<p>WARNING! Hot surface</p> <p>Do not open or remove the safety shields while the engine is running</p>
 	<p>Check the engine oil level and fuel before operation</p> <p>Wear eye and ear protection when using the mower</p>
 	<p>WARNING! The mower's exhaust gas contains toxic substances</p> <p>Do not run the engine indoor.</p>
	<p>Sound power level noise label</p>
	<p>Australian Regulatory Compliance Mark</p>

# GENERAL SAFETY WARNINGS

### Training

1. Read the instructions carefully. Be familiar with the controls and the proper use of the mower;
2. Never allow children or people unfamiliar with these instructions to use the mower. Local regulations can restrict the age of the operator;
3. Never mow while people, especially children or pets are nearby;
4. Keep in mind that the operator or user is responsible for accidents or hazards occurring to other people or their property.

### Preparation

1. While mowing, always wear safety footwear and long trousers. Do not operate the mower when barefoot or wearing open sandals; The use of safety glasses and hearing protection is also recommended.
2. Thoroughly inspect the area where the mower is to be used and remove all objects which can be thrown by the mower;
3. Warning - petrol is highly flammable.
  - Store fuel in containers specifically designed for this purpose;
  - Refuel outdoors only and do not smoke while refueling;
  - Add fuel before starting the engine. Never remove the cap of the fuel tank or add petrol while the engine is running or when the engine is hot;
  - If petrol is spilled, do not attempt to start the engine but move the mower away from the area of spillage and avoid creating any source of ignition until petrol vapors have dissipated;
  - Replace the fuel tank cap and fuel container cap securely;
4. Before using, always visually inspect to see that the blades, blade bolts and cutter assembly are not worn or damaged. Replace worn or damaged blades and bolts in sets to preserve balance;

### Operation

1. Do not operate the engine in a confined space where dangerous carbon monoxide fumes can collect;
2. Trim only in daylight or in good artificial light;
3. Avoid operating the wheel trimmer in wet grass, where possible;
4. Always be sure of your footing on slopes;
5. Walk, never run;
6. Trim across the face of slopes, never up and down;
7. Exercise extreme caution when changing direction on slopes;
8. Do not trim excessively steep slopes;
9. Use extreme caution when reversing or pulling the wheel trimmer towards you;
10. Stop the trimming lines if the wheel trimmer has to be tilted for transportation when crossing surfaces other than grass, and when transporting the wheel trimmer to and from the area to be trimmed;
11. Never operate the wheel trimmer with defective guards, or without safety devices.



12. Do not change the engine governor settings or over speed the engine;
13. Disengage all trimming lines before starting the engine;
14. Start the engine carefully according to instructions and with feet well away from the cutting line;
15. Do not tilt the wheel trimmer when starting the engine, except if the wheel trimmer has to be tilted for starting. In this case, do not tilt it more than necessary and lift only the part which is away from the operator;
16. Do not put hands or feet near or under rotating parts;
17. Never pick up or carry a wheel trimmer while the engine is running;
18. Stop the engine and disconnect the spark plug lead, make sure that all moving parts have come to a complete stop:
  - Whenever you leave the wheel trimmer;
  - Before refueling;
  - Before clearing blockages;
  - Before checking, cleaning, or working on the wheel trimmer;
  - After striking a foreign object, inspect the wheel trimmer for damage and make repairs before restarting and operating the wheel trimmer;
  - If wheel trimmer starts to vibrate abnormally (check immediately);

### **Maintenance and storage**

1. Keep all nuts, bolts, and screws tight to be sure the wheel trimmer is in safe working condition;
2. Never store the wheel trimmer with petrol in the tank inside a building where fumes can reach an open flame or spark;
3. Allow the engine to cool before storing it in any enclosure;
4. To reduce the fire hazard, keep the engine and petrol storage area free of grass, leaves, or excessive grease;
5. Replace worn or damaged parts for safety;
6. If the fuel tank has to be drained, this should be done outdoors.

# ASSEMBLY

## Assembling the wheels

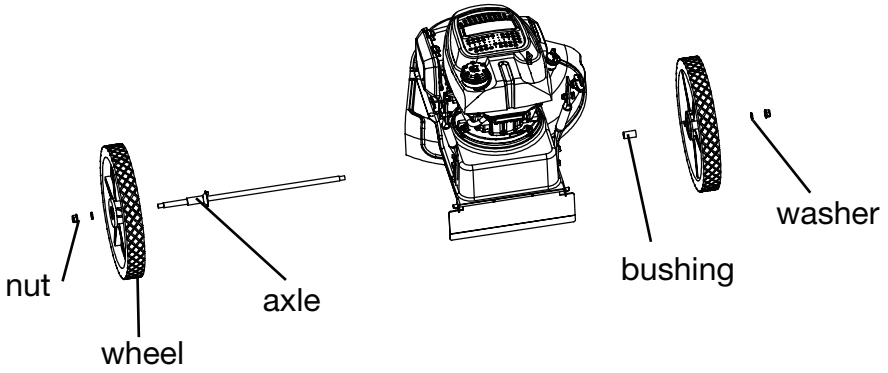

## Assembling the handle

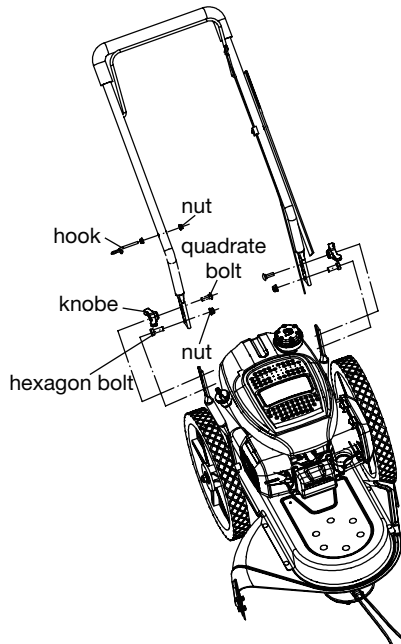

### Starter rope

1. Disconnect the spark plug lead from the spark plug.
2. Pull the starter rope out from the engine.
3. Put the start rope into the hook

## PREPARING THE ENGINE

### Checking engine oil level and filling the engine oil



**WARNING!** Fill up the wheel trimmer's engine with 0.4 Litre 4-Stroke engine oil before starting the engine for the first time.



**WARNING!** Check engine oil level before starting the engine.

1. Remove the oil filler cap/dipstick and wipe it clean.
2. Insert the dipstick into the oil filler neck, but do not screw it in.
3. If the level is low, add the engine oil to the upper limit on the dipstick.
4. Install the oil filler cap/dipstick.

### Attaching the grass catcher onto the mower

1. Lift the rear flap
2. Put the grass catcher to the mower, hold the grass catcher and put down the rear flap on the grass catcher.

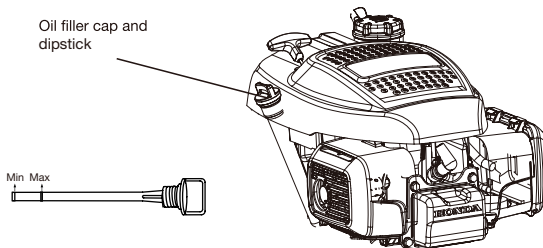

### Filling engine fuel (petrol)



**WARNING!** Use fresh unleaded fuel (petrol), 90 Octane or better. Do not use E10 or Ethanol blends.

## ADJUSTMENT



**WARNING!** Do not mix fuel (petrol) with engine oil.



**WARNING!** Do not overfill the fuel tank.



**WARNING!** Fuel (petrol) is highly inflammable. Handle the fuel (petrol) with extreme precaution. Keep the fuel (petrol) out of reach of children.



**WARNING!** Do not smoke when handling the fuel (petrol).



**WARNING!** Do not smoke or allow flame/sparks in the area where the engine is refueled or where the fuel (petrol) is stored.



**WARNING!** Refuel the engine in a well-ventilated area. If the engine has been running, allow it to cool down before refuelling.

Avoid prolonged contact with skin or inhalation of the fuel (petrol) vapour.

1. Clean the area around the fuel tank and check the fuel level.
2. Refill the fuel tank if the fuel level is low.
3. Refuel carefully to avoid overfill or spill of fuel (petrol).
4. Clean up any overflow or splashes of fuel (petrol) before starting the engine.
5. Replace the fuel tank cap and wait for 5 minutes for excess fuel (petrol) to evaporate, before starting the engine.

## ADJUSTMENT

### Adjusting cutting height



**WARNING!** Stop and turn off the engine before adjusting the cutting height.

1. Loosen the bolt found on each side of the spindle shaft.  
Note: The bolts are designed so that they cannot be removed from the spindle shaft.
2. Slide the spindle shaft upward or downward to the desired position before retightening the bolts.

## OPERATION

### Starting and stopping the engine



**WARNING!** The trimming line will rotate as soon as the engine is started.



**WARNING!** The wheel trimmer is for outdoor use only. Do not start the engine in an enclosed or poorly ventilated area. Exhaust gas contains toxic gases.



**WARNING!** Keep hands, feet, hair, and clothes away from the moving parts of the wheel trimmer.



**WARNING!** The engine will be hot during and after the operation.



**WARNING!** Make sure the trimming lines are securely fastened before starting the engine.



**CAUTION!** Be sure the trimming area is clear of stones, sticks, wire, or other objects which could damage the wheel trimmer or engine. Such objects could be accidentally thrown by the wheel trimmer in any direction and cause serious personal injury to the operator and others.

1. Press the primer bulb 1 or 2 times.
2. Turn the fuel valve lever to the ON position.

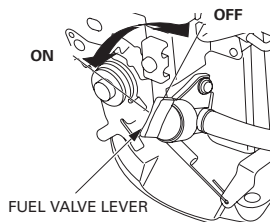

3. Depress the control lever.
4. Pull the starter grip lightly until you feel resistance, then pull the starter rope to start the engine.
5. Release the control lever to stop the engine. Turn the fuel valve lever to OFF position after the engine stops.

### Using your wheel trimmer

1. This wheel trimmer is designed with the spindle offset to the left side, allowing the operator to trim along a fence, landscaping, or a house to his or her right side without having to make any adjustments to the wheel trimmer.
2. Operate the wheel trimmer at a slower walking speed when trimming tall, thick weeds or grass.
3. Do not trim on excessively steep slopes. If a slope is difficult to stand on, do not trim.
4. Do not trim on slopes when the ground is slippery or wet.
5. Trim across the face of a slope, not up and down.
6. While trimming, do not allow the spindle to contact a concrete, asphalt, or gravel surface.

## CLEANING, MAINTENANCE AND STORAGE



**WARNING!** Disconnect the spark plug lead from the spark plug before cleaning, maintaining, and storing.



**WARNING!** Read the engine's manual carefully. Cleaning, maintaining, and storing your engine as recommended in the engine's manual.

### Cleaning

1. Clean the underside of the wheel trimmer after each use to remove any debris build up.
2. Tip the wheel trimmer so that it rests on its side. Keep the side with the air cleaner facing up. Hold the wheel trimmer firmly.  
Note: Never tip the wheel trimmer more than 90° in any direction and do not leave your wheel trimmer tipped for a long time. Oil can drain into the upper part of the engine causing a starting problem.
3. Scrape and clean the underside of the wheel trimmer with a soft brush or a suitable tool. Do not spray with water.  
Important: Do not use a pressure washer or garden hose to clean the wheel trimmer. These may cause damage to the engine.

### Cleaning a flooded engine

1. If the engine cannot start after several trials, the engine may be flooded with excess fuel.
2. To clear a flooded engine, move the throttle lever to the STOP position.

3. Remove the spark plug and wipe it dry with a cloth.
4. Wait for 5 minutes and then reinstall the spark plug.  
Note: install the spark plug carefully by hand to avoid cross threading. After the spark plug is seated, tighten the spark plug with a 1/8 or 1/4 turn.

## Maintenance

### Changing engine oil

1. Turn the fuel valve lever to the OFF position.
2. Remove the oil filler cap and drain the oil into the oil container.
3. Refill with engine oil and check the oil level.

### Cleaning air cleaner

1. Remove the air cleaner cover by unhooking the two upper tabs on the top of the air cleaner cover and the two lower tabs.
2. Remove the element. Carefully check the element for holes or tears and replace if damaged.
3. Tap the element lightly several times on a hard surface to remove excess dirt, or blow compressed air 29 psi (200 kPa) through the cleaner from inside out. Never try to brush the dirt off, brushing will force dirt into the fibres. Replace the element if it is excessively dirty.
4. Wipe dirt from the inside of the air cleaner case and cover using a moist rag. Be careful to prevent dirt from entering the air duct that leads to the carburettor.
5. Install the element and the air cleaner cover.

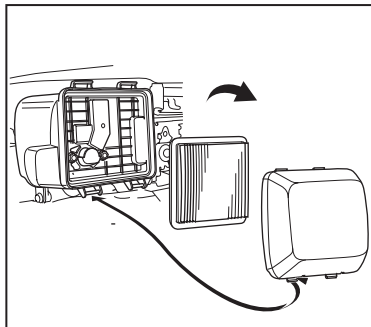
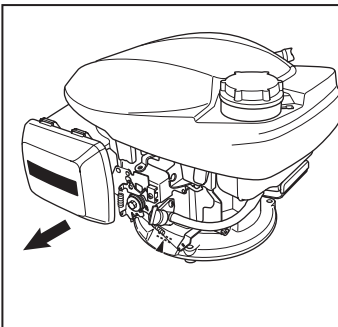

**Adjusting the spark plug gap**

1. Remove the spark plug from the wheel trimmer.
2. Clean the spark plug with a wire brush.
3. Use a feeler gauge and set the gap of the spark plug to 0.7-0.8 mm.
4. Reinstall the spark plug.

0.7-0.8 mm



**Changing the trimming line**

1. Change the trimming line before it becomes too short (i.e. approximately half its original length).
2. Remove the worn trimming line from the spindle.
3. Fold the new trimming line in half and insert both ends through the loop near the edge of the spindle.
4. Pull the end of the trimming line through the loop until the trimming line is securely beneath the metal tab.
5. Cross the ends of the trimming line and pull each end tightly to secure the trimming line in place.

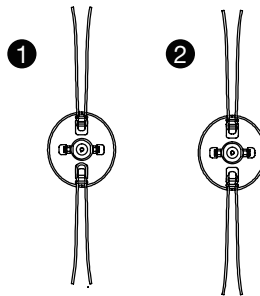
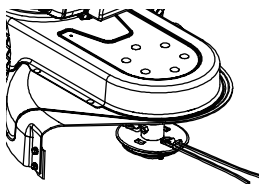

**Storage**

1. Fuel can become stale when stored over 30 days, stale fuel causes acid and gum deposits to form in the fuel system. Drain the fuel for long term storage.



2. Clean the wheel trimmer before storage.
3. Use a light oil or silicone to coat the wheel trimmer, especially cables and all moving parts.
4. Store the wheel trimmer in a dry and clean area, out of reach of children. Do not store next to corrosive materials, such as fertilizer.

## TROUBLESHOOTING

<b>Problem</b>	<b>Possible cause</b>	<b>Possible solution</b>
Engine cannot start	Fuel valve lever is in OFF position	Turn the fuel valve lever to ON position
	Fuel tank is empty	Refill the fuel
	Spark plug is flooded	Clean and dry the spark plug
Engine runs rough	Air filter is dirty	Clean the air filter
	Spark plug is dirty	Clean the spark plug
Uneven mowing results	Possible clogging	Clean the spindle of any grass
	Cutting tall grass at ground level	Set the correct cutting height

# WARRANTY

This product is covered by a 3 year parts and labour warranty for engine (2 years for chassis) against manufacturing defects. Our goods come with guarantees that cannot be excluded under the Australian Consumer Law.

You are entitled to a replacement or refund for a major failure and for compensation for any other reasonably foreseeable loss or damage. You are also entitled to have the goods repaired or replaced if the goods fail to be of acceptable quality and the failure does not amount to a major failure.

This warranty will not apply:

- (i) where this product has been subjected to misuse, abuse, accident or want of care;
- (ii) where this product has been used for a purpose for which it was not designed or is not suited;
- (iii) where the service of this product has been undertaken by a non-authorized person or company or if non-approved parts have been used;
- (iv) where this product has been used for industrial or commercial purposes . Should service become necessary during the warranty period, the purchaser should contact your dealer.

In order to obtain warranty service, the purchaser must present the store receipt showing the name of the retailer and the date of purchase.

The period of the warranty begins from the original date of purchase, notwithstanding any subsequent repair or parts replacement.

Purchaser shall be responsible for all transport charges to and from the Authorised Service Centre.

Damage in transit is not covered by this warranty. The purchaser should remove from the product any liquids (if applicable) before sending the product for service or repair.

The product should be packed securely to prevent damage.

### WARRANTY EXCLUSIONS

Wear parts or service related parts required when performing normal and regular maintenance of this product are not covered by warranty unless it is found to be defective by an Authorised Service Centre.

These include, but are not limited to: Spark Plugs, Carburettor Adjustments, Lubricants, Engine Tune-ups, Filters.